

TOWN OF DEDHAM, MASSACHUSETTS

CONTRACT DOCUMENTS
FOR

Howe Lot Fence Restoration



March 2, 2021

Town of Dedham
Department of Public Works

Leon Goodwin, Town Manager
Joseph Flanagan, Director of Public Works

TABLE OF CONTENTS

Section Number

Bidding and Contract Requirements

Invitation to Bid	00020
Instructions to Bidders	00100
Form of General Bid	00300
Agreement	00500
Construction Performance Bond	00610
Construction Payment Bond	00620
Supplemental Conditions	00800
Excerpts from Applicable State Law	00850

Specifications

Site Preparation & Dismantling	01000
Miscellaneous Metals	01100
Painting	01200
Fence Restoration	01300

Attachment A – Wage Rates

Attachment B – Howe Lot Fence Restoration Plan

SECTION 00020

INVITATION FOR BIDS

Sealed bids for furnishing the following item(s) will be received at the Department of Public Works at 55 River Street, Dedham, MA 02026 until the time specified below at which time the proposals will be publicly opened and read:

<u>ITEM</u>	<u>BID OPENING</u>
Bid: Howe Lot Fence Restoration	March 31, 2021

The scope of work under this contract includes, but is not limited to, the dismantling, cleaning, repairing, painting and reassembling the existing cast iron fencing and posts associated with the Howe Lot located at the Old Village Cemetery, 30 Village Avenue, Dedham, MA 02026.

The term of this contract shall extend from May 1, 2021 through November 30, 2021.

Specifications, bid forms and plans may be obtained at the Department of Public Works Office located at 55 River Street, Dedham, MA, after March 10, 2021 between 9:00 A.M. and 2:00 P.M, upon a nonrefundable payment of \$50.00. This amount is not refundable. Cash in not acceptable. Checks shall be made payable to the Town of Dedham.

Bidders may also obtain a PDF version of the specifications (including all Attachments) from the Town of Dedham's website <https://www.dedham-ma.gov/departments/engineering/invitation-for-bids-proposals> at no charge.

Bids will be opened in the Department of Public Works facility, 55 River Street, Dedham, MA 02026, at 10:00 AM. Bid openings will not be open to the public, however the bid opening will be available through video conference using Zoom. Zoom can be downloaded for free at www.zoom.us to access video conferencing, or the conference can be joined by audio only without the use or need of the Zoom application at all. All pertinent information for the Zoom video conference is shown below:

Topic: Howe Lot Fence Restoration – Bid Opening
Time: March 31, 2021 10:00 AM Eastern Time

Join Zoom Meeting: <https://zoom.us/j/5274574085>

Meeting ID: 527 457 4085

One tap mobile

+13126266799,,5274574085# US (Chicago)

+16465588656,,5274574085# US (New York)

Dial by your location

+1 312 626 6799 US (Chicago)

+1 646 558 8656 US (New York)

+1 301 715 8592 US (Washington DC)

+1 346 248 7799 US (Houston)

+1 669 900 9128 US (San Jose)

+1 253 215 8782 US (Tacoma)
Meeting ID: 527 457 4085
Find your local number: <https://zoom.us/j/aeme38RKA>

Bid opening will be recorded and available on the Town of Dedham website following the bid opening. Each Bid must be accompanied by a bid security consisting of a BID BOND, CASH, or, CERTIFIED CHECK issued by a responsible bank or trust company in the amount of 5% of the bid price.

A performance bond in an amount equal to 100 percent of the total amount of the contract price with a surety company qualified to do business in the Commonwealth of Massachusetts will be required for the faithful performance of the contract, as well as a labor and materials bond in an amount equal to 100 percent of the total contract price.

All bids for this project are subject to applicable public bidding laws of Massachusetts, including, but not limited to G.L. c.30, §39M.

Attention is directed to the minimum wage rates to be paid as determined by the Commissioner of Labor and Workforce Development and the weekly payroll record submittal requirements under the provisions of Massachusetts General Laws, Chapter 149, Section 26 through 27D inclusive.

Selection of the contractor will be based upon bidder qualifications, including evidence of past performance in similar projects, and bid price. The contract will be awarded to the bidder deemed by the awarding authority to be the lowest responsible and eligible bidder.

The bidder agrees that its bid shall be good and may not be withdrawn for a period of 30 days, Saturdays, Sundays and legal holidays excluded, after the opening of the bids.

The Town reserves the right to waive any informalities, to accept or reject, in whole or in part any or all bids, or take whatever other action may be deemed to be in the best interest of the Town.

The Town of Dedham, Massachusetts

By Leon Goodwin

Its Town Manager

SECTION 00100

INSTRUCTIONS TO BIDDERS

1. The Town of Dedham, Massachusetts, herein called the Owner, acting by and through its Town Manager, will receive sealed Bids for the Howe Lot Fence Restoration.

Such bids addressed to the Department of Public Works, 55 River Street, Dedham, MA 02026, and endorsed BID for the Howe Lot Fence Restoration will be received at the Department of Public Works, located at the Department of Public Works facility, 55 River Street, Dedham, MA, 02026 until 10:00 AM prevailing time, on Thursday, March 31, 2021 at which time and place said bids will be opened and read aloud. The DPW facility is currently closed to the public, sealed bids that are sent via an independent courier (i.e. FedEx, UPS, etc.) should not require a signature, bids shall be placed in the mailbox located at the front door of the DPW facility. Bid opening will not be open to the public, however the bid opening will be available on the Town of Dedham website following the bid opening.

Any bid may be withdrawn prior to the above scheduled time for the opening of bids or authorized postponement thereof. Any bid received after the time and date specified will not be considered. The bidder agrees that this bid shall be good and may not be withdrawn for a period of 30 days, Saturdays, Sundays, and legal holidays excluded, after the opening of bids.

2. Location and Work to be Done

The scope of work under this contract includes, but is not limited to, the dismantling, cleaning, repairing, painting and reassembling the existing cast iron fencing and posts associated with the Howe Lot located at the Old Village Cemetery, 30 Village Avenue, Dedham, MA 02026.

Additional drawings showing details in accordance with which the Work is to be done may be furnished by addendum from time to time during the bidding period by the Owner or its Architect/Engineer, and shall then become a part of the Contract Documents.

The Contractor shall furnish all labor, services, materials, equipment, plant, machinery, apparatus, appliances, tools, supplies, and all other things necessary to do all work required for the completion of each item of the Work and as herein specified.

The Work to be done and paid for under any item shall not be limited to the exact extent mentioned or described but shall include all incidental work necessary or customarily done for the completion of that item.

3. Preparation of Bid

Each bid must be submitted on the prescribed form. All blank spaces for bid prices must be filled in, in ink or typewritten, in both words and figures.

Each bid must be submitted in a sealed envelope bearing on the outside the name of the bidder, his address, and endorsed with the name of the project as specified in Receipt and Opening of Bids, above.

If forwarded by mail, the sealed envelope containing the bid must be enclosed in another envelope addressed as specified in Receipt and Opening of Bids, above.

4. Bid Opening Procedure

The following list of requirements shall apply to each filed bid. Bids not meeting all the requirements for timeliness and security will be rejected; bids not meeting signature and addenda requirements will be rejected prior to checking of bid amounts.

Bids shall be filed at the place and before the time specified in Receipt and Opening of Bids, above.

Properly executed bid security shall be placed in a sealed envelope and shall be attached to the outside of the envelope containing the bid.

Bid signatures will be checked.

All addenda will be sent certified mail, with return receipt requested, and/or facsimile or e-mail to all prospective bidders. All bidders shall include with their bids the written acknowledgment form provided in Section 00300, FORM OF GENERAL BID.

The total dollar amount of each bid will be read, and the three apparent lowest bids will be selected for further consideration. These three apparent low bids will be read aloud for the benefit of the other bidders and the bid opening procedure will be closed. All those present at the bid opening may examine all bids after the bid opening and after the reading of the three apparent low bids.

5. Modification

Any bidder may modify his bid by written communication at any time prior to the scheduled closing time for receipt of bids. Any telegraphic communication must be received by the Owner prior to the closing time, and, provided further, the Owner must be satisfied that a written confirmation of the telegraphic modification over the signature of the bidder was mailed prior to the closing time. If written confirmation is not received within two days from the closing time, no consideration will be given to a telegraphic communication.

The communication shall not reveal the bid price but shall provide the addition or subtraction or other modification so that the final prices or terms will not be known by the Owner until the sealed bid is opened.

6. Ability and Experience of Bidder

No award will be made to any bidder who cannot satisfy the Owner that he has sufficient ability and experience in this class of work and sufficient capital and plant to enable him to prosecute and complete the work successfully within the time named. The Owner's decision or judgment on these matters will be final, conclusive, and binding.

The Owner may make such investigations as it deems necessary, and the bidder shall furnish to the Owner, under oath if so required, all such information and data for this purpose as the Owner may request.

7. Conditions of Work

Each bidder must familiarize himself fully with the conditions relating to the construction of the project and the employment of labor thereon. Failure to do so will not relieve a successful bidder of his obligation to furnish all material and labor necessary to carry out the provisions of his contract. Insofar as possible the Contractor, in carrying out his work, must employ such methods or means as will not cause any interruption of or interference with the work of any other Contractor.

8. Addenda and Interpretations

No interpretation of the meaning of the plans, specifications or other prebid documents will be made to any bidder orally. All information given to bidders other than by means of the plans, specifications, or by addenda, as described below, is given informally and shall not be used as the basis of a claim against the Owner.

Every request for such interpretation should be in writing addressed to the Director of Public Works, 55 River Street, Dedham, MA 02026, and to be given consideration must be received at least seven (7) days prior to the date fixed for the opening of bids. Any and all such interpretations and any supplemental instructions will be in the form of a written addenda to the specifications and issued as described above in Part 5, "Bid Opening Procedure". Failure of any bidder to receive any such addendum or interpretation shall not relieve such bidder from any obligation under his bid as submitted. All addenda so issued shall become part of the Contract Documents.

9. Security for Faithful Performance

Simultaneously with his delivery of the executed Contract, the Contractor shall furnish a surety bond or bonds as security for faithful performance of this contract and for the payment of all persons performing labor and materials under this contract. The surety on such bond or bonds shall be a surety company qualified to do business under the laws of the Commonwealth and satisfactory to the Owner. The bonds shall remain in force for one year after final acceptance of the work by the Owner, unless the Owner, in writing, releases the Contractor from the obligation sooner.

10. Power of Attorney

Attorneys-in-fact who sign Contract bonds must file with each bond a certified and effectively dated copy of their power of attorney.

11. Laws and Regulations

The bidder's attention is directed to the fact that all applicable State laws, municipal ordinances or bylaws, and the rules and regulations of all authorities having jurisdiction over construction of the project shall apply to the contract throughout, and they will be deemed to be included in the Contract the same as though written out in full.

12. Liquidated Damages for Failure to Enter into Contract

The successful bidder, upon his failure or refusal to execute and deliver the Contract and bonds required within 10 days after presentation thereof by the Owner, shall forfeit to the Owner, as liquidated damages for such failure or refusal, the security deposited with his/her bid, but the amount forfeited shall not exceed the difference between his/her bid price and the bid price of the next lowest responsible and eligible bidder. In case of death, disability, bona fide clerical or mechanical error of a substantial nature, or other similar unforeseen circumstances affecting the bidder, his/her bid deposit will be returned.

13. Obligation of Bidder

At the time of the opening of bids, each bidder will be presumed to have inspected the site and to have read and to be thoroughly familiar with the Contract Documents (including all addenda). The failure or omission of any bidder to examine any form, instrument, or document shall in no way relieve any bidder from any obligation in respect of his bid.

14. Information Not Guaranteed

All information given in the Contract Documents relating to subsurface and other conditions, natural phenomena, existing pipes, and other structures is from the best sources at present available to the Owner. All such information is furnished only for the information and convenience of bidders and is not guaranteed.

It is agreed and understood that the Owner does not warrant or guarantee that the subsurface or other conditions, natural phenomena, existing pipes, or other structures encountered during construction will be the same as those indicated in the Contract Documents. It is further agreed and understood that no bidder or Contractor shall use or be entitled to use any of the information made available to him or obtained in any examination made by him in any manner as a basis of or ground for any claim or demand against the Owner or the Architect/Engineer, arising from or by reason of any variance which may exist between the information made available and the actual subsurface or other structures actually encountered during the construction work, except as may otherwise be expressly provided for in the Contract Documents.

15. Bid Security

Each bid and sub-bid must be accompanied by bid security in the form of a certified check, a bid bond, cash, or a treasurer's or cashier's check, payable to the Owner, in the amount of five (5) percent of the value of the bid. Such security of general bidders will be returned to all except the three lowest responsible and eligible bidders within five days, Saturdays, Sundays, and legal holidays excluded, after the opening of bids, and the remaining securities will be returned promptly after the Owner and the accepted bidder have executed the Contract, or if no notice of intent to award has been presented to the selected contractor within 30 days, Saturdays, Sundays and holidays excluded, after the date of the opening of bids, upon demand of the bidder at any time thereafter.

16. Right to Reject Bid

The Owner reserves the right to waive any informalities in bids and to reject any and all bids, should the Owner deem it to be in the public interest to do so.

The Owner may also reject bids which in its sole judgment are either incomplete, conditional, obscure or not responsive or which contain additions not called for, erasures not properly initialed, alterations, or similar irregularities.

17. Time for Completion

The successful general bidder must agree to commence work within ten (10) days of the date of the Notice to Proceed and to fully complete the project within the time limit stated in Section 00300, FORM OF GENERAL BID.

18. Comparison of Bids

Bids will be compared on the basis of prices set forth in the bid forms.

In the event that there is a discrepancy between the lump sum or unit prices written in words and figures, the prices written in words will govern.

19. Award of Contract

The Contract will be awarded to "the lowest responsible and eligible bidder" pursuant to General Laws Chapter 30, Section 39M, as amended. Such a bidder shall possess the skill, ability and integrity necessary for the faithful performance of the work, shall be able to furnish labor that can work in harmony with all other elements of labor employed, or to be employed, in the work, and shall otherwise comply with all applicable provisions of law. Contract award shall be subject to availability of an appropriation for funding.

20. Statutes Regulating Competitive Bidding

Any bid which does not comply with the provisions of Massachusetts General Laws Chapter 30, Section 39M, as amended, need not be accepted and the Owner may reject every such bid.

21. Wage Rates

Prevailing Wage Rates as determined by the Commissioner of Department of Labor and Workforce Development under the provision of the Massachusetts General Laws, Chapter 149, Section 26 to 27G, as amended, apply to this project. It is the responsibility of the bidder, before bid opening, to request any additional information on Prevailing Wage Rates for those tradespeople who may be employed for the proposed work under this contract.

22. Contractor Records

The Contractor shall comply with the provisions of Massachusetts General Laws, Chapter 30, Section 39R concerning Contractor records.

23. Insurance

The Contractor shall carry and continuously maintain until completion of the Contract, insurance as specified in Agreement and in such form as shall protect him performing work covered by this Contract, and the Town of Dedham and its employees, agents and officials, from all claims an liability for damages for bodily injury, including accidental death, and for property damage, which may arise from operations under this Contract. The Town shall be named as an additional insured. The Contractor covenants and agrees to hold the Town and its employees, agents and officials harmless from loss or damage due to claims for bodily injury or death and/or property damage arising from, or in connection with, operations under this Contract.

25. Affirmative Action/Equal Employment Opportunity Laws and Regulations

The Town of Dedham is an affirmative action/equal opportunity owner/purchaser. The bidder's attention is directed to all applicable State Laws, Town Bylaws, and rules and regulations regarding affirmative action/equal employment opportunity requirements. Failure of a bidder to comply with any such law, bylaw, rule or regulation shall constitute grounds for the Town to reject a bid or to otherwise reject or terminate the award of the contract pursuant to these contract documents.

SECTION 00300

FORM OF GENERAL BID

Bid of _____ (hereinafter called "Bidder")*

a corporation, organized and existing under the laws of the state of _____

a partnership

a joint venture

an individual
doing business as _____

To the City/Town of _____, Massachusetts (hereinafter called "Owner").

Gentlemen:

A) The undersigned Bidder, in compliance with your invitation for bids for the project known as Howe Lot Fence Restoration for the Town of Dedham, Massachusetts, having examined the plans and specifications and related documents and the site of the proposed work, and being familiar with all of the conditions surrounding the construction of the proposed project including the availability of materials and labor, hereby proposes to furnish all labor, materials, and supplies, and to construct the project in accordance with the contract documents and the plans and specifications within the time set forth below, and at the prices stated below. These prices are to cover all expenses incurred in performing the work required under the contract documents, of which this bid is a part.

The Bidder hereby agrees to commence work on or before the date to be specified in written "Notice to Proceed" of the Owner, and to fully complete the project by November 30, 2021. The Bidder further agrees to pay as liquidated damages the sum of One Thousand (\$1,000) Dollars for each consecutive calendar day thereafter that the work is not complete as provided in the contract.

*Specify corporation, partnership or individual as applicable.

B) Bidder acknowledges receipt of and this bid includes the following addenda:

No. _____ Dated: _____

No. _____ Dated: _____

No. _____ Dated: _____

No. _____ Dated: _____

C) The Bidder agrees to perform the bid work described in the specifications and shown on the plans for the following contract price:

_____ (dollars)
and _____ (cents)
(\$ _____)

The above unit prices shall include all labor, materials, bailing, shoring, removal, overhead, profit, insurance, etc., to cover the finished work of the several kinds called for.

The Bidder understands that all bids for this project are subject to the applicable bidding laws of the Commonwealth of Massachusetts, including General Laws Chapter 149 and Chapter 30, Section 39M, as amended.

The Bidder understands that the Owner reserves the right to reject any or all bids and to waive any informalities in the bidding.

The Bidder agrees that this bid shall be good and may not be withdrawn for a period of 30 days, Saturdays, Sundays and legal holidays excluded, after the opening of bids.

Within 10 days of receipt of the written notice of acceptance of this bid, the Bidder will execute the formal Agreement set forth in Section 00500 CONTRACT.

Bid security is attached in the sum of five percent (5%) of the total bid in accordance with the conditions of Section 00100 INSTRUCTIONS TO BIDDERS. The bid security may become the property of the Owner in the event the contract and bond are not executed within the time set forth above.

The selected Contractor shall furnish a performance bond and a payment bond in an amount at least equal to one hundred percent (100%) of the contract price in accordance with Section 00610 PERFORMANCE BOND, Section 00620 PAYMENT BOND, and as stipulated in the contract.

The undersigned offers the following information as evidence of his qualifications to perform the work as bid upon according to all the requirements of the plans and specifications.

1. Have been in business under present name for ____ years.
2. The names and addresses of all persons interested in the bid (if made by a partnership or corporation) as principals, are as follows:

(attach supplementary list if necessary)

3. The bidder is requested to state below what work of a similar character to that included in the proposed contract he has done, and give references that will enable the Owner to judge his experience, skill and business standing (add supplementary page if necessary).

<u>Completion</u> <u>Date</u>	<u>Project</u> <u>Name</u>	<u>Contract</u> <u>Amount</u>	<u>Design</u> <u>Engineer</u>	<u>Reference</u> <u>Name</u>	<u>Telephone</u> <u>No.</u>
----------------------------------	-------------------------------	----------------------------------	----------------------------------	---------------------------------	--------------------------------

a. _____

b. _____

c. _____

d. _____

e. _____

f. _____

4. Bank reference _____

(Name)

(Bank)

(Address)

(Telephone No.)

Pursuant to G.L. c.62C, §49A, I certify hereby in writing, under penalties of perjury, that the within named Bidder/Contractor has complied with all laws of the commonwealth relating to taxes, reporting of employees and contractors, and withholding and remitting of child support.

The undersigned Bidder hereby certifies under penalties of perjury, as follows: (1) that he/she is able to furnish labor that can work in harmony with all other elements of labor employed or to be employed in the work; (2) that all employees to be employed at the worksite will have successfully completed a course in construction safety and health approved by the United States Occupational Safety and Health Administration that is at least 10 hours in duration at the time the employee begins work and who shall furnish documentation of successful completion of said course with the first certified payroll report for each employee; and (3) that all employees to be employed in the work subject to this bid have successfully completed a course in construction safety and health approved by the United States Occupational Safety and Health Administration that is at least 10 hours in duration.

The undersigned certifies under penalties of perjury that this bid is in all respects bona fide, fair and made without collusion or fraud with any other person. As used in this paragraph the word "person" shall mean any natural person, joint venture, partnership, corporation or other business or legal entity.

The undersigned bidder hereby certifies, under pains and penalties of perjury, that the foregoing bid is based upon the payment to laborers to be employed on the project of wages in an amount no less than the applicable prevailing wage rates established for the project by the Massachusetts Department of Labor and Workforce Development. The undersigned bidder agrees to indemnify the awarding authority for, from and against any loss, expense, damages, actions or claims, including any expense incurred in connection with any delay or stoppage of the project work arising out of or as a result of (1) the failure of the said bid to be based upon the payment of the said applicable prevailing wage rates or (2) the failure of the bidder, if selected as the contractor, to pay laborers employed on the project the said applicable prevailing wage rates.

Respectfully submitted:

Date: _____

By: _____
(Signature)

(Type Name of Bidder)

(Title)

(Business Address)

(City and State)

(Telephone Number)

SECTION 00500

AGREEMENT

THIS AGREEMENT made this _____ day of _____ in the year Two Thousand and _____, between _____, with a usual place of business at _____, hereinafter called the CONTRACTOR, and the Town of Dedham, acting by its Town manager, with a usual place of business at 450 Washington Street, Dedham, MA 02026, hereinafter called the OWNER.

The CONTRACTOR and the OWNER, for the consideration hereinafter named, agree as follows:

1. Scope of Work

The Contractor shall furnish all labor, materials, equipment and insurance to perform all work required for the project known as the Howe Lot Fence Restoration Project, in strict accordance with the Contract Documents and all related Drawings and Specifications. The said Documents, Specifications, Drawings and any GENERAL SUPPLEMENTARY CONDITIONS are incorporated herein by reference and are made a part of this Agreement.

2. Contract Price

The Owner shall pay the Contractor for the performance of this Agreement, subject to additions and deductions provided herein, in current funds, the sum of _____.

3. Commencement and Completion of Work and Liquidated Damages

It is agreed that time is of the essence of this Agreement. The Contractor shall commence and prosecute the work under this Agreement upon execution hereof and shall complete the work on or before November 30, 2021.

- A. Definition of Term: The Term "Substantial completion" shall mean the date certified by the Owner when construction is sufficiently complete, in accordance with the Contract Documents, so the Owner may occupy the project, or designated portion(s) thereof, for the use for which it is intended.
- B. Time as Essential Condition: It is understood and agreed that the commencement of and substantial completion of the work are essential conditions of this Agreement. It is further agreed that time is of the essence for each and every portion of the Contract Documents wherein a definite and certain length of time is fixed for the performance of any act whatsoever; and where under the Contract Documents any additional time is allowed for the completion of any work, the new time fixed by such extension shall be of the essence of this Agreement. It is understood and agreed that the times for the

completion of the work are reasonable, taking into consideration the average climatic range and usual industrial conditions prevailing in this locality.

- C. Progress and Completion: Contractor shall commence work promptly upon execution of this Agreement and shall prosecute and complete the work regularly, diligently and uninterruptedly at such a rate of progress as will insure Substantial Completion within the stipulated number of calendar days.
- D. Liquidated Damages: It is expressly agreed between the Contractor and the Owner that the Contractor will be responsible for all damages which may arise due to the Contractor's failure to substantially complete the work within the above specified time. If the Contractor shall neglect, fail or refuse to complete the work within the specified number of days, or any extension thereof authorized by the Owner, Contractor agrees, as a part of the consideration for the execution of this Contract by the Owner, to pay the Owner the amount specified herein, not as a penalty, but as liquidated damages for such breach of contract as hereinafter set forth, for each and every calendar day, excluding Saturdays, Sundays and legal Holidays, that the Contractor shall be in default of Substantial completion after the date specified in the Agreement. Due to the impracticability and extreme difficulty of fixing and ascertaining the actual damages the Owner would in such event sustain, said amount is agreed to be the amount of damages which the Owner would sustain, and said amount shall be retained from time to time by the Owner from current periodic estimates. The amount of liquidated damages shall be One Thousand (\$1,000) Dollars per day.

4. Performance of the Work

- A. Direction of the Work: The Contractor shall supervise and direct the Work, using his best skills and attention which shall not be less than such state of skill and attention generally rendered by the contracting profession for projects similar to the Project in scope, difficulty and location. The Contractor shall maintain adequate supervisory personnel at the project site during the performance of the Work. He shall be solely responsible for all construction means, methods, techniques, sequences and procedures and for coordinating all portions of the Work under the Agreement.
- B. Responsibility for the Work:
 - (1) The Contractor shall be responsible to the Owner for the acts and omissions of his employees, Subcontractors and their agents and employees, and other persons performing any of the Work under a contract with the Contractor. This obligation shall also extend to the presence on the Site of suppliers of materials or equipment, their employees, contractors, and agents engaged in the work.
 - (2) The Contractor shall not be relieved from his obligations to perform the Work in accordance with the Contract Documents either by the activities or duties of the Owner in its administration of the Agreement, or by inspections, tests or approvals required or performed by persons other than the Contractor.

C. Permits and Fees: Unless otherwise expressly provided, the Contractor shall secure and pay for all permits and fees, licenses and inspections necessary for the proper execution and completion of the Work which are customarily secured after execution of the Agreement and which are legally required at the time the bids are received, and the same shall at all times be the property of the Owner and shall be delivered to the Owner upon completion of the Project.

D. Notices, Compliance With Laws:

(1) The Contractor shall give all notices and comply with all federal, state and local laws, ordinances, rules, regulations and lawful orders of any public authority bearing on the performance of the Work. The Contractor shall provide the Owner with reproductions of all permits, licenses and receipts for any fees paid. The Owner represents that it has disclosed to the Contractor all orders and requirements known to the Owner of any public authority particular to this Agreement.

(2) If the Contractor observes that any of the Contract Documents are at variance with applicable laws, statutes, codes and regulations in any respect, he shall promptly notify the Owner in writing, and any necessary changes shall be accomplished by appropriate modification.

(3) If the Contractor performs any Work which he knows or should know is contrary to such laws, ordinances, rules and regulations, and without such notice to the Owner, he shall assume full responsibility therefor and shall bear all costs attributable thereto.

(4) In the performance of the Work, the Contractor shall comply with all applicable federal, state and local laws and regulations including those relating to workplace and employee safety. The Contractor shall notify the Owner immediately of any conditions at the place of the work which violate said laws and regulations and shall take prompt action to correct and eliminate any such violations.

E. Project Superintendent: The Contractor shall employ a competent superintendent and necessary assistants who shall be in attendance at the Project site at all times during the progress of the Work. The superintendent shall represent the Contractor and all communications given to the superintendent shall be as binding as if given to the Contractor. Important communications shall be confirmed in writing. Other communications shall be so confirmed on written request in each case.

F. Progress Schedule: The Contractor, immediately after being awarded the Contract, shall prepare and submit for the Owner's information an estimated progress schedule for the Work. The progress schedule shall be related to the entire Project to the extent required by the Contract Documents, and shall provide for expeditious and practicable execution of the Work.

G. Drawings, Specifications and Submittals:

(1) The Contractor shall maintain at the site for the Owner one record copy of all Drawings, Specifications, Addenda, Change Orders and other Modifications,

and "As-Built" Drawings and Specifications in good order and marked currently to record all changes made during construction, and approved Shop Drawings, Product Data and Samples. These shall be delivered to the Owner upon completion of the Work.

(2) By approving and submitting Shop Drawings, Product Data and Samples, the Contractor represents that he has determined and verified all materials, field measurements, and field construction criteria related thereto, or will do so, and that he has checked and coordinated the information contained within such submittals with the requirements of the Work and of the Contract Documents.

(3) The Contractor shall not be relieved of responsibility for any deviation from the requirements of the Contract Documents by the Owner's approval of Shop Drawings, Product Data or Samples unless the Contractor has specifically informed the Owner in writing of such deviation at the time of submission and the Owner has given written approval to the specific deviation. The Contractor shall not be relieved from responsibility for errors or omissions in the Shop Drawings, Product Data or Samples by the Owner's approval thereof.

(4) The Contractor shall direct specific attention, in writing or on resubmitted Shop Drawings, Product Data or Samples, to revisions other than those requested by the Owner on previous submittals.

(5) No portion of the Work requiring submission of a Shop Drawing, Product Data or Sample shall be commenced until the submittal has been approved by the Owner. All such portions of the Work shall be in accordance with approved submittals.

- H. Protection of the Work and Owner's Property: The Contractor shall at all times safely guard the Owner's property from injury or loss in connection with this Agreement. He shall at all times safely guard and protect his own work, and that of adjacent property from damage. The Contractor shall replace or make good any such damage, loss or injury. The Contractor shall clean the work area and restore it to its original condition upon completion of the work.
- I. Quality of the Work: The Contractor shall perform the work in a good, workmanlike manner. The Contractor hereby guarantees that the entire work constructed by him under the Agreement will meet fully all requirements thereof as to quality of workmanship and materials. The Contractor hereby agrees to make at his own expense any repairs or replacements made necessary by defects in materials or workmanship supplied to him that become evident within one (1) year after the date of the final payment, and to restore to full compliance with the requirements set forth herein any part of the work constructed hereunder, which during said one (1) year period is found to be deficient with respect to any provisions of the Contract Documents. The Contractor also agrees to hold the Owner harmless from claims of any kind arising from damage due to said defects. The Contractor shall make all repairs and replacements promptly upon receipt of written orders for same from the Owner. If the Contractor fails to make the repairs and replacements promptly, the Owner may do the work and the Contractor shall be liable to the Owner for the cost thereof.

- J. Warranty: The Contractor guarantees to Owner that all materials incorporated into the work will be new unless otherwise specified or agreed. Prior to final payment, the Contractor shall deliver to the Owner all manufacturers' warranties, together with such endorsements or assignments as are necessary to ensure to the Owner the full rights and benefits of such warranties.

5. Affirmative Action/Equal Employment Opportunity

The Contractor is directed to comply with all applicable State Laws, Ordinances, Bylaws, and rules and regulations regarding affirmative action/equal employment opportunity requirements. Failure of the Contractor to comply with any such law, rule or regulation shall constitute grounds for the Owner to terminate the Agreement.

6. Site Information Not Guaranteed; Contractor's Investigation

All information given in the Contract Documents relating to subsurface and other conditions, natural phenomena, existing pipes, and other structures is from the best sources at present available to the Owner. All such information is furnished only for the information and convenience of the Contractor and is not guaranteed.

It is agreed and understood that the Owner does not warrant or guarantee that the subsurface or other conditions, natural phenomena, existing pipes, or other structures encountered during construction will be the same as those indicated in the Contract Documents.

Contractor has familiarized himself with the nature and extent of the Contract Documents, work, locality, and with all local conditions and federal, state, and local laws, rules, ordinances, and regulations that in any manner may affect costs, progress, or performance of the work. Contractor has made, or has caused to be made, examinations, investigations, and tests and studies of such reports and related data in addition to those referred to in the paragraph above as he deems necessary for the performance of the work at the Contract Price, within the Contract Time, and in accordance with the other Terms and Conditions of the Contract Documents; and no additional examinations, tests, investigations, reports, and similar data are or will be required by the Contractor for such purposes.

Contractor has correlated the results of all such observations, examinations, investigations, tests, reports, and data with the Contract Documents. Contractor has given the Owner written notice of all conflicts, errors, or discrepancies that he has discovered in the Contract Documents, and the resolution thereof by the Owner is acceptable to the Contractor.

It is further agreed and understood that the Contractor shall not use or be entitled to use any of the information made available to him or obtained in any examination made by him in any manner as a basis of or ground for any claim or demand against the Owner, arising from or by reason of any variance which may exist between the information made available and the actual subsurface conditions or other conditions or structures actually

encountered during the construction work, except as may otherwise be expressly provided for in the Contract Documents.

7. Project Architect or Engineer

There is a project architect-engineer for this project who is BSC Group. Except as otherwise indicated in the Contract Documents, the Architect/Engineer shall be a representative of the Owner and the Contractor shall direct all communications, questions and comments on the work and the performance thereof to the Architect/Engineer. Except as otherwise provided, the Architect/Engineer shall have all the authority of the Owner set forth in the Contract Documents. In general, the Architect/Engineer shall have the authority to review the performance of the work, reject work which is defective or otherwise does not comply with the Contract Documents and to order the Contractor to remedy defective work and take such actions which are necessary to make the work conform to the Contract Documents.

8. Wage Rates

Prevailing Wage Rates as determined by the Commissioner of the Department of Labor and Workforce Development under the provisions of Massachusetts General Laws, Chapter 149, Section 26 to 27G, as amended, apply to this project. It is the responsibility of the Contractor to provide the Town with certified payrolls and to comply with all requirements of the above-cited statutes.

The schedules of prevailing wage rates are included in the Contract Documents.

9. Payments to the Contractor

Within fifteen (15) days after receipt from the Contractor of a proper and satisfactory periodic estimate requesting payment of the amount due for the preceding month, the Owner shall have fifteen (15) days to make payment for:

- A. The work performed during the preceding month.
- B. The materials not incorporated in the Work but delivered and suitably stored at the site (or at some location agreed upon in writing) to which the Contractor has title, or to which a Subcontractor has title and has authorized the Contractor to transfer title to the Owner.
- C. Less the following retention items:
 - 1. A retention based on an estimate of the fair value of the Owner's claims against the Contractor.
 - 2. A retention for direct payments to Subcontractors, if any, based on demands for same in accordance with the provisions of Section 39F of Chapter 30 of the General Laws.

3. A retention not exceeding five percent (5%) of the approved amount of the periodic payment.
- D. After the receipt of a periodic estimate requesting final payment and within sixty-five (65) days after the Contractor fully completes the Work, or substantially completes the Work so that the value of the Work remaining to be done is, on the estimate of the Owner, less than 1% of the original Contract Price, or substantially completes the Work and the Owner takes possession or occupancy, whichever occurs first, the Owner shall pay the Contractor the entire balance due on the Contract less:
1. A retention based on an estimate of the fair value of the Owner's claims against the Contractor and of the cost of completing the incomplete and unsatisfactory items of work.
 2. A retention for direct payments to Subcontractors, if any, based on demands of same in accordance with the provisions of Section 39F of Chapter 30 of the General Laws, or based on the record of payments by the Contractor to the Subcontractors under this Contract if such record of payment indicates that the Contractor has not paid Subcontractors as provided in Section 39F of Chapter 30 of the General Laws.

If the Owner fails to make payment as herein provided, there shall be added to each such payment, daily interest at the rate of 3 percentage points above the rediscount rate than charged by the Federal Reserve Bank of Boston, commencing on the first day after said payment is due, and continuing until the payment is delivered or mailed to the Contractor; provided that no interest shall be due, in any event, on the amount of a periodic estimate for final payment until fifteen (15) days after receipt of such a periodic estimate by the Owner as provided in the first paragraph of this Article. The Contractor agrees to pay to each subcontractor a portion of any such interest paid in accordance with the amount due each subcontractor.

The Owner may make changes in any periodic estimate submitted by the Contractor and the payment due on said periodic estimate shall be computed in accordance with the changes so made, and such changes and any requirements for a corrected periodic estimate shall not affect the due date for the periodic payment or the date for the commencement of interest charges on the amount of the periodic payment computed in accordance with the changes made, as provided herein; provided further, that the Owner may, within seven (7) days after receipt, return to the Contractor for correction, any periodic estimate which is not in acceptable form or which contains computations not arithmetically correct, and in that event, the date of receipt of such periodic estimate shall be the date of receipt of the corrected periodic estimate in proper form and with arithmetically correct computations. The date of receipt of a periodic estimate received on a Saturday shall be the first working day thereafter.

- E. Changes in the Work: No changes in the work covered by the approved Contract Documents shall be made without prior written approval of the Owner. Charges or credits for the work covered by the approved change shall be determined by one or more, or a combination of the following methods:
- (a) Unit bid prices previously approved.

- (b) An agreed lump sum.
- (c) The actual cost of:
 - (1) Labor.
 - (2) Materials entering permanently into the work.
 - (3) The ownership or rental cost of construction equipment during the time of use on the extra work.
 - (4) Power and consumable supplies for the operation of power equipment.
 - (5) Wages to be paid.

To the cost under (c) there shall be added a fixed fee to be agreed upon but not to exceed fifteen percent (15%) of the actual cost of work. The fee shall be compensation to cover the cost of supervision, overhead, bond, profit and any other general expenses.

- F. Claims for Additional Costs: If the Contractor wishes to make a claim for an increase in the Contract Sum, he shall give the Owner written notice thereof within twenty days after the occurrence of the event giving rise to such claim. This notice shall be given by the Contractor before proceeding to execute the Work, except in an emergency endangering life or property. No such claim shall be valid unless so made. Any change in the Contract Sum resulting from such claim shall be authorized by Change Order.

The Contractor hereby agrees that the Contractor shall have no claim for damages of any kind against the Town on account of any delay in the commencement or performance of the work and/or any hindrance, delay or suspension of any portion of the work including, but not limited to, any claims or damages on account of having to perform out of sequence work, claims for damages on account of loss of production or other interference with the work whether such delay is caused by the Town or otherwise, except as and to the extent expressly provided under G.L. c.30, §39O in the case of written orders by the Town. The Contractor acknowledges that the Contractor's sole remedy for any such claim will be an extension of time as provided herein.

10. Final Payment, Effect

The acceptance of final payment by the Contractor shall constitute a waiver of all claims by the Contractor arising under the Agreement.

11. Contract Documents

The Contract Documents consist of the following, together with this Agreement:

Invitation to Bid
Instructions to Bidders
This Contract Form
Bid Form
Performance Bond
Labor & Materials Payment Bond
Non-Collusion Certificate
Tax Compliance Certificate
Clerk's Certificate of Corporate Vote
Certificate of Insurance
General Conditions
Supplementary General Conditions
General Requirements
Specifications and Addenda
Contract Drawings
Schedule of Prevailing Wages
(Strike out any inapplicable item)

12. Terms Required By Law

This Agreement shall be considered to include all terms required to be included in it by the Massachusetts General Laws, and all other laws, as though such terms were set forth in full herein.

13. Indemnification

The Contractor shall indemnify and hold harmless the Owner from and against any and all claims, damages, losses, and expenses, including attorney's fees, arising out of the performance of this Agreement when such claims, damages, losses, and expenses are caused, in whole or in part, by the acts, errors, or omissions of the Contractor or his employees, agents, subcontractors or representatives.

14. Insurance

The Contractor shall purchase and maintain such insurance as will protect both the Owner and the Contractor from claims which may arise under the Agreement, including operations performed for the named insured by independent contractors and general inspection thereof by the named insured. In addition, the Contractor shall require its subcontractors to maintain such insurance. Coverage shall be provided for:

- .1 claims under workers' or workmen's compensation, disability benefit and other applicable employee benefit acts;

- .2 claims for damages because of bodily injury, occupational sickness or disease, or death of Contractor's employees;
- .3 claims for damages because of bodily injury, sickness or disease, or death of any person other than Contractor's employees;
- .4 claims for damages insured by usual personal injury liability coverage which are sustained (1) by any person as a result of an offense directly or indirectly related to the employment of such person by the Contractor, or (2) by any other person;
- .5 claims for damages, including damages to the Work itself, because of injury to or destruction of tangible property, including loss of use resulting therefrom; and
- .6 claims for damages because of bodily injury or death of any person or property damage arising out of the ownership, maintenance or use of any motor vehicle.
- .7 claims involving contractual liability applicable to the Contractor's obligations under Article 13.

The limits of liability for coverage required under the preceding paragraph shall be as Specified in the Supplemental Conditions.

Except for Workmen's Compensation, all liability coverage shall name the Town as an additional insured and shall provide for 30 days prior written notice to the Town of any modification or termination of coverage provided thereby. The Contractor shall provide the Owner with appropriate certificate(s) of insurance evidencing compliance with this provision prior to the commencement of any work under this Agreement.

15. Notice

All notices required to be given hereunder shall be in writing and delivered to, or mailed first class to, the parties' respective addresses stated above. In the event that immediate notice is required, it may be given by telephone or facsimile, but shall, to the extent possible, be followed by notice in writing in the manner set forth above.

16. Termination

- A. Each party shall have the right to terminate this Agreement in the event of a failure of the other party to comply with the terms of the Agreement. Such termination shall be effective upon seven days' notice to the party in default and the failure within that time of said party to cure its default.
- B. The Owner shall have the right to terminate the Agreement without cause, upon ten (10) days' written notice to the Contractor. In the event that the Agreement is terminated pursuant to this subparagraph, the Contractor shall be reimbursed in accordance with the Contract Documents for all Work performed up to the termination date, and for all materials or equipment not incorporated in the Work, but delivered and suitably stored at

the site. Payment for material or equipment stored at the site shall be conditioned upon submission by the Contractor of bills of sale or such other evidence as is satisfactory to Owner to establish the Owner's title to such material or equipment or otherwise protect the Owner's interests.

17. Miscellaneous

- A. Royalties and Patents: The Contractor shall pay all royalties and license fees. He shall defend all suits or claims for infringement of any patent rights and shall save the Owner harmless from loss on account thereof, except that the Owner shall be responsible for all such loss when a particular design, process or the product of a particular manufacturer or manufacturers is specified; but if the Contractor believes or has reason to believe that the design, process or product specified is an infringement of a patent, he shall be responsible for such loss unless he promptly gives such information to the Owner, and thereafter the Owner insists on the use of the design, process or products specified.
- B. Assignment: The Contractor shall not assign or transfer any of its rights, duties or obligations under this Agreement without the written approval of the Owner.
- C. Governing Law: This Agreement shall be governed by and construed in accordance with the law of the Commonwealth of Massachusetts.
- D. By its signature hereon, the Contractor certifies, under the pains and penalties of perjury, that it has complied with all laws of the Commonwealth of Massachusetts relating to taxes, reporting of employees and contractors, and withholding and remitting child support.

[Remainder of page intentionally blank.]

AGREED:

TOWN OF DEDHAM, MASSACHUSETTS
(Owner)

By _____

(Name)

(Title)

CONTRACTOR: _____

By _____

(Name)

(Title)

(Address)

(City and State)

Approved as to Form:

By _____
(Owner's Counsel)

In accordance with G.L. c.44, Section 31C, this is to certify that an appropriation in the amount of this contract is available therefor and that the _____ has been authorized to execute the contract and approve all requisitions and change orders.

By _____
(Owner's Accountant)

(Name)

CERTIFICATE OF VOTE
(to be filed if Contractor is a Corporation)

I, _____, hereby certify that I am the duly qualified
(Secretary of the Corporation)

and acting Secretary of _____ and I further certify that a meeting of the
(Name of Corporation)
Directors of said Company, duly called and held on _____, at which
(Date of Meeting)

all Directors were present and voting, the following vote was unanimously passed:

VOTED: To authorize and empower

Anyone acting singly, to execute Forms of General Bid, Contracts or Bonds on behalf of the Corporation.

I further certify that the above vote is still in effect and has not been changed or modified in any respect.

By: _____
(Secretary of Corporation)

A True Copy:

Attest: _____
(Notary Public)

My Commission Expires: _____
(Date)

**CERTIFICATIONS REQUIRED BY LAW
FOR PUBLIC CONSTRUCTION CONTRACTS**

You must COMPLETE and SIGN the following certifications. You must also print, at the bottom of this page, the name of the contractor for whom these certifications are submitted.

TAX COMPLIANCE

Pursuant to Chapter 62C of the Massachusetts General Laws, Section 49A(b), I, the undersigned, authorized signatory for the below named contractor, do hereby certify under the pains and penalties of perjury that said contractor has complied with all laws of the Commonwealth of Massachusetts relating to taxes, reporting of employees and contractors, and withholding and remitting child support.

NON-COLLUSION

The undersigned certifies under the penalties of perjury that this bid is in all respects bona fide, fair and made without collusion or fraud with any other person. As used in this subsection the word "person" shall mean any natural person, joint venture, partnership, corporation or other business or legal entity.

PUBLIC CONTRACTOR DEBARMENT

The undersigned certifies under penalty of perjury that the below named contractor is not presently debarred from doing public construction work in the commonwealth under the provisions of section twenty-nine F of chapter twenty-nine, or any other applicable debarment provisions of any other chapter of the General Laws or any rule or regulation promulgated thereunder.

OSHA TRAINING

Pursuant to G.L. c. 30, §39S, the Contractor hereby certifies under penalties of perjury as follows:

- (1) Contractor is able to furnish labor that can work in harmony with all other elements of labor employed or to be employed in the work;
- (2) All employees to be employed at the worksite will have successfully completed a course in construction safety and health approved by the United States Occupational Safety and Health Administration that is at least 10 hours in duration at the time the employee begins work and they shall furnish documentation of successful completion of said course with the first certified payroll report for each employee; and
- (3) All employees to be employed in the work subject to this contract have successfully completed a course in construction safety and health approved by the United States Occupational Safety and Health Administration that is at least 10 hours in duration.

COMPLETE AND SIGN BELOW:

Authorized Person's Signature

Date

Print Name & Title of Signatory

Name of Contractor

SECTION 00610

PERFORMANCE BOND

KNOW ALL MEN BY THESE PRESENTS: That we _____
(Name of Contractor)

a _____ hereinafter called "Principal" and
(Corporation, Partnership, Joint Venture or Individual)

_____ of _____, State of _____
(Surety) (City & State)

_____ hereinafter called the "Surety" and licensed by the State
Division of Insurance to do business under the laws of the Commonwealth of Massachusetts, are
held and firmly bound to the City/Town of _____, Massachusetts, hereinafter called
"Owner", in the penal sum of

_____ Dollars
(\$ _____) in lawful money of the United States, for the payment of which
sum well and truly to be made, we bind ourselves, our heirs, executors, administrators and
successors, jointly and severally, firmly by these presents.

THE CONDITION OF THIS OBLIGATION is such that Whereas, the Principal entered
into a certain contract with the Owner, dated the _____ day of _____,
20__ (the "Construction Contract"), for the construction described as follows: _____

Howe Lot Fence Restoration

NOW, THEREFORE, if the Principal shall well, truly and faithfully perform its duties,
all the undertakings, covenants, terms, conditions, and agreements of the Construction Contract
during the original term thereof, and any extensions thereof which may be granted by the Owner,
with or without notice to the Surety, and if he shall satisfy all claims and demands incurred under
the Construction Contract, and shall fully indemnify and save harmless the Owner from all costs
and damages which it may suffer by reason of failure to do so, and shall reimburse and repay the
Owner all outlay and expense which the Owner may incur in making good any default, then this
obligation shall be void; otherwise to remain in full force and effect.

PROVIDED, FURTHER, that the Surety's obligation under this Bond shall arise after (1)
the Owner has declared the Principal in default of the Construction Contract or any provision
thereof or (2) has declared that the Principal has failed, or is otherwise unable or unwilling, to
execute the work consistent with, and in conformance to, the Construction Contract (collectively
referred to as a "Contractor Default"). The determination of a Contractor Default shall be made
solely by the Owner. The Owner need not terminate the Construction Contract to declare a
Contractor Default or to invoke its rights under this Bond.

When the Surety's obligation under this Bond arises, the Surety, at its sole expense and at the consent and election of the Owner, shall promptly take one of the following steps: (1) arrange for the Principal to perform and complete the work of the Construction Contract; (2) arrange for a contractor other than the Principal to perform and complete the work of the Construction Contract; (3) reimburse the Owner, in a manner and at such time as the Owner shall decide, for all costs and expenses incurred by the Owner in performing and completing the work of the Construction Contract. Surety will keep Owner reasonably informed of the progress, status and results of any investigation of any claim of the Owner.

If the Surety does not proceed as provided in this Bond with due diligence and all deliberate speed, the Surety shall be deemed to be in default of this Bond, and the Owner shall be entitled to enforce any remedy available to the Owner.

After the Surety's obligation under this Bond arises, the Surety is obligated, to the limit of the amounts of this Bond, for (1) the correction of defective work and completion of the Construction Contract; (2) additional design, professional services, and legal costs, including attorneys' fees, resulting from the Contractor Default or from the default of the Surety under this Bond; (3) any additional work beyond the Construction Contract made necessary by the Contractor Default or default of the Surety under this Bond; (4) indemnification obligation of the Principal, if any, as provided in the Construction Contract; and (5) liquidated damages as provided in the Construction Contract, or if none are so specified, actual and foreseeable consequential damages resulting from the Contractor Default or default of the Surety under this Bond.

Any proceeding, legal or equitable, under this Bond shall be instituted in any court of competent jurisdiction in the Commonwealth of Massachusetts.

The Surety, for value received, hereby stipulates and agrees that no change, extension of time, alteration or addition to the terms of the Construction Contract or to the work to be performed thereunder or the specifications accompanying the same shall in any way affect its obligation on this Bond, and it does hereby waive notice of any such change, extension of time, alteration or addition to the terms of the Construction Contract or to the work or to the specifications.

SECTION 00620

PAYMENT BOND

KNOW ALL MEN BY THESE PRESENTS: That we _____

_____ a _____
(Name of Contractor) (Corporation, Partnership, Joint Venture or Individual)

hereinafter called "Principal" and _____ of _____,
(Surety)

State of _____ hereinafter called the "Surety" and licensed by the State
(City and State)

Division of Insurance to do business under the laws of the Commonwealth of Massachusetts, are held and firmly bound to the City/Town of _____, Massachusetts, hereinafter called "Owner", in the penal sum of _____ Dollars

(\$ _____) in lawful money of the United States, for the payment of which sum well and truly to be made, we bind ourselves, our heirs, executors, administrators and successors, jointly and severally, firmly by these presents.

THE CONDITION OF THIS OBLIGATION is such that Whereas, the Principal entered into a certain contract with the Owner, dated the _____ day of _____, 20____, for the construction described as follows:

Howe Lot Fence Restoration

NOW, THEREFORE, if the Principal shall promptly make payment to all persons, firms, subcontractors, and corporations furnishing materials for or performing labor in the prosecution of the work provided for in such contract, and any authorized extension or modification thereof, including all amounts due for materials, lubricants, oil, gasoline, coal and coke, repairs on machinery, equipment and tools, consumed or used in connection with the construction of such work, and all insurance premiums on said work, and for all labor, performed in such work whether by subcontractor or otherwise, then this obligation shall be void; otherwise to remain in full force and effect.

PROVIDED, FURTHER, that the said Surety, for value received hereby stipulates and agrees that no change, extension of time, alteration or addition to the terms of the contract or to the work to be performed thereunder or the specifications accompanying the same shall in any way affect its obligation on this bond, and it does hereby waive notice of any such change, extension of time, alteration or addition to the terms of this contract or to the work or to the specifications.

SECTION 00800

SUPPLEMENTAL CONDITIONS

	<u>Page</u>
1. Introduction	2
2. Prevailing Wage Rates	2
3. Insurance Requirements	2

SECTION 00850 - Incorporation of Applicable Provisions of the Massachusetts General Laws

Attachment A - Wage Rates and Certificate
of Compliance

§ SC 1.1 INTRODUCTION

The following provisions modify, change, delete from or add to Section 00500 Agreement. Where any Subsection of the Agreement is modified or any Article Paragraph, Subparagraph or Clause thereof is modified or deleted by these Supplemental Conditions, the unaltered provisions of that Article, Paragraph, Subparagraph or Clause shall remain in effect.

§ SC 2.1 PREVAILING WAGE

In accordance with General Laws Chapter 149, Section 26 through 27D, the Contractor is obligated to comply with the prevailing wage rates established by the Commissioner of the Department of Labor and Workforce Development for mechanics, apprentices, chauffeurs, teamsters and laborers employed on the Project. The schedule of applicable prevailing wage rates for the Project, together with a Certificate of Compliance therewith, are set forth in Attachment A herein.

§ SC 3.1 CONTRACTOR'S LIABILITY INSURANCE

The Contractor shall provide certificates of insurance acceptable to the OWNER prior to the commencement of the work. The minimum coverage to be provided shall be as follows:

	Occurrence	Aggregate
<hr/>		
A. Owners Protective Liability:		
Bodily Injury	\$1,000,000	\$1,000,000
Property Damage	\$1,000,000	\$1,000,000
<hr/>		
B. Comprehensive General Liability		
Bodily Injury	\$1,000,000	\$2,000,000
Property Damage	\$1,000,000	\$2,000,000
Including: 1. Operations/Premises 2. XCU 3. Products/Completed Operations 4. Contractual as Below 5. Independent Contractors 6. Broad Form Property Damage 7. Personal Injury		
<hr/>		
C. Auto Liability	Per Person	Per Accident
Bodily Injury	\$1,000,000	\$1,000,000
Property Damage		\$1,000,000
Including: 1. All Owned 2. Hired 3. Non-owned		
<hr/>		
D. Workman's Compensation Compensation Statutory State(s) Coverage B Limit \$1,000,000 if Applicable		
<hr/>		
E. Umbrella Liability \$2,000,000 Aggregate		
<hr/>		
F. Builder's Risk Insurance - "All Risk" Completed Value Form		\$0.00
As Specified in Contract or Agreement		
<hr/>		
G. Pollution Liability Insurance	\$1,000,000	\$1,000,000

SECTION 00850

Excerpts from Chapter 149 and Chapter 30 of the Massachusetts General Laws

Certain excerpts from the Massachusetts General Laws are applicable to Construction contracts. Attention is directed to the following Sections of Chapter 149 as amended:

Section 25. "Every employee in public work shall lodge, board, and trade where and with whom he elects; and no person or his agents or employees under contract with the commonwealth, a county, city or town, or with a department, board, commission or officer acting therefor, for the doing of public work shall directly or indirectly require, as a condition of employment therein, that the employee shall lodge, board or trade at a particular place or with a particular person. This section shall be made a part of the contract for such employment."

Section 26. "In the employment of mechanics and apprentices, teamsters, chauffeurs and laborers in the construction of public works by the commonwealth, or by a county, town or district, or by persons contracting or subcontracting for such works, preference shall first be given to citizens of the commonwealth who have been residents of the commonwealth for at least six months at the commencement of their employment who are male veterans as defined in clause Forty-third of section seven of chapter four, and who are qualified to perform the work to which the employment relates; and secondly, to citizens of the commonwealth generally who have been residents of the commonwealth for at least six months at the commencement of their employment, and if they cannot be obtained in sufficient numbers, then to citizens of the United States, and every contract for such work shall contain a provisions to this effect..."

Section 34. "Every contract, except for the purchase of material or supplies, involving the employment of laborers workmen, mechanics, foremen or inspectors, to which the commonwealth or any county or any town, subject to section thirty, is a party, shall contain a stipulation that no laborer, workman, mechanic, foreman or inspector working within the commonwealth, in the employ of the contractor, subcontractor or other person doing or contracting to do the whole or a part of the work contemplated by the contract, shall be required or permitted to work more than eight hours in any one-day or more than forty-eight hours in any one week, or more than six-days in any one week, except in cases of emergency, or in case any town subject to section thirty-one is a party to such a contract, more than eight hours in any one-day except as aforesaid..."

Section 34A. "Every contract for the construction, alteration, maintenance, repair or demolition of or addition to, any public building or other public works for the commonwealth or any political subdivision thereof shall contain stipulations requiring that the contractor shall, before commencing performance of such contract, provide by insurance for the payment of compensation and the furnishing of other benefits under chapter one hundred and fifty-two to all persons to be employed under the contract, and that the contractor shall continue such insurance in full force and effect during the term of the contract. No officer or agent contracting in behalf of the commonwealth or any political subdivision thereof shall award such a contract until he has been furnished with

sufficient proof of compliance with the aforesaid stipulations. Failure to provide and continue in force such insurance as aforesaid shall be deemed a material breach of the contract and shall operate as an immediate termination thereof. No cancellation of such insurance, whether by the insurer or by the insured, shall be valid unless written notice thereof is given by the party proposing cancellation to the other party and to the officer or agent who awarded the contract at least fifteen-days prior to the intended effective date thereof, which date shall be expressed in said notice. Notice of cancellation sent by the party proposing cancellation by registered mail, postage prepaid, with a return receipt of the addressee requested, shall be a sufficient notice..."

Section 34B. "Every contract for the construction, alteration, maintenance, repair or demolition of, or addition to, any public works for the commonwealth or any political subdivision thereof shall contain stipulations requiring that the contractor shall pay to any reserve police officer employed by him in any city or town the prevailing rate of wage paid to regular police officers employed by him in such city or town."

Attention is directed to the following sections of Chapter 30 of the General Laws of Massachusetts as amended to date:

Section 39F. "(1) Every contract awarded pursuant to sections forty-four A to L inclusive, of chapter one hundred and forty-nine shall contain the following subparagraphs (a) through (i) and every contract awarded pursuant to section thirty-nine M of chapter thirty shall contain the following subparagraphs (a) through (h) and in each case those subparagraphs shall be binding between the general contractor and each subcontractor."

- "(a) Forthwith after the general contractor receives payment on account of a periodic estimate, the general contractor shall pay to each subcontractor the amount paid for the labor performed and the materials furnished by that subcontractor, less any amount specified in any court proceedings barring such payment and also less any amount claimed due from the subcontractor by the general contractor.

- "(b) Not later than the sixty-fifth-day after each subcontractor substantially completes his work in accordance with the plans and specifications, the entire balance due under the subcontract less amounts retained by the awarding authority as the estimated cost of completing the incomplete and unsatisfactory items of work, shall be due the subcontractor; and the awarding authority shall pay that amount to the general contractor. The general contractor shall forthwith pay to the subcontractor the full amount received from the awarding authority less any amount specified in any court proceedings barring such payment and also less any amount claimed due from the subcontractor by the general contractor.

- "(c) Each payment made by the awarding authority to the general contractor pursuant to subparagraphs (a) and (b) of this paragraph for the labor performed and the materials furnished by a subcontractor shall be made to the general contractor for the account of that subcontractor; and the awarding authority shall take reasonable steps to compel the general

contractor to make each such payment to each such subcontractor. If the awarding authority has received a demand for direct payment from a subcontractor for any amount which has already been included in a payment to the general contractor or which is to be included in a payment to the general contractor for payment to the subcontractor as provided in subparagraphs (a) and (b), the awarding authority shall act upon the demand as provided in this section.

- "(d) If, within seventy-days after the subcontractor has substantially completed the subcontract work, the subcontractor has not received from the general contractor the balance due under the subcontract including any amount due for extra labor and materials furnished to the general contractor, less any amount retained by the awarding authority as the estimated cost of completing the incomplete and unsatisfactory items of work, the subcontractor may demand direct payment of that balance from the awarding authority. The demand shall be by a sworn statement delivered to or sent by certified mail to the awarding authority, and a copy shall be delivered or sent by certified mail to the general contractor at the same time. The demand shall contain a detailed breakdown of the balance due under the subcontract and also a statement of the status of completion of the subcontract work. Any demand made after substantial completion of the subcontract work shall be valid even if delivered or mailed prior to the seventieth-day after the subcontractor has substantially completed the subcontract work. Within ten-days after the subcontractor has delivered or so mailed the demand to the awarding authority and delivered or so mailed a copy to the general contractor, the general contractor may reply to the demand. The reply shall be by a sworn statement delivered to or sent by certified mail to the awarding authority and a copy shall be delivered to or sent by certified mail to the subcontractor at the same time. The reply shall contain a detailed breakdown of the balance due under the subcontract including any amount due for extra labor and materials furnished to the general contractor and of the amount due for each claim made by the general contractor against the subcontractor.
- "(e) Within fifteen-days after receipt of the demand by the awarding authority, but in no event prior to the seventieth-day after substantial completion of the subcontract work, the awarding authority shall make direct payment to the subcontractor of the balance due under the subcontract including any amount due for extra labor and materials furnished to the general contractor, less any amount (i) retained by the awarding authority as the estimated cost of completing the incomplete or unsatisfactory items of work, (ii) specified in any court proceedings barring such payment, or (iii) disputed by the general contractor in the sworn reply; provided, that the awarding authority shall not deduct from a direct payment any amount as provided in part (iii) if the reply is not sworn to, or for which the sworn reply does not contain the detailed breakdown required by subparagraph (d). The awarding authority shall make further direct payments to the subcontractor forthwith after the removal of the basis for deductions from direct payments made as provided in parts (i) and (ii) of this subparagraph.

- "(f) The awarding authority shall forthwith deposit the amount deducted from a direct payment as provided in part (iii) of subparagraph (e) in an interest-bearing joint account in the names of the general contractor and the subcontractor in a bank in Massachusetts selected by the awarding authority or agreed upon by the general contractor and the subcontractor and shall notify the general contractor and the subcontractor of the date of the deposit and the bank receiving the deposit. The bank shall pay the amount in the account, including accrued interest, as provided in an agreement between the general contractor and the subcontractor or as determined by decree of a court of competent jurisdiction.
- "(g) All direct payments and all deductions from demands for direct payments deposited in an interest-bearing account or accounts in a bank pursuant to subparagraph (f) shall be made out of amounts payable to the general contractor at the time of receipt of a demand for direct payment from a subcontractor and out of amounts which later become payable to the general contractor and in the order of receipt of such demands from subcontractors. All direct payments shall discharge the obligation of the awarding authority to the general contractor to the extent of such payment.
- "(h) The awarding authority shall deduct from payments to a general contractor amounts which, together with the deposits in interest-bearing accounts pursuant to subparagraph (f), are sufficient to satisfy all unpaid balances of demands for direct payment received from subcontractors. All such amounts shall be earmarked for such direct payments, and the subcontractors shall have a right in such deductions prior to any claims against such amounts by creditors of the general contractor.
- "(i) If the subcontractor does not receive payment as provided in subparagraph (a) or if the general contractor does not submit a periodic estimate for the value of the labor or materials performed or furnished by the subcontractor and the subcontractor does not receive payment for same when due less the deductions provided for in subparagraph (a), the subcontractor may demand direct payment by following the procedure in subparagraph (d) and the general contractor may file a sworn replay as provided in that same subparagraph. A demand made after the first-day of the month following that for which the subcontractor performed or furnished the labor and materials for which the subcontractor seeks payment shall be valid even if delivered or mailed prior to the time payment was due on a periodic estimate from the general contractor. Thereafter the awarding authority shall proceed as provided in subparagraph (e), (f), (g), and (h)."

Section 39G. "Upon substantial completion of the work required by a contract with the commonwealth, or any agency or political subdivision thereof, for the construction, reconstruction, alteration, remodeling, repair or improvement of public ways, including bridges and other highway structures, sewers and water mains, airports and other public works, the contractor shall present in writing to the awarding authority its certification

that the work has been substantially completed. Within twenty-one-days thereafter, the awarding authority shall present to the contractor either a written declaration that the work has been substantially completed or an itemized list of incomplete or unsatisfactory work items required by the contract sufficient to demonstrate that the work has not been substantially completed. The awarding authority may include with such list a notice setting forth a reasonable time, which shall not in any even be prior to the contract completion date, within which the contractor must achieve substantial completion of the work. In the event that the awarding authority fails to respond by presentation of a written declaration or itemized list as aforesaid, to the contractor's certificate within the twenty-one-day period, the contractor's certification shall take effect as the awarding authority's declaration that the work has been substantially completed.

"Within sixty-five-days after the effective date of a declaration of substantial completion, the awarding authority shall prepare and forthwith send to the contractor for acceptance a substantial completion estimate for the quantity and price of the work done and all but one percent retainage on that work, including the quantity, price and all but one percent retainage for the undisputed part of each work item and extra work item in dispute but excluding the disputed part thereof, less the estimated cost of completing all incomplete and unsatisfactory work items and less the total periodic payments made to date for the work. The awarding authority also shall deduct from the substantial completion estimate an amount equal to the sum of all demands for direct payment filed by subcontractors and not yet paid to subcontractors or deposited in joint accounts pursuant to section thirty-nine F, but no contract subject to said section thirty-nine F shall contain any other provisions authorizing the awarding authority to deduct any amount by virtue of claims asserted against the contract by subcontractors, material suppliers or other.

"If the awarding authority fails to prepare and send to the contractor any substantial completion estimate required by this section on or before the date hereinabove set forth, the awarding authority shall pay to the contractor interest on the amount which would have been due to the contractor pursuant to such substantial completion estimate at the rate of three percentage points above the rediscount rate then charged by the Federal Reserve Bank of Boston from such date to the date on which the awarding authority sends that substantial completion estimate to the contractor for acceptance or to the date of payment therefor, whichever occurs first. The awarding authority shall include the amount of such interest in the substantial completion estimate.

"Within fifteen-days after the effective date of the declaration of substantial completion, the awarding authority shall send to the contractor by certified mail, return receipt requested, a complete list of all incomplete or unsatisfactory work items, and, unless delayed by causes beyond his control, the contractor shall complete all such work items within forty-five-days after the receipt of such list or before the then contract completion date, whichever is later. If the contractor fails to complete such work within such time, the awarding authority may, subsequent to seven-days' written notice to the contractor by certified mail, return receipt requested, terminate the contract and complete the incomplete or unsatisfactory work items and charge the cost of same to the contractor.

"Within thirty-days after receipt by the awarding authority of a notice from the contractor stating that all of the work required by the contract has been completed, the awarding authority shall prepare and forthwith send to the contractor for acceptance a final estimate

for the quantity and price of the work done and all retainage on that work less all payments made to date, unless the awarding authority's inspection shows that work items required by the contract remain incomplete or unsatisfactory, or that documentation required by the contract has not been completed. If the awarding authority fails to prepare and send to the contractor the final estimate within thirty-days after receipt of notice of completion, the awarding authority shall pay to the contractor interest on the amount which would have been due to the contractor pursuant to such final estimate at the rate hereinabove provided from the thirtieth-day after such completion until the date on which the awarding authority sends the final estimate to the contractor for acceptance or the date of payment therefor, whichever occurs first, provided that the awarding authority's inspection shows that not work items required by the contract remain incomplete or unsatisfactory. Interest shall not be paid hereunder on amounts for which interest is required to be paid in connection with the substantial completion estimate as hereinabove provided. The awarding authority shall include the amount of the interest required to be paid hereunder in the final estimate.

"The awarding authority shall pay the amount due pursuant to any periodic, substantial completion or final estimate within thirty-five-days after receipt of written acceptance for such estimate from the contractor and shall pay interest on the amount due pursuant to such estimate at the rate hereinabove provided from that thirty-fifth-day to the date of payment. In the case of periodic payment, the contracting authority may deduct from its payment a retention based on its estimate of the fair value of its claim against the contractor, a retention for direct payments to subcontractors based on demands for same in accordance with the provisions of section thirty-nine F, and a retention to secure satisfactory performance of the contractual work not exceeding five percent of the approved amount of any periodic payments, and the same right to retention shall apply to bonded subcontractors entitled to direct payment under section thirty-nine F of chapter thirty; provided that a five percent value of all items that are planted in the ground shall be deducted from the periodic payments until final acceptance.

"No periodic, substantial completion or final estimate or acceptance or payment thereof shall bar a contractor from reserving all rights to dispute the quantity and amount of, or the failure of the awarding authority to approve a quantity and amount of, all or part of any work item or extra work item.

"Substantial completion, for the purposes of this section, shall mean either that the work required by the contract has been completed except for work having a contract price of less than one percent of the then adjusted total contract price, or substantially all of the work has been completed and opened to public use except for minor incomplete or unsatisfactory work items that do not materially impair the usefulness of the work required by the contract."

Section 39K. "Every contract for the construction, reconstruction, alteration, remodeling, repair or demolition of any public building by the commonwealth, or by any county, city, town, district, board, commission or other public body, when the amount is more than five thousand dollars in the case of the commonwealth and more than two thousand dollars in the case of any county, city, town, district, board, commission or public body, shall contain the following paragraph: Within fifteen-days (twenty-four-days in the case of the commonwealth) after receipt from the contractor, at the place

designated by the awarding authority if such a place is so designated, of a periodic estimate requesting payment of the amount due for the preceding month, the awarding authority will make a periodic payment to the contractor for the work performed during the preceding month and for the materials not incorporated in the work but delivered and suitably stored at the site (or at some location agreed upon in writing) to which the contractor has title or to which a subcontractor has title and has authorized the contractor to transfer title to the awarding authority, less (1) a retention based on its estimate of the fair value of its claims against the contractor and less (2) a retention for direct payments to subcontractors based on demands for same in accordance with the provisions of section thirty-nine F, and less (3) a retention not exceeding five percent of the approved amount of the periodic payment. After the receipt of a periodic estimate requesting final payment and within sixty-five-days after (a) the contractor fully completes the work or substantially completes the work so that the value of the work remaining to be done is, in the estimate of the awarding authority, less than one percent of the original contract price, or (b) the contractor substantially completes the work and the awarding authority takes possession for occupancy, whichever occurs first, the awarding authority shall pay the contractor the entire balance due on the contract less, (1) a retention based on its estimate of the fair value of its claims against the contractor and of the cost of completing the incomplete and unsatisfactory items of work less (2) a retention for direct payments to subcontractors based on demand for same in accordance with the provisions of section thirty-nine F, or based on the record of payments by the contractor to the subcontractors under this contract if such record of payment indicates that the contractor has not paid subcontractors as provided in section thirty-nine F. If the awarding authority fails to make payment as herein provided, there shall be added to each such payment daily interest at the rate of three percentage points above the rediscount rate then charged by the Federal Reserve Bank of Boston commencing on the first-day after said payment is due and continuing until the payment is delivered or mailed to the contractor; provided, that no interest shall be due, in any event, on the amount due on a periodic estimate for final payment until fifteen-days (twenty-four-days in the case of the commonwealth) after receipt of such a periodic estimate from the contractor, at the place designated by the awarding authority if such a place is so designated. The contractor agrees to pay to each subcontractor a portion of any such interest paid in accordance with the amount due each subcontractor.

"The awarding authority may make changes in any periodic estimate submitted by the contractor and the payment due on said periodic estimate shall be computed in accordance with the changes so made, but such changes or any requirement for a corrected periodic estimate shall not affect the due date for the periodic payment or the date for the commencement of interest charges on the amount of the periodic payment computed in accordance with the changes made, as provided herein; provided, that the awarding authority may, within seven-days after receipt, return to the contractor for correction, any periodic estimate which is not in the required form or which contains computations not arithmetically corrected and, in that event, the date of receipt of such periodic estimate shall be the date of receipt of the corrected periodic estimate in proper form with arithmetically correct computations. The date of receipt of a periodic estimate received on a Saturday shall be the first working day thereafter. The provisions of section thirty-nine G shall not apply to any contract for the construction, reconstruction, alteration, remodeling, repair or demolition of any public building to which this section applies.

"All periodic estimates shall be submitted to the awarding authority, or to its designee as set forth in writing to the contractor, and the date of receipt by the awarding authority or its designee shall be marked on the estimate. All periodic estimates shall contain a separate item for each filed subtrade and each subtrade listed in sub-bid form as required by specifications and a column listing the amount paid to each filed subcontractor and Sub-subcontractor as of the date the periodic estimate is filed. The person making payment for the awarding authority shall add the daily interest provided for herein to each payment for each day beyond the due date based on the date of receipt marked on the estimate.

"A certificate of the architect to the effect that the contractor has fully or substantially completed the work shall, subject to the provisions of section thirty-nine J, be conclusive for the purposes of this section."

Section 39L. "Public Construction work by foreign corporations; restrictions and reports." The Commonwealth and every county, city, town, district, board, commission or other public body which, as the awarding authority, request proposals, bids or sub-bids for any work in the construction, reconstruction, alteration, remodeling, repair or demolition of any public building or other public works (1) shall not enter into a contract for such work with, and shall not approve as a subcontractor furnishing labor and materials for a part of any such work, a foreign corporation which has not filed with such awarding authority a certificate of the state secretary stating that such corporation has complied with sections three and five of chapter one hundred and eighty-one and the date of such compliance, and (2) shall report to the state secretary and to the department of corporations and taxation any foreign corporation performing work under such contract or subcontract, and any person, other than a corporation, performing work under such contract or subcontract, and residing or having a principal place of business outside the commonwealth.

Section 39M(b). "Specifications for such contracts, and specifications for contracts awarded pursuant to the provisions of said sections forty-four A to forty-four L of said chapter one hundred and forty-nine, shall be written to provide for full competition for each item of material to be furnished under the contract; except, however, that said specifications may be otherwise written for sound reasons in the public interest stated in writing in the public records of the awarding authority or promptly given in writing by the awarding authority to anyone making a written request therefor, in either instance such writing to be prepared after reasonable investigation. Every such contract shall provide that an item equal to that named or described in the said specifications may be furnished; and an item shall be considered equal to the item so named or described if (1) it is at least equal in quality, durability, appearance, strength and design, (2) it will perform at least equally the function imposed by the general design for or the public work being contracted for or the material being purchased, and (3) it conforms substantially, even with deviations, to the detailed requirements for the item in the said specifications.

"For each item of material the specifications shall provide for either a minimum of three named brands of material or a description of material which can be met by a minimum of three manufacturers or producers, and for the equal of any one of said named or described materials."

Section 39N. "Every contract subject to section forty-four A of Chapter one hundred and forty-nine or subject to section thirty-nine M of chapter thirty shall contain the following paragraph in its entirety and an awarding authority may adopt reasonable rules or regulations in conformity with that paragraph concerning the filing, investigation and settlement of such claims:

"If, during the progress of the work, the contractor or the awarding authority discovers that the actual subsurface or latent physical conditions encountered at the site differ substantially or materially from those shown on the plans or indicated in the contract documents either the contractor or the contracting authority may request an equitable adjustment in the contract price of the contract applying to work affected by the differing site conditions. A request for such an adjustment shall be in writing and shall be delivered by the party making such claim to the other party as soon as possible after such conditions are discovered. Upon receipt of such a claim from a contractor, or upon its own initiative, the contracting authority shall make an investigation of such physical conditions, and, if they differ substantially or materially from those shown on the plans or indicated in the contract documents or from those ordinarily encountered and generally recognized as inherent in work of the character provided for in the plans and contract documents and are of such a nature as to cause an increase or decrease in the cost of performance of the work or a change in the construction methods required for the performance of the work which results in an increase or decrease in the cost of the work, the contracting authority shall make an equitable adjustment in the contract price and the contract shall be modified in writing accordingly."

Section 39O. "Every contract subject to the provisions of section thirty-nine M of this chapter or subject to section forty-four A of chapter one hundred forty-nine shall contain the following provisions (a) and (b) in their entirety....

"(a) The awarding authority may order the general contractor in writing to suspend, delay, or interrupt all or any part of the work for such period of time as it may determine to be appropriate for the convenience of the awarding authority; provided however, that if there is a suspension, delay or interruption for fifteen-days or more due to a failure of the awarding authority to act within the time specified in this contract, the awarding authority shall make an adjustment in the contract price for any increase in the cost of performance of this contract but shall not include any profit to the general contractor on such increase; and provided further, that the awarding authority shall not make any adjustment in the contract price under this provision for any suspension, delay, interruption or failure to act to the extent that such is due to any cause for which this contract provides for an equitable adjustment of the contract price under any other contract provisions.

"(b) The general contractor must submit the amount of a claim under provision (a) to the awarding authority in writing as soon as practicable after the end of the suspension, delay, interruption or failure to act and, in any event, not later than the date of final payment under this contract and, except for costs due to a suspension order, the awarding authority shall not approve

any costs in the claim incurred more than twenty-days before the general contractor notified the awarding authority in writing of the act or failure to act involved in the claim.

Section 39P. "Every contract subject to section thirty-nine M of this chapter or section forty-four A of chapter one hundred forty-nine which requires the awarding authority, or any official, its architect or engineer to make a decision on interpretation of the specifications, approval of equipment, material or any other approval, or progress of the work, shall require that the decision be made promptly and, in any event, no later than thirty-days after the written submission for decision; but if such decision requires extended investigation and study, the awarding authority, the official, architect or engineer shall, within thirty-days after the receipt of the submission, give the party making the submission written notice of the reasons why the decision cannot be made within the thirty-day period and the date by which the decision will be made."

Section 39R(a). "The words defined herein shall have the meaning stated below whenever they appear in this section:

- (1) "Contractor" means any person, corporation, partnership, joint venture, sole proprietorship, or other entity awarded a contract pursuant to section thirty-nine M of chapter thirty, sections forty-four A through H, inclusive, of chapter one hundred and forty-nine and sections thirty B through thirty P, inclusive, of chapter seven.
- (2) "Contract" means any contract awarded or executed pursuant to sections thirty B through thirty P, inclusive, of chapter seven and any contract awarded or executed pursuant to section thirty-nine M of chapter thirty, or sections forty-four A through H, inclusive, of chapter one hundred and forty-nine, which is for an amount or estimated amount greater than one hundred thousand dollars.
- (3) "Records" means books of original entry, accounts, checks, bank statements and all other banking documents, correspondence, memoranda, invoices, computer printouts, tapes, discs, papers and other documents or transcribed information of any type, whether expressed in ordinary or machine language.
- (4) "Independent Certified Public Accountant" means a person duly registered in good standing and entitled to practice as a certified public accountant under the laws of the place of his/her residence or principal office and who is in fact independent. In determining whether an accountant is independent with respect to a particular person, appropriate consideration should be given to all relationships between the accountant and that person or any affiliate thereof. Determination of an accountant's independence shall not be confined to the relationships existing in connection with the filing of reports with the awarding authority.
- (5) "Audit," when used in regard to financial statements, means an examination of records by an independent certified public accountant in

accordance with generally accepted accounting principles and auditing standards for the purpose of expressing a certified opinion thereon, or, in the alternative, a qualified opinion or a declination to express an opinion for stated reasons.

- (6) "Accountant's Report," when used in regard to financial statements, means a document in which an independent certified public accountant indicates the scope of the audit which he/she has made and sets forth his/her opinion regarding the financial statements taken as a whole with a listing of noted exceptions and qualifications, or an assertion to the effect that an overall opinion cannot be expressed. When an overall opinion cannot be expressed the reason therefor shall be stated. An accountant's report shall include as a part thereof a signed statement by the responsible corporate officer attesting that management has fully disclosed all material facts to the independent certified public accountant, and that the audited financial statement is a true and complete statement of the financial condition of the contractor.
- (7) "Management," when used herein, means the chief executive officer, partners, principals or other person or persons primarily responsible for the financial and operational policies and practices of the contractor.
- (8) Accounting terms, unless otherwise defined herein, shall have a meaning in accordance with generally accepted accounting principles and auditing standards.
 - (b) Subsection (a)(2) hereof notwithstanding, every agreement or contract awarded or executed pursuant to sections thirty B through thirty P, inclusive, of chapter seven, and pursuant to section thirty-nine M of chapter thirty or to section forth-five A through H, inclusive, of chapter one hundred and forty-nine, shall provide that:
 - (1) The contractor shall make, and keep for at least six years after final payment, books, records, and accounts which in reasonable detail accurately and fairly reflect the transactions and dispositions of the contractor, and
 - (2) Until the expiration of six years after final payment, the awarding authority, office of inspector general, and the deputy commissioner of capital planning and operations shall have the right to examine any books, documents, papers or records of the contractor or of his/her subcontractors that directly pertain to, and involve transactions relating to, the contractor or his/her subcontractors, and
 - (3) If the agreement is a contract as defined herein, the contractor shall describe any change in the method of maintaining records or recording transactions which materially affect any statements filed with the awarding authority, including in his/her description the date of the change

and reasons therefor, and shall accompany said descriptions with a letter from the contractor's independent certified public accountant approving or otherwise commenting on the changes, and

- (4) If the agreement is a contract as defined herein, the contractor has filed a statement of management on internal accounting controls as set forth in paragraph (c) below prior to the execution of the contract, and
- (5) If the agreement is a contract as defined herein, the contractor has filed prior to the execution of the contracts and will continue to file annually, an audited financial statement for the most recent completed fiscal year as set forth in paragraph (d) below.

(c) Every contractor awarded a contract shall file with the awarding authority a statement of management as to whether the system of internal accounting controls of the contractor and subsidiaries reasonably assures that:

- (1) Transactions are executed in accordance with management's general and specific authorization;
- (2) Transactions are recorded as necessary:
 - i. To permit preparation of financial statements in conformity with generally accepted accounting principles, and
 - ii. To maintain accountability for assets;
- (3) Access to assets is permitted only in accordance with management's general or specific authorization; and
- (4) The recorded accountability for assets is compared with the existing assets at reasonable intervals and appropriate action was taken with respect to any difference.

Every contractor awarded a contract shall also file with the awarding authority a statement prepared and signed by an independent certified public accountant, stating that he/she has examined the statement of management on internal accounting controls, and expressing an opinion as to:

- (1) Whether the representations of management in response to this paragraph, and paragraph (b) above are consistent with the result of management's evaluation of the system of internal accounting controls; and
- (2) Whether such representations of management are, in addition, reasonable with respect to transactions and assets in amounts which would be material when measured in relation to the applicant's financial statements.

- (d) Every contractor awarded a contract by the commonwealth or by any political subdivision thereof shall annually file with the awarding authority and the deputy commissioner of capital planning and operations during the term of the contract a financial statement prepared by an independent certified public accountant on the basis of an audit by such accountant. The final statement filed shall include the date of final payment. All statements shall be accompanied by an accountant's report. Such statements shall be made available to the awarding authority upon request.
- (e) The office of inspector general, the deputy commissioner for capital planning and operations and any other awarding authority shall enforce the provisions of this section. The deputy commissioner of capital planning and operations may after providing an opportunity for the inspector general and other interested parties to comment, promulgate pursuant to the provisions of chapter thirty A such rules, regulations and guidelines as are necessary to effectuate the purposes of this section. Such rules, regulations and guidelines may be applicable to all awarding authorities. A contractor's failure to satisfy any of the requirements of this section may be grounds for debarment pursuant to section forty-four C of chapter one hundred and forty-nine."
- (f) Records and statements required to be made, kept or filed under the provisions of this section shall not be public records as defined in section seven of chapter four and shall not be open to public inspection; provided, however, that such records and statements shall be made available pursuant to the provisions of clause (2) of paragraph (b).

Section 40. "Bonds give to the commonwealth, any county, city, town or political subdivision to secure the performance of contracts for the construction or repair of public buildings or other public works may be discharged or released by the awarding authority, upon such terms as it deems expedient, after the expiration of one year from the time of completion, subject to section thirty-nine K, of the work contracted to be done; provided that no claim filed under said bond is pending, and provided further, that no such bonds shall be discharged or released prior to the expiration of all special guarantees provided for in the contract unless new bonds in substitution therefor specifically relating to the unexpired guarantees shall be taken.

EQUAL EMPLOYMENT OPPORTUNITIES

The Contractor and each Subcontractor shall comply with the provisions of the Governor's "Executive Order No. 74", dated July 20, 1970, entitled the "Governor's Code of Fair Practices", as amended by the Governor's "Executive Order No. 116", dated May 1, 1975; with the Fair Employment Practices Law of Massachusetts, as amended; with the Rules and Regulations of the Massachusetts Commission Against Discrimination, as

in force at the date hereof; and with all other applicable municipal, state and federal laws and regulation regarding equal employment opportunity.

ATTACHMENT A



CHARLES D. BAKER
Governor

KARYN E. POLITO
Lt. Governor

THE COMMONWEALTH OF MASSACHUSETTS
EXECUTIVE OFFICE OF LABOR AND WORKFORCE DEVELOPMENT
DEPARTMENT OF LABOR STANDARDS

Prevailing Wage Rates

As determined by the Director under the provisions of the
Massachusetts General Laws, Chapter 149, Sections 26 to 27H

ROSALIN ACOSTA
Secretary
MICHAEL FLANAGAN
Director

Awarding Authority: Town of Dedham
Contract Number: **City/Town:** DEDHAM
Description of Work: Restoration of old iron fencing in Historic Cemetery
Job Location: 30 Village Ave

Information about Prevailing Wage Schedules for Awarding Authorities and Contractors

- This wage schedule applies only to the specific project referenced at the top of this page and uniquely identified by the “Wage Request Number” on all pages of this schedule.
 - An Awarding Authority must request an updated wage schedule from the Department of Labor Standards (“DLS”) if it has not opened bids or selected a contractor within 90 days of the date of issuance of the wage schedule. For CM AT RISK projects (bid pursuant to G.L. c.149A), the earlier of: (a) the execution date of the GMP Amendment, or (b) the bid for the first construction scope of work must be within 90-days of the wage schedule issuance date.
 - The wage schedule shall be incorporated in any advertisement or call for bids for the project as required by M.G.L. c. 149, § 27. The wage schedule shall be made a part of the contract awarded for the project. The wage schedule must be posted in a conspicuous place at the work site for the life of the project in accordance with M.G.L. c. 149 § 27. The wages listed on the wage schedule must be paid to employees performing construction work on the project whether they are employed by the prime contractor, a filed sub-bidder, or any sub-contractor.
 - All apprentices working on the project are required to be registered with the Massachusetts Department of Labor Standards, Division of Apprentice Standards (DLS/DAS). Apprentice must keep his/her apprentice identification card on his/her person during all work hours on the project. An apprentice registered with DAS may be paid the lower apprentice wage rate at the applicable step as provided on the prevailing wage schedule. **Any apprentice not registered with DLS/DAS regardless of whether or not they are registered with any other federal, state, local, or private agency must be paid the journeyworker's rate for the trade.**
 - The wage rates will remain in effect for the duration of the project, except in the case of multi-year public construction projects. For construction projects lasting longer than one year, awarding authorities must request an updated wage schedule. Awarding authorities are required to request these updates no later than two weeks before the anniversary of the date the contract was executed by the awarding authority and the general contractor. For multi-year CM AT RISK projects, awarding authority must request an annual update no later than two weeks before the anniversary date, determined as the earlier of: (a) the execution date of the GMP Amendment, or (b) the execution date of the first amendment to permit procurement of construction services. Contractors are required to obtain the wage schedules from awarding authorities, and to pay no less than these rates to covered workers. The annual update requirement is not applicable to 27F “rental of equipment” contracts.
 - Every contractor or subcontractor which performs construction work on the project is required to submit weekly payroll reports and a Statement of Compliance directly to the awarding authority by mail or email and keep them on file for three years. Each weekly payroll report must contain: the employee’s name, address, occupational classification, hours worked, and wages paid. Do not submit weekly payroll reports to DLS. A sample of a payroll reporting form may be obtained at <http://www.mass.gov/dols/pw>.
 - Contractors with questions about the wage rates or classifications included on the wage schedule have an affirmative obligation to inquire with DLS at (617) 626-6953.
 - Employees not receiving the prevailing wage rate set forth on the wage schedule may report the violation to the Fair Labor Division of the office of the Attorney General at (617) 727-3465.
 - Failure of a contractor or subcontractor to pay the prevailing wage rates listed on the wage schedule to all employees who perform construction work on the project is a violation of the law and subjects the contractor or subcontractor to civil and criminal penalties.
-

Classification	Effective Date	Base Wage	Health	Pension	Supplemental Unemployment	Total Rate
Construction						
(2 AXLE) DRIVER - EQUIPMENT <i>TEAMSTERS JOINT COUNCIL NO. 10 ZONE A</i>	12/01/2020	\$36.25	\$12.91	\$14.82	\$0.00	\$63.98
	06/01/2021	\$37.05	\$12.91	\$14.82	\$0.00	\$64.78
	08/01/2021	\$37.05	\$13.41	\$14.82	\$0.00	\$65.28
	12/01/2021	\$37.05	\$13.41	\$16.01	\$0.00	\$66.47
(3 AXLE) DRIVER - EQUIPMENT <i>TEAMSTERS JOINT COUNCIL NO. 10 ZONE A</i>	12/01/2020	\$36.32	\$12.91	\$14.82	\$0.00	\$64.05
	06/01/2021	\$37.12	\$12.91	\$14.82	\$0.00	\$64.85
	08/01/2021	\$37.12	\$13.41	\$14.82	\$0.00	\$65.35
	12/01/2021	\$37.12	\$13.41	\$16.01	\$0.00	\$66.54
(4 & 5 AXLE) DRIVER - EQUIPMENT <i>TEAMSTERS JOINT COUNCIL NO. 10 ZONE A</i>	12/01/2020	\$36.44	\$12.91	\$14.82	\$0.00	\$64.17
	06/01/2021	\$37.24	\$12.91	\$14.82	\$0.00	\$64.97
	08/01/2021	\$37.24	\$13.41	\$14.82	\$0.00	\$65.47
	12/01/2021	\$37.24	\$13.41	\$16.01	\$0.00	\$66.66
ADS/SUBMERSIBLE PILOT <i>PILE DRIVER LOCAL 56 (ZONE 1)</i>	08/01/2020	\$103.05	\$9.40	\$23.12	\$0.00	\$135.57
For apprentice rates see "Apprentice- PILE DRIVER"						
AIR TRACK OPERATOR <i>LABORERS - ZONE 1</i>	12/01/2020	\$40.65	\$8.60	\$17.32	\$0.00	\$66.57
	06/01/2021	\$41.67	\$8.60	\$17.32	\$0.00	\$67.59
	12/01/2021	\$42.68	\$8.60	\$17.32	\$0.00	\$68.60
	06/01/2022	\$43.68	\$8.60	\$17.32	\$0.00	\$69.60
	12/01/2022	\$44.68	\$8.60	\$17.32	\$0.00	\$70.60
	06/01/2023	\$45.68	\$8.60	\$17.32	\$0.00	\$71.60
	12/01/2023	\$46.93	\$8.60	\$17.32	\$0.00	\$72.85
For apprentice rates see "Apprentice- LABORER"						
AIR TRACK OPERATOR (HEAVY & HIGHWAY) <i>LABORERS - ZONE 1 (HEAVY & HIGHWAY)</i>	12/01/2020	\$40.65	\$8.60	\$17.32	\$0.00	\$66.57
	06/01/2021	\$41.67	\$8.60	\$17.32	\$0.00	\$67.59
	12/01/2021	\$42.68	\$8.60	\$17.32	\$0.00	\$68.60
For apprentice rates see "Apprentice- LABORER (Heavy and Highway)"						
ASBESTOS REMOVER - PIPE / MECH. EQUIPT. <i>HEAT & FROST INSULATORS LOCAL 6 (BOSTON)</i>	12/01/2020	\$38.10	\$12.80	\$9.45	\$0.00	\$60.35
ASPHALT RAKER <i>LABORERS - ZONE 1</i>	12/01/2020	\$40.15	\$8.60	\$17.32	\$0.00	\$66.07
	06/01/2021	\$41.17	\$8.60	\$17.32	\$0.00	\$67.09
	12/01/2021	\$42.18	\$8.60	\$17.32	\$0.00	\$68.10
	06/01/2022	\$43.18	\$8.60	\$17.32	\$0.00	\$69.10
	12/01/2022	\$44.18	\$8.60	\$17.32	\$0.00	\$70.10
	06/01/2023	\$45.18	\$8.60	\$17.32	\$0.00	\$71.10
	12/01/2023	\$46.43	\$8.60	\$17.32	\$0.00	\$72.35
For apprentice rates see "Apprentice- LABORER"						
ASPHALT RAKER (HEAVY & HIGHWAY) <i>LABORERS - ZONE 1 (HEAVY & HIGHWAY)</i>	12/01/2020	\$40.15	\$8.60	\$17.32	\$0.00	\$66.07
	06/01/2021	\$41.17	\$8.60	\$17.32	\$0.00	\$67.09
	12/01/2021	\$42.18	\$8.60	\$17.32	\$0.00	\$68.10
For apprentice rates see "Apprentice- LABORER (Heavy and Highway)"						
ASPHALT/CONCRETE/CRUSHER PLANT-ON SITE <i>OPERATING ENGINEERS LOCAL 4</i>	12/01/2020	\$49.98	\$13.50	\$15.70	\$0.00	\$79.18
	06/01/2021	\$51.08	\$13.50	\$15.70	\$0.00	\$80.28
	12/01/2021	\$52.23	\$13.50	\$15.70	\$0.00	\$81.43
For apprentice rates see "Apprentice- OPERATING ENGINEERS"						

Classification	Effective Date	Base Wage	Health	Pension	Supplemental Unemployment	Total Rate
BACKHOE/FRONT-END LOADER <i>OPERATING ENGINEERS LOCAL 4</i>	12/01/2020	\$49.98	\$13.50	\$15.70	\$0.00	\$79.18
	06/01/2021	\$51.08	\$13.50	\$15.70	\$0.00	\$80.28
	12/01/2021	\$52.23	\$13.50	\$15.70	\$0.00	\$81.43
For apprentice rates see "Apprentice- OPERATING ENGINEERS"						
BARCO-TYPE JUMPING TAMPER <i>LABORERS - ZONE 1</i>	12/01/2020	\$40.15	\$8.60	\$17.32	\$0.00	\$66.07
	06/01/2021	\$41.17	\$8.60	\$17.32	\$0.00	\$67.09
	12/01/2021	\$42.18	\$8.60	\$17.32	\$0.00	\$68.10
	06/01/2022	\$43.18	\$8.60	\$17.32	\$0.00	\$69.10
	12/01/2022	\$44.18	\$8.60	\$17.32	\$0.00	\$70.10
	06/01/2023	\$45.18	\$8.60	\$17.32	\$0.00	\$71.10
	12/01/2023	\$46.43	\$8.60	\$17.32	\$0.00	\$72.35
For apprentice rates see "Apprentice- LABORER"						
BLOCK PAVER, RAMMER / CURB SETTER <i>LABORERS - ZONE 1</i>	12/01/2020	\$40.65	\$8.60	\$17.32	\$0.00	\$66.57
	06/01/2021	\$41.67	\$8.60	\$17.32	\$0.00	\$67.59
	12/01/2021	\$42.68	\$8.60	\$17.32	\$0.00	\$68.60
	06/01/2022	\$43.68	\$8.60	\$17.32	\$0.00	\$69.60
	12/01/2022	\$44.68	\$8.60	\$17.32	\$0.00	\$70.60
	06/01/2023	\$45.68	\$8.60	\$17.32	\$0.00	\$71.60
	12/01/2023	\$46.93	\$8.60	\$17.32	\$0.00	\$72.85
For apprentice rates see "Apprentice- LABORER"						
BLOCK PAVER, RAMMER / CURB SETTER (HEAVY & HIGHWAY) <i>LABORERS - ZONE 1 (HEAVY & HIGHWAY)</i>	12/01/2020	\$40.65	\$8.60	\$17.32	\$0.00	\$66.57
	06/01/2021	\$41.67	\$8.60	\$17.32	\$0.00	\$67.59
	12/01/2021	\$42.68	\$8.60	\$17.32	\$0.00	\$68.60
For apprentice rates see "Apprentice- LABORER (Heavy and Highway)"						
BOILER MAKER <i>BOILERMAKERS LOCAL 29</i>	01/01/2020	\$46.10	\$7.07	\$17.98	\$0.00	\$71.15

Apprentice - BOILERMAKER - Local 29

Effective Date - 01/01/2020

Step	percent	Apprentice Base Wage	Health	Pension	Supplemental Unemployment	Total Rate
1	65	\$29.97	\$7.07	\$11.69	\$0.00	\$48.73
2	65	\$29.97	\$7.07	\$11.69	\$0.00	\$48.73
3	70	\$32.27	\$7.07	\$12.59	\$0.00	\$51.93
4	75	\$34.58	\$7.07	\$13.49	\$0.00	\$55.14
5	80	\$36.88	\$7.07	\$14.38	\$0.00	\$58.33
6	85	\$39.19	\$7.07	\$15.29	\$0.00	\$61.55
7	90	\$41.49	\$7.07	\$16.18	\$0.00	\$64.74
8	95	\$43.80	\$7.07	\$17.09	\$0.00	\$67.96

Notes:

Apprentice to Journeyworker Ratio:1:4

Classification	Effective Date	Base Wage	Health	Pension	Supplemental Unemployment	Total Rate
BRICK/STONE/ARTIFICIAL MASONRY (INCL. MASONRY WATERPROOFING) <i>BRICKLAYERS LOCAL 3 (FOXBORO)</i>	08/01/2020	\$53.61	\$10.75	\$21.45	\$0.00	\$85.81
	02/01/2021	\$54.21	\$10.75	\$21.45	\$0.00	\$86.41
	08/01/2021	\$55.61	\$10.75	\$21.61	\$0.00	\$87.97
	02/01/2022	\$56.19	\$10.75	\$21.61	\$0.00	\$88.55

Apprentice - BRICK/PLASTER/CEMENT MASON - Local 3 Foxboro

Effective Date - 08/01/2020

Step	percent	Apprentice Base Wage	Health	Pension	Supplemental Unemployment	Total Rate
1	50	\$26.81	\$10.75	\$21.45	\$0.00	\$59.01
2	60	\$32.17	\$10.75	\$21.45	\$0.00	\$64.37
3	70	\$37.53	\$10.75	\$21.45	\$0.00	\$69.73
4	80	\$42.89	\$10.75	\$21.45	\$0.00	\$75.09
5	90	\$48.25	\$10.75	\$21.45	\$0.00	\$80.45

Effective Date - 02/01/2021

Step	percent	Apprentice Base Wage	Health	Pension	Supplemental Unemployment	Total Rate
1	50	\$27.11	\$10.75	\$21.45	\$0.00	\$59.31
2	60	\$32.53	\$10.75	\$21.45	\$0.00	\$64.73
3	70	\$37.95	\$10.75	\$21.45	\$0.00	\$70.15
4	80	\$43.37	\$10.75	\$21.45	\$0.00	\$75.57
5	90	\$48.79	\$10.75	\$21.45	\$0.00	\$80.99

Notes:

Apprentice to Journeyworker Ratio:1:5

BULLDOZER/GRADER/SCRAPER <i>OPERATING ENGINEERS LOCAL 4</i>	12/01/2020	\$49.45	\$13.50	\$15.70	\$0.00	\$78.65
	06/01/2021	\$50.54	\$13.50	\$15.70	\$0.00	\$79.74
	12/01/2021	\$51.68	\$13.50	\$15.70	\$0.00	\$80.88

For apprentice rates see "Apprentice- OPERATING ENGINEERS"

CAISSON & UNDERPINNING BOTTOM MAN <i>LABORERS - FOUNDATION AND MARINE</i>	12/01/2020	\$41.05	\$8.60	\$17.47	\$0.00	\$67.12
	06/01/2021	\$42.07	\$8.60	\$17.47	\$0.00	\$68.14
	12/01/2021	\$43.08	\$8.60	\$17.47	\$0.00	\$69.15

For apprentice rates see "Apprentice- LABORER"

CAISSON & UNDERPINNING LABORER <i>LABORERS - FOUNDATION AND MARINE</i>	12/01/2020	\$39.90	\$8.60	\$17.47	\$0.00	\$65.97
	06/01/2021	\$40.92	\$8.60	\$17.47	\$0.00	\$66.99
	12/01/2021	\$41.93	\$8.60	\$17.47	\$0.00	\$68.00

For apprentice rates see "Apprentice- LABORER"

CAISSON & UNDERPINNING TOP MAN <i>LABORERS - FOUNDATION AND MARINE</i>	12/01/2020	\$39.90	\$8.60	\$17.47	\$0.00	\$65.97
	06/01/2021	\$40.92	\$8.60	\$17.47	\$0.00	\$66.99
	12/01/2021	\$41.93	\$8.60	\$17.47	\$0.00	\$68.00

For apprentice rates see "Apprentice- LABORER"

Classification	Effective Date	Base Wage	Health	Pension	Supplemental Unemployment	Total Rate
CARBIDE CORE DRILL OPERATOR <i>LABORERS - ZONE 1</i>	12/01/2020	\$40.15	\$8.60	\$17.32	\$0.00	\$66.07
	06/01/2021	\$41.17	\$8.60	\$17.32	\$0.00	\$67.09
	12/01/2021	\$42.18	\$8.60	\$17.32	\$0.00	\$68.10
	06/01/2022	\$43.18	\$8.60	\$17.32	\$0.00	\$69.10
	12/01/2022	\$44.18	\$8.60	\$17.32	\$0.00	\$70.10
	06/01/2023	\$45.18	\$8.60	\$17.32	\$0.00	\$71.10
	12/01/2023	\$46.43	\$8.60	\$17.32	\$0.00	\$72.35

For apprentice rates see "Apprentice- LABORER"

CARPENTER <i>CARPENTERS -ZONE 1 (Metro Boston)</i>	09/01/2020	\$51.53	\$9.40	\$18.95	\$0.00	\$79.88
	03/01/2021	\$52.38	\$9.40	\$18.95	\$0.00	\$80.73
	09/01/2021	\$53.28	\$9.40	\$18.95	\$0.00	\$81.63
	03/01/2022	\$54.13	\$9.40	\$18.95	\$0.00	\$82.48
	09/01/2022	\$55.03	\$9.40	\$18.95	\$0.00	\$83.38
	03/01/2023	\$55.88	\$9.40	\$18.95	\$0.00	\$84.23

Apprentice - CARPENTER - Zone 1 Metro Boston

Effective Date - 09/01/2020

Step	percent	Apprentice Base Wage	Health	Pension	Supplemental Unemployment	Total Rate
1	50	\$25.77	\$9.40	\$1.73	\$0.00	\$36.90
2	60	\$30.92	\$9.40	\$1.73	\$0.00	\$42.05
3	70	\$36.07	\$9.40	\$13.76	\$0.00	\$59.23
4	75	\$38.65	\$9.40	\$13.76	\$0.00	\$61.81
5	80	\$41.22	\$9.40	\$15.49	\$0.00	\$66.11
6	80	\$41.22	\$9.40	\$15.49	\$0.00	\$66.11
7	90	\$46.38	\$9.40	\$17.22	\$0.00	\$73.00
8	90	\$46.38	\$9.40	\$17.22	\$0.00	\$73.00

Effective Date - 03/01/2021

Step	percent	Apprentice Base Wage	Health	Pension	Supplemental Unemployment	Total Rate
1	50	\$26.19	\$9.40	\$1.73	\$0.00	\$37.32
2	60	\$31.43	\$9.40	\$1.73	\$0.00	\$42.56
3	70	\$36.67	\$9.40	\$13.76	\$0.00	\$59.83
4	75	\$39.29	\$9.40	\$13.76	\$0.00	\$62.45
5	80	\$41.90	\$9.40	\$15.49	\$0.00	\$66.79
6	80	\$41.90	\$9.40	\$15.49	\$0.00	\$66.79
7	90	\$47.14	\$9.40	\$17.22	\$0.00	\$73.76
8	90	\$47.14	\$9.40	\$17.22	\$0.00	\$73.76

Notes:

% Indentured After 10/1/17; 45/45/55/55/70/70/80/80
Step 1&2 \$34.32/ 3&4 \$41.14/ 5&6 \$60.96/ 7&8 \$67.84

Apprentice to Journeyworker Ratio:1:5

CARPENTER WOOD FRAME <i>CARPENTERS -ZONE 2 (Wood Frame)</i>	04/01/2020	\$27.12	\$7.21	\$5.80	\$0.00	\$40.13
	04/01/2021	\$27.87	\$7.21	\$5.80	\$0.00	\$40.88
	04/01/2022	\$28.62	\$7.21	\$5.80	\$0.00	\$41.63
	04/01/2023	\$28.97	\$7.21	\$5.80	\$0.00	\$41.98

Classification

All Aspects of New Wood Frame Work

Effective Date Base Wage Health Pension Supplemental Unemployment Total Rate

Apprentice - CARPENTER (Wood Frame) - Zone 2

Effective Date - 04/01/2020

Step	percent	Apprentice Base Wage	Health	Pension	Supplemental Unemployment	Total Rate
1	60	\$16.27	\$7.21	\$0.00	\$0.00	\$23.48
2	60	\$16.27	\$7.21	\$0.00	\$0.00	\$23.48
3	65	\$17.63	\$7.21	\$2.00	\$0.00	\$26.84
4	70	\$18.98	\$7.21	\$2.00	\$0.00	\$28.19
5	75	\$20.34	\$7.21	\$5.80	\$0.00	\$33.35
6	80	\$21.70	\$7.21	\$5.80	\$0.00	\$34.71
7	85	\$23.05	\$7.21	\$5.80	\$0.00	\$36.06
8	90	\$24.41	\$7.21	\$5.80	\$0.00	\$37.42

Effective Date - 04/01/2021

Step	percent	Apprentice Base Wage	Health	Pension	Supplemental Unemployment	Total Rate
1	60	\$16.72	\$7.21	\$0.00	\$0.00	\$23.93
2	60	\$16.72	\$7.21	\$0.00	\$0.00	\$23.93
3	65	\$18.12	\$7.21	\$2.00	\$0.00	\$27.33
4	70	\$19.51	\$7.21	\$2.00	\$0.00	\$28.72
5	75	\$20.90	\$7.21	\$5.80	\$0.00	\$33.91
6	80	\$22.30	\$7.21	\$5.80	\$0.00	\$35.31
7	85	\$23.69	\$7.21	\$5.80	\$0.00	\$36.70
8	90	\$25.08	\$7.21	\$5.80	\$0.00	\$38.09

Notes:

% Indentured After 10/1/17; 45/45/55/55/70/70/80/80
 Step 1&2 \$19.41/ 3&4 \$24.13/ 5&6 \$31.99/ 7&8 \$34.71

Apprentice to Journeyworker Ratio:1:5

CEMENT MASONRY/PLASTERING BRICKLAYERS LOCAL 3 (FOXBORO)	01/01/2020	\$44.67	\$12.75	\$22.41	\$0.62	\$80.45
--	------------	---------	---------	---------	--------	---------

Apprentice - CEMENT MASONRY/PLASTERING - Foxboro

Effective Date - 01/01/2020

Step	percent	Apprentice Base Wage	Health	Pension	Supplemental Unemployment	Total Rate
1	50	\$22.34	\$12.75	\$15.41	\$0.00	\$50.50
2	60	\$26.80	\$12.75	\$17.41	\$0.62	\$57.58
3	65	\$29.04	\$12.75	\$18.41	\$0.62	\$60.82
4	70	\$31.27	\$12.75	\$19.41	\$0.62	\$64.05
5	75	\$33.50	\$12.75	\$20.41	\$0.62	\$67.28
6	80	\$35.74	\$12.75	\$21.41	\$0.62	\$70.52
7	90	\$40.20	\$12.75	\$22.41	\$0.62	\$75.98

Notes:
Steps 3,4 are 500 hrs. All other steps are 1,000 hrs.

Apprentice to Journeyworker Ratio:1:3

CHAIN SAW OPERATOR <i>LABORERS - ZONE 1</i>	12/01/2020	\$40.15	\$8.60	\$17.32	\$0.00	\$66.07
	06/01/2021	\$41.17	\$8.60	\$17.32	\$0.00	\$67.09
	12/01/2021	\$42.18	\$8.60	\$17.32	\$0.00	\$68.10
	06/01/2022	\$43.18	\$8.60	\$17.32	\$0.00	\$69.10
	12/01/2022	\$44.18	\$8.60	\$17.32	\$0.00	\$70.10
	06/01/2023	\$45.18	\$8.60	\$17.32	\$0.00	\$71.10
	12/01/2023	\$46.43	\$8.60	\$17.32	\$0.00	\$72.35
For apprentice rates see "Apprentice- LABORER"						
CLAM SHELLS/SLURRY BUCKETS/HEADING MACHINES <i>OPERATING ENGINEERS LOCAL 4</i>	12/01/2020	\$50.98	\$13.50	\$15.70	\$0.00	\$80.18
	06/01/2021	\$52.08	\$13.50	\$15.70	\$0.00	\$81.28
	12/01/2021	\$53.23	\$13.50	\$15.70	\$0.00	\$82.43
For apprentice rates see "Apprentice- OPERATING ENGINEERS"						
COMPRESSOR OPERATOR <i>OPERATING ENGINEERS LOCAL 4</i>	12/01/2020	\$33.00	\$13.50	\$15.70	\$0.00	\$62.20
	06/01/2021	\$33.75	\$13.50	\$15.70	\$0.00	\$62.95
	12/01/2021	\$34.54	\$13.50	\$15.70	\$0.00	\$63.74
For apprentice rates see "Apprentice- OPERATING ENGINEERS"						
DELEADER (BRIDGE) <i>PAINTERS LOCAL 35 - ZONE 1</i>	01/01/2021	\$52.06	\$8.25	\$22.75	\$0.00	\$83.06

Classification

Effective Date Base Wage Health Pension Supplemental Unemployment Total Rate

Apprentice - PAINTER Local 35 - BRIDGES/TANKS

Effective Date - 01/01/2021

Step	percent	Apprentice Base Wage	Health	Pension	Supplemental Unemployment	Total Rate
1	50	\$26.03	\$8.25	\$0.00	\$0.00	\$34.28
2	55	\$28.63	\$8.25	\$6.16	\$0.00	\$43.04
3	60	\$31.24	\$8.25	\$6.72	\$0.00	\$46.21
4	65	\$33.84	\$8.25	\$7.28	\$0.00	\$49.37
5	70	\$36.44	\$8.25	\$19.39	\$0.00	\$64.08
6	75	\$39.05	\$8.25	\$19.95	\$0.00	\$67.25
7	80	\$41.65	\$8.25	\$20.51	\$0.00	\$70.41
8	90	\$46.85	\$8.25	\$21.63	\$0.00	\$76.73

Notes:

Steps are 750 hrs.

Apprentice to Journeyworker Ratio:1:1

DEMO: ADZEMAN LABORERS - ZONE 1	12/01/2020	\$40.05	\$8.60	\$17.32	\$0.00	\$65.97
	06/01/2021	\$41.07	\$8.60	\$17.32	\$0.00	\$66.99
	12/01/2021	\$42.08	\$8.60	\$17.32	\$0.00	\$68.00
	06/01/2022	\$43.08	\$8.60	\$17.32	\$0.00	\$69.00
	12/01/2022	\$44.08	\$8.60	\$17.32	\$0.00	\$70.00
	06/01/2023	\$45.08	\$8.60	\$17.32	\$0.00	\$71.00
	12/01/2023	\$46.33	\$8.60	\$17.32	\$0.00	\$72.25

For apprentice rates see "Apprentice- LABORER"

DEMO: BACKHOE/LOADER/HAMMER OPERATOR LABORERS - ZONE 1	12/01/2020	\$41.05	\$8.60	\$17.32	\$0.00	\$66.97
	06/01/2021	\$42.07	\$8.60	\$17.32	\$0.00	\$67.99
	12/01/2021	\$43.08	\$8.60	\$17.32	\$0.00	\$69.00
	06/01/2022	\$44.08	\$8.60	\$17.32	\$0.00	\$70.00
	12/01/2022	\$45.08	\$8.60	\$17.32	\$0.00	\$71.00
	06/01/2023	\$46.08	\$8.60	\$17.32	\$0.00	\$72.00
	12/01/2023	\$47.33	\$8.60	\$17.32	\$0.00	\$73.25

For apprentice rates see "Apprentice- LABORER"

DEMO: BURNERS LABORERS - ZONE 1	12/01/2020	\$40.80	\$8.60	\$17.32	\$0.00	\$66.72
	06/01/2021	\$41.82	\$8.60	\$17.32	\$0.00	\$67.74
	12/01/2021	\$42.83	\$8.60	\$17.32	\$0.00	\$68.75
	06/01/2022	\$43.83	\$8.60	\$17.32	\$0.00	\$69.75
	12/01/2022	\$44.83	\$8.60	\$17.32	\$0.00	\$70.75
	06/01/2023	\$45.83	\$8.60	\$17.32	\$0.00	\$71.75
	12/01/2023	\$47.08	\$8.60	\$17.32	\$0.00	\$73.00

For apprentice rates see "Apprentice- LABORER"

Classification	Effective Date	Base Wage	Health	Pension	Supplemental Unemployment	Total Rate
DEMO: CONCRETE CUTTER/SAWYER <i>LABORERS - ZONE 1</i>	12/01/2020	\$41.05	\$8.60	\$17.32	\$0.00	\$66.97
	06/01/2021	\$42.07	\$8.60	\$17.32	\$0.00	\$67.99
	12/01/2021	\$43.08	\$8.60	\$17.32	\$0.00	\$69.00
	06/01/2022	\$44.08	\$8.60	\$17.32	\$0.00	\$70.00
	12/01/2022	\$45.08	\$8.60	\$17.32	\$0.00	\$71.00
	06/01/2023	\$46.08	\$8.60	\$17.32	\$0.00	\$72.00
	12/01/2023	\$47.33	\$8.60	\$17.32	\$0.00	\$73.25
For apprentice rates see "Apprentice- LABORER"						
DEMO: JACKHAMMER OPERATOR <i>LABORERS - ZONE 1</i>	12/01/2020	\$40.80	\$8.60	\$17.32	\$0.00	\$66.72
	06/01/2021	\$41.82	\$8.60	\$17.32	\$0.00	\$67.74
	12/01/2021	\$42.83	\$8.60	\$17.32	\$0.00	\$68.75
	06/01/2022	\$43.83	\$8.60	\$17.32	\$0.00	\$69.75
	12/01/2022	\$44.83	\$8.60	\$17.32	\$0.00	\$70.75
	06/01/2023	\$45.83	\$8.60	\$17.32	\$0.00	\$71.75
	12/01/2023	\$47.08	\$8.60	\$17.32	\$0.00	\$73.00
For apprentice rates see "Apprentice- LABORER"						
DEMO: WRECKING LABORER <i>LABORERS - ZONE 1</i>	12/01/2020	\$40.05	\$8.60	\$17.32	\$0.00	\$65.97
	06/01/2021	\$41.07	\$8.60	\$17.32	\$0.00	\$66.99
	12/01/2021	\$42.08	\$8.60	\$17.32	\$0.00	\$68.00
	06/01/2022	\$43.08	\$8.60	\$17.32	\$0.00	\$69.00
	12/01/2022	\$44.08	\$8.60	\$17.32	\$0.00	\$70.00
	06/01/2023	\$45.08	\$8.60	\$17.32	\$0.00	\$71.00
	12/01/2023	\$46.33	\$8.60	\$17.32	\$0.00	\$72.25
For apprentice rates see "Apprentice- LABORER"						
DIRECTIONAL DRILL MACHINE OPERATOR <i>OPERATING ENGINEERS LOCAL 4</i>	12/01/2020	\$49.45	\$13.50	\$15.70	\$0.00	\$78.65
	06/01/2021	\$50.54	\$13.50	\$15.70	\$0.00	\$79.74
	12/01/2021	\$51.68	\$13.50	\$15.70	\$0.00	\$80.88
For apprentice rates see "Apprentice- OPERATING ENGINEERS"						
DIVER <i>PILE DRIVER LOCAL 56 (ZONE 1)</i>	08/01/2020	\$68.70	\$9.40	\$23.12	\$0.00	\$101.22
For apprentice rates see "Apprentice- PILE DRIVER"						
DIVER TENDER <i>PILE DRIVER LOCAL 56 (ZONE 1)</i>	08/01/2020	\$49.07	\$9.40	\$23.12	\$0.00	\$81.59
For apprentice rates see "Apprentice- PILE DRIVER"						
DIVER TENDER (EFFLUENT) <i>PILE DRIVER LOCAL 56 (ZONE 1)</i>	08/01/2020	\$73.60	\$9.40	\$23.12	\$0.00	\$106.12
For apprentice rates see "Apprentice- PILE DRIVER"						
DIVER/SLURRY (EFFLUENT) <i>PILE DRIVER LOCAL 56 (ZONE 1)</i>	08/01/2020	\$103.05	\$9.40	\$23.12	\$0.00	\$135.57
For apprentice rates see "Apprentice- PILE DRIVER"						
DRAWBRIDGE OPERATOR (Construction) <i>DRAWBRIDGE - SEIU LOCAL 888</i>	07/01/2020	\$26.77	\$6.67	\$3.93	\$0.16	\$37.53
ELECTRICIAN <i>ELECTRICIANS LOCAL 103</i>	09/01/2020	\$54.45	\$13.00	\$19.73	\$0.00	\$87.18
	03/01/2021	\$55.41	\$13.00	\$20.01	\$0.00	\$88.42
	09/01/2021	\$56.84	\$13.00	\$20.06	\$0.00	\$89.90
	03/01/2022	\$58.04	\$13.00	\$20.09	\$0.00	\$91.13
	09/01/2022	\$59.48	\$13.00	\$20.13	\$0.00	\$92.61
	03/01/2023	\$60.67	\$13.00	\$20.17	\$0.00	\$93.84

Classification

Effective Date Base Wage Health Pension Supplemental Unemployment Total Rate

Apprentice - ELECTRICIAN - Local 103

Effective Date - 09/01/2020

Step	percent	Apprentice Base Wage	Health	Pension	Supplemental Unemployment	Total Rate
1	40	\$21.78	\$13.00	\$0.65	\$0.00	\$35.43
2	40	\$21.78	\$13.00	\$0.65	\$0.00	\$35.43
3	45	\$24.50	\$13.00	\$14.87	\$0.00	\$52.37
4	45	\$24.50	\$13.00	\$14.87	\$0.00	\$52.37
5	50	\$27.23	\$13.00	\$15.31	\$0.00	\$55.54
6	55	\$29.95	\$13.00	\$15.75	\$0.00	\$58.70
7	60	\$32.67	\$13.00	\$16.19	\$0.00	\$61.86
8	65	\$35.39	\$13.00	\$16.63	\$0.00	\$65.02
9	70	\$38.12	\$13.00	\$17.07	\$0.00	\$68.19
10	75	\$40.84	\$13.00	\$17.53	\$0.00	\$71.37

Effective Date - 03/01/2021

Step	percent	Apprentice Base Wage	Health	Pension	Supplemental Unemployment	Total Rate
1	40	\$22.16	\$13.00	\$0.66	\$0.00	\$35.82
2	40	\$22.16	\$13.00	\$0.66	\$0.00	\$35.82
3	45	\$24.93	\$13.00	\$15.13	\$0.00	\$53.06
4	45	\$24.93	\$13.00	\$15.13	\$0.00	\$53.06
5	50	\$27.71	\$13.00	\$15.57	\$0.00	\$56.28
6	55	\$30.48	\$13.00	\$16.01	\$0.00	\$59.49
7	60	\$33.25	\$13.00	\$16.46	\$0.00	\$62.71
8	65	\$36.02	\$13.00	\$16.90	\$0.00	\$65.92
9	70	\$38.79	\$13.00	\$17.34	\$0.00	\$69.13
10	75	\$41.56	\$13.00	\$17.80	\$0.00	\$72.36

Notes :

App Prior 1/1/03; 30/35/40/45/50/55/65/70/75/80

Apprentice to Journeyworker Ratio:2:3***

ELEVATOR CONSTRUCTOR	01/01/2021	\$63.47	\$15.88	\$19.31	\$0.00	\$98.66
ELEVATOR CONSTRUCTORS LOCAL 4	01/01/2022	\$65.62	\$16.03	\$20.21	\$0.00	\$101.86

Apprentice - ELEVATOR CONSTRUCTOR - Local 4

Effective Date - 01/01/2021

Step	percent	Apprentice Base Wage	Health	Pension	Supplemental Unemployment	Total Rate
1	50	\$31.74	\$15.88	\$0.00	\$0.00	\$47.62
2	55	\$34.91	\$15.88	\$19.31	\$0.00	\$70.10
3	65	\$41.26	\$15.88	\$19.31	\$0.00	\$76.45
4	70	\$44.43	\$15.88	\$19.31	\$0.00	\$79.62
5	80	\$50.78	\$15.88	\$19.31	\$0.00	\$85.97

Effective Date - 01/01/2022

Step	percent	Apprentice Base Wage	Health	Pension	Supplemental Unemployment	Total Rate
1	50	\$32.81	\$16.03	\$0.00	\$0.00	\$48.84
2	55	\$36.09	\$16.03	\$20.21	\$0.00	\$72.33
3	65	\$42.65	\$16.03	\$20.21	\$0.00	\$78.89
4	70	\$45.93	\$16.03	\$20.21	\$0.00	\$82.17
5	80	\$52.50	\$16.03	\$20.21	\$0.00	\$88.74

Notes:

Steps 1-2 are 6 mos.; Steps 3-5 are 1 year

Apprentice to Journeyworker Ratio:1:1

ELEVATOR CONSTRUCTOR HELPER	01/01/2021	\$44.43	\$15.88	\$19.31	\$0.00	\$79.62
<i>ELEVATOR CONSTRUCTORS LOCAL 4</i>	01/01/2022	\$45.93	\$16.03	\$20.21	\$0.00	\$82.17

For apprentice rates see "Apprentice - ELEVATOR CONSTRUCTOR"

FENCE & GUARD RAIL ERECTOR	12/01/2020	\$40.15	\$8.60	\$17.32	\$0.00	\$66.07
<i>LABORERS - ZONE 1</i>	06/01/2021	\$41.17	\$8.60	\$17.32	\$0.00	\$67.09
	12/01/2021	\$42.18	\$8.60	\$17.32	\$0.00	\$68.10
	06/01/2022	\$43.18	\$8.60	\$17.32	\$0.00	\$69.10
	12/01/2022	\$44.18	\$8.60	\$17.32	\$0.00	\$70.10
	06/01/2023	\$45.18	\$8.60	\$17.32	\$0.00	\$71.10
	12/01/2023	\$46.43	\$8.60	\$17.32	\$0.00	\$72.35

For apprentice rates see "Apprentice- LABORER"

FENCE & GUARD RAIL ERECTOR (HEAVY & HIGHWAY)	12/01/2020	\$40.15	\$8.60	\$17.32	\$0.00	\$66.07
<i>LABORERS - ZONE 1 (HEAVY & HIGHWAY)</i>	06/01/2021	\$41.17	\$8.60	\$17.32	\$0.00	\$67.09
	12/01/2021	\$42.18	\$8.60	\$17.32	\$0.00	\$68.10

For apprentice rates see "Apprentice- LABORER (Heavy and Highway)"

FIELD ENG.INST.PERSON-BLDG,SITE,HVY/HWY	11/01/2020	\$45.23	\$13.00	\$15.70	\$0.00	\$73.93
<i>OPERATING ENGINEERS LOCAL 4</i>	05/01/2021	\$46.38	\$13.00	\$15.70	\$0.00	\$75.08
	11/01/2021	\$47.38	\$13.00	\$15.70	\$0.00	\$76.08
	05/01/2022	\$48.53	\$13.00	\$15.70	\$0.00	\$77.23

For apprentice rates see "Apprentice- OPERATING ENGINEERS"

FIELD ENG.PARTY CHIEF-BLDG,SITE,HVY/HWY	11/01/2020	\$46.74	\$13.00	\$15.70	\$0.00	\$75.44
<i>OPERATING ENGINEERS LOCAL 4</i>	05/01/2021	\$47.90	\$13.00	\$15.70	\$0.00	\$76.60
	11/01/2021	\$48.91	\$13.00	\$15.70	\$0.00	\$77.61
	05/01/2022	\$50.07	\$13.00	\$15.70	\$0.00	\$78.77

For apprentice rates see "Apprentice- OPERATING ENGINEERS"

Classification	Effective Date	Base Wage	Health	Pension	Supplemental Unemployment	Total Rate
FIELD ENG.ROD PERSON-BLDG,SITE,HVY/HWY <i>OPERATING ENGINEERS LOCAL 4</i>	11/01/2020	\$22.73	\$13.00	\$15.70	\$0.00	\$51.43
	05/01/2021	\$23.41	\$13.00	\$15.70	\$0.00	\$52.11
	11/01/2021	\$24.01	\$13.00	\$15.70	\$0.00	\$52.71
	05/01/2022	\$24.68	\$13.00	\$15.70	\$0.00	\$53.38
For apprentice rates see "Apprentice- OPERATING ENGINEERS"						
FIRE ALARM INSTALLER <i>ELECTRICIANS LOCAL 103</i>	09/01/2020	\$54.45	\$13.00	\$19.73	\$0.00	\$87.18
	03/01/2021	\$55.41	\$13.00	\$20.01	\$0.00	\$88.42
	09/01/2021	\$56.84	\$13.00	\$20.06	\$0.00	\$89.90
	03/01/2022	\$58.04	\$13.00	\$20.09	\$0.00	\$91.13
	09/01/2022	\$59.48	\$13.00	\$20.13	\$0.00	\$92.61
	03/01/2023	\$60.67	\$13.00	\$20.17	\$0.00	\$93.84
For apprentice rates see "Apprentice- ELECTRICIAN"						
FIRE ALARM REPAIR / MAINTENANCE / COMMISSIONING <i>ELECTRICIANS LOCAL 103</i>	09/01/2020	\$40.84	\$13.00	\$17.53	\$0.00	\$71.37
	03/01/2021	\$42.11	\$13.00	\$17.88	\$0.00	\$72.99
	09/01/2021	\$43.77	\$13.00	\$18.00	\$0.00	\$74.77
	03/01/2022	\$45.27	\$13.00	\$18.12	\$0.00	\$76.39
	09/01/2022	\$46.99	\$13.00	\$18.24	\$0.00	\$78.23
	03/01/2023	\$48.54	\$13.00	\$18.37	\$0.00	\$79.91
For apprentice rates see "Apprentice- TELECOMMUNICATIONS TECHNICIAN"						
FIREMAN (ASST. ENGINEER) <i>OPERATING ENGINEERS LOCAL 4</i>	12/01/2020	\$40.75	\$13.50	\$15.70	\$0.00	\$69.95
	06/01/2021	\$41.66	\$13.50	\$15.70	\$0.00	\$70.86
	12/01/2021	\$42.61	\$13.50	\$15.70	\$0.00	\$71.81
For apprentice rates see "Apprentice- OPERATING ENGINEERS"						
FLAGGER & SIGNALER (HEAVY & HIGHWAY) <i>LABORERS - ZONE 1 (HEAVY & HIGHWAY)</i>	12/01/2020	\$24.50	\$8.60	\$17.32	\$0.00	\$50.42
	06/01/2021	\$24.50	\$8.60	\$17.32	\$0.00	\$50.42
	12/01/2021	\$24.50	\$8.60	\$17.32	\$0.00	\$50.42
For apprentice rates see "Apprentice- LABORER (Heavy and Highway)"						
FLOORCOVERER <i>FLOORCOVERERS LOCAL 2168 ZONE 1</i>	09/01/2020	\$47.79	\$9.40	\$19.25	\$0.00	\$76.44
	03/01/2021	\$48.59	\$9.40	\$19.25	\$0.00	\$77.24
	09/01/2021	\$49.39	\$9.40	\$19.25	\$0.00	\$78.04
	03/01/2022	\$50.19	\$9.40	\$19.25	\$0.00	\$78.84

Classification

Effective Date Base Wage Health Pension Supplemental Unemployment Total Rate

Apprentice - FLOORCOVERER - Local 2168 Zone I

Effective Date - 09/01/2020

Step	percent	Apprentice Base Wage	Health	Pension	Supplemental Unemployment	Total Rate
1	50	\$23.90	\$9.40	\$1.79	\$0.00	\$35.09
2	55	\$26.28	\$9.40	\$1.79	\$0.00	\$37.47
3	60	\$28.67	\$9.40	\$13.88	\$0.00	\$51.95
4	65	\$31.06	\$9.40	\$13.88	\$0.00	\$54.34
5	70	\$33.45	\$9.40	\$15.67	\$0.00	\$58.52
6	75	\$35.84	\$9.40	\$15.67	\$0.00	\$60.91
7	80	\$38.23	\$9.40	\$17.46	\$0.00	\$65.09
8	85	\$40.62	\$9.40	\$17.46	\$0.00	\$67.48

Effective Date - 03/01/2021

Step	percent	Apprentice Base Wage	Health	Pension	Supplemental Unemployment	Total Rate
1	50	\$24.30	\$9.40	\$1.79	\$0.00	\$35.49
2	55	\$26.72	\$9.40	\$1.79	\$0.00	\$37.91
3	60	\$29.15	\$9.40	\$13.88	\$0.00	\$52.43
4	65	\$31.58	\$9.40	\$13.88	\$0.00	\$54.86
5	70	\$34.01	\$9.40	\$15.67	\$0.00	\$59.08
6	75	\$36.44	\$9.40	\$15.67	\$0.00	\$61.51
7	80	\$38.87	\$9.40	\$17.46	\$0.00	\$65.73
8	85	\$41.30	\$9.40	\$17.46	\$0.00	\$68.16

Notes: Steps are 750 hrs.
 % After 09/1/17; 45/45/55/55/70/70/80/80 (1500hr Steps)
 Step 1&2 \$32.70/ 3&4 \$39.20/ 5&6 \$58.52/ 7&8 \$65.09

Apprentice to Journeyworker Ratio:1:1

FORK LIFT/CHERRY PICKER OPERATING ENGINEERS LOCAL 4	12/01/2020	\$49.98	\$13.50	\$15.70	\$0.00	\$79.18
	06/01/2021	\$51.08	\$13.50	\$15.70	\$0.00	\$80.28
	12/01/2021	\$52.23	\$13.50	\$15.70	\$0.00	\$81.43

For apprentice rates see "Apprentice- OPERATING ENGINEERS"

GENERATOR/LIGHTING PLANT/HEATERS OPERATING ENGINEERS LOCAL 4	12/01/2020	\$33.00	\$13.50	\$15.70	\$0.00	\$62.20
	06/01/2021	\$33.75	\$13.50	\$15.70	\$0.00	\$62.95
	12/01/2021	\$34.54	\$13.50	\$15.70	\$0.00	\$63.74

For apprentice rates see "Apprentice- OPERATING ENGINEERS"

GLAZIER (GLASS PLANK/AIR BARRIER/INTERIOR SYSTEMS) GLAZIERS LOCAL 35 (ZONE 1)	01/01/2021	\$47.35	\$8.25	\$22.75	\$0.00	\$78.35
--	------------	---------	--------	---------	--------	---------

Classification

Effective Date Base Wage Health Pension Supplemental Unemployment Total Rate

Apprentice - GLAZIER - Local 35 Zone 1

Effective Date - 01/01/2021

Step	percent	Apprentice Base Wage	Health	Pension	Supplemental Unemployment	Total Rate
1	50	\$23.68	\$8.25	\$0.00	\$0.00	\$31.93
2	55	\$26.04	\$8.25	\$6.16	\$0.00	\$40.45
3	60	\$28.41	\$8.25	\$6.72	\$0.00	\$43.38
4	65	\$30.78	\$8.25	\$7.28	\$0.00	\$46.31
5	70	\$33.15	\$8.25	\$19.39	\$0.00	\$60.79
6	75	\$35.51	\$8.25	\$19.95	\$0.00	\$63.71
7	80	\$37.88	\$8.25	\$20.51	\$0.00	\$66.64
8	90	\$42.62	\$8.25	\$21.63	\$0.00	\$72.50

Notes:
Steps are 750 hrs.

Apprentice to Journeyworker Ratio:1:1

HOISTING ENGINEER/CRANES/GRADALLS	12/01/2020	\$49.98	\$13.50	\$15.70	\$0.00	\$79.18
OPERATING ENGINEERS LOCAL 4	06/01/2021	\$51.08	\$13.50	\$15.70	\$0.00	\$80.28
	12/01/2021	\$52.23	\$13.50	\$15.70	\$0.00	\$81.43

Classification

Effective Date Base Wage Health Pension Supplemental Unemployment Total Rate

Apprentice - OPERATING ENGINEERS - Local 4

Effective Date - 12/01/2020

Step	percent	Apprentice Base Wage	Health	Pension	Supplemental Unemployment	Total Rate
1	55	\$27.49	\$13.50	\$0.00	\$0.00	\$40.99
2	60	\$29.99	\$13.50	\$15.70	\$0.00	\$59.19
3	65	\$32.49	\$13.50	\$15.70	\$0.00	\$61.69
4	70	\$34.99	\$13.50	\$15.70	\$0.00	\$64.19
5	75	\$37.49	\$13.50	\$15.70	\$0.00	\$66.69
6	80	\$39.98	\$13.50	\$15.70	\$0.00	\$69.18
7	85	\$42.48	\$13.50	\$15.70	\$0.00	\$71.68
8	90	\$44.98	\$13.50	\$15.70	\$0.00	\$74.18

Effective Date - 06/01/2021

Step	percent	Apprentice Base Wage	Health	Pension	Supplemental Unemployment	Total Rate
1	55	\$28.09	\$13.50	\$0.00	\$0.00	\$41.59
2	60	\$30.65	\$13.50	\$15.70	\$0.00	\$59.85
3	65	\$33.20	\$13.50	\$15.70	\$0.00	\$62.40
4	70	\$35.76	\$13.50	\$15.70	\$0.00	\$64.96
5	75	\$38.31	\$13.50	\$15.70	\$0.00	\$67.51
6	80	\$40.86	\$13.50	\$15.70	\$0.00	\$70.06
7	85	\$43.42	\$13.50	\$15.70	\$0.00	\$72.62
8	90	\$45.97	\$13.50	\$15.70	\$0.00	\$75.17

Notes:

Apprentice to Journeyworker Ratio:1:6

HVAC (DUCTWORK) SHEETMETAL WORKERS LOCAL 17 - A	08/01/2020	\$50.67	\$13.50	\$24.12	\$2.65	\$90.94
	02/01/2021	\$52.32	\$13.50	\$24.12	\$2.70	\$92.64
	08/01/2021	\$54.07	\$13.50	\$24.12	\$2.75	\$94.44
	02/01/2022	\$55.82	\$13.50	\$24.12	\$2.80	\$96.24

For apprentice rates see "Apprentice- SHEET METAL WORKER"

HVAC (ELECTRICAL CONTROLS) ELECTRICIANS LOCAL 103	09/01/2020	\$54.45	\$13.00	\$19.73	\$0.00	\$87.18
	03/01/2021	\$55.41	\$13.00	\$20.01	\$0.00	\$88.42
	09/01/2021	\$56.84	\$13.00	\$20.06	\$0.00	\$89.90
	03/01/2022	\$58.04	\$13.00	\$20.09	\$0.00	\$91.13
	09/01/2022	\$59.48	\$13.00	\$20.13	\$0.00	\$92.61
	03/01/2023	\$60.67	\$13.00	\$20.17	\$0.00	\$93.84

For apprentice rates see "Apprentice- ELECTRICIAN"

HVAC (TESTING AND BALANCING - AIR) SHEETMETAL WORKERS LOCAL 17 - A	08/01/2020	\$50.67	\$13.50	\$24.12	\$2.65	\$90.94
	02/01/2021	\$52.32	\$13.50	\$24.12	\$2.70	\$92.64
	08/01/2021	\$54.07	\$13.50	\$24.12	\$2.75	\$94.44
	02/01/2022	\$55.82	\$13.50	\$24.12	\$2.80	\$96.24

For apprentice rates see "Apprentice- SHEET METAL WORKER"

Classification	Effective Date	Base Wage	Health	Pension	Supplemental Unemployment	Total Rate
HVAC (TESTING AND BALANCING -WATER) <i>PIPEFITTERS LOCAL 537</i>	09/01/2020	\$56.44	\$11.70	\$20.24	\$0.00	\$88.38
	03/01/2021	\$57.94	\$11.70	\$20.24	\$0.00	\$89.88
For apprentice rates see "Apprentice- PIPEFITTER" or "PLUMBER/PIPEFITTER"						
HVAC MECHANIC <i>PIPEFITTERS LOCAL 537</i>	09/01/2020	\$56.44	\$11.70	\$20.24	\$0.00	\$88.38
	03/01/2021	\$57.94	\$11.70	\$20.24	\$0.00	\$89.88
For apprentice rates see "Apprentice- PIPEFITTER" or "PLUMBER/PIPEFITTER"						
HYDRAULIC DRILLS <i>LABORERS - ZONE 1</i>	12/01/2020	\$40.65	\$8.60	\$17.32	\$0.00	\$66.57
	06/01/2021	\$41.67	\$8.60	\$17.32	\$0.00	\$67.59
	12/01/2021	\$42.68	\$8.60	\$17.32	\$0.00	\$68.60
	06/01/2022	\$43.68	\$8.60	\$17.32	\$0.00	\$69.60
	12/01/2022	\$44.68	\$8.60	\$17.32	\$0.00	\$70.60
	06/01/2023	\$45.68	\$8.60	\$17.32	\$0.00	\$71.60
For apprentice rates see "Apprentice- LABORER"						
HYDRAULIC DRILLS (HEAVY & HIGHWAY) <i>LABORERS - ZONE 1 (HEAVY & HIGHWAY)</i>	12/01/2020	\$40.65	\$8.60	\$17.32	\$0.00	\$66.57
	06/01/2021	\$41.67	\$8.60	\$17.32	\$0.00	\$67.59
	12/01/2021	\$42.68	\$8.60	\$17.32	\$0.00	\$68.60
For apprentice rates see "Apprentice- LABORER (Heavy and Highway)"						
INSULATOR (PIPES & TANKS) <i>HEAT & FROST INSULATORS LOCAL 6 (BOSTON)</i>	09/01/2020	\$49.00	\$13.80	\$17.14	\$0.00	\$79.94
	09/01/2021	\$51.40	\$13.80	\$17.14	\$0.00	\$82.34
	09/01/2022	\$53.85	\$13.80	\$17.14	\$0.00	\$84.79

Apprentice - ASBESTOS INSULATOR (Pipes & Tanks) - Local 6 Boston

Effective Date - 09/01/2020

Step	percent	Apprentice Base Wage	Health	Pension	Supplemental Unemployment	Total Rate
1	50	\$24.50	\$13.80	\$12.42	\$0.00	\$50.72
2	60	\$29.40	\$13.80	\$13.36	\$0.00	\$56.56
3	70	\$34.30	\$13.80	\$14.31	\$0.00	\$62.41
4	80	\$39.20	\$13.80	\$15.25	\$0.00	\$68.25

Effective Date - 09/01/2021

Step	percent	Apprentice Base Wage	Health	Pension	Supplemental Unemployment	Total Rate
1	50	\$25.70	\$13.80	\$12.42	\$0.00	\$51.92
2	60	\$30.84	\$13.80	\$13.36	\$0.00	\$58.00
3	70	\$35.98	\$13.80	\$14.31	\$0.00	\$64.09
4	80	\$41.12	\$13.80	\$15.25	\$0.00	\$70.17

Notes:

Steps are 1 year

Apprentice to Journeyworker Ratio:1:4

IRONWORKER/WELDER <i>IRONWORKERS LOCAL 7 (BOSTON AREA)</i>	09/16/2020	\$48.66	\$8.10	\$25.10	\$0.00	\$81.86
---	------------	---------	--------	---------	--------	---------

Classification

Effective Date Base Wage Health Pension Supplemental Unemployment Total Rate

Apprentice - IRONWORKER - Local 7 Boston

Effective Date - 09/16/2020

Step	percent	Apprentice Base Wage	Health	Pension	Supplemental Unemployment	Total Rate
1	60	\$29.20	\$8.10	\$25.10	\$0.00	\$62.40
2	70	\$34.06	\$8.10	\$25.10	\$0.00	\$67.26
3	75	\$36.50	\$8.10	\$25.10	\$0.00	\$69.70
4	80	\$38.93	\$8.10	\$25.10	\$0.00	\$72.13
5	85	\$41.36	\$8.10	\$25.10	\$0.00	\$74.56
6	90	\$43.79	\$8.10	\$25.10	\$0.00	\$76.99

Notes:

** Structural 1:6; Ornamental 1:4

Apprentice to Journeyworker Ratio:**

JACKHAMMER & PAVING BREAKER OPERATOR LABORERS - ZONE 1	12/01/2020	\$40.15	\$8.60	\$17.32	\$0.00	\$66.07
	06/01/2021	\$41.17	\$8.60	\$17.32	\$0.00	\$67.09
	12/01/2021	\$42.18	\$8.60	\$17.32	\$0.00	\$68.10
	06/01/2022	\$43.18	\$8.60	\$17.32	\$0.00	\$69.10
	12/01/2022	\$44.18	\$8.60	\$17.32	\$0.00	\$70.10
	06/01/2023	\$45.18	\$8.60	\$17.32	\$0.00	\$71.10
	12/01/2023	\$46.43	\$8.60	\$17.32	\$0.00	\$72.35

For apprentice rates see "Apprentice- LABORER"

LABORER LABORERS - ZONE 1	12/01/2020	\$39.90	\$8.60	\$17.32	\$0.00	\$65.82
	06/01/2021	\$40.92	\$8.60	\$17.32	\$0.00	\$66.84
	12/01/2021	\$41.93	\$8.60	\$17.32	\$0.00	\$67.85
	06/01/2022	\$42.93	\$8.60	\$17.32	\$0.00	\$68.85
	12/01/2022	\$43.93	\$8.60	\$17.32	\$0.00	\$69.85
	06/01/2023	\$44.93	\$8.60	\$17.32	\$0.00	\$70.85
	12/01/2023	\$46.18	\$8.60	\$17.32	\$0.00	\$72.10

Classification

Effective Date Base Wage Health Pension Supplemental Unemployment Total Rate

Apprentice - LABORER - Zone 1

Effective Date - 12/01/2020

Step	percent	Apprentice Base Wage	Health	Pension	Supplemental Unemployment	Total Rate
1	60	\$23.94	\$8.60	\$17.32	\$0.00	\$49.86
2	70	\$27.93	\$8.60	\$17.32	\$0.00	\$53.85
3	80	\$31.92	\$8.60	\$17.32	\$0.00	\$57.84
4	90	\$35.91	\$8.60	\$17.32	\$0.00	\$61.83

Effective Date - 06/01/2021

Step	percent	Apprentice Base Wage	Health	Pension	Supplemental Unemployment	Total Rate
1	60	\$24.55	\$8.60	\$17.32	\$0.00	\$50.47
2	70	\$28.64	\$8.60	\$17.32	\$0.00	\$54.56
3	80	\$32.74	\$8.60	\$17.32	\$0.00	\$58.66
4	90	\$36.83	\$8.60	\$17.32	\$0.00	\$62.75

Notes:

Apprentice to Journeyworker Ratio:1:5

LABORER (HEAVY & HIGHWAY)	12/01/2020	\$39.90	\$8.60	\$17.32	\$0.00	\$65.82
LABORERS - ZONE 1 (HEAVY & HIGHWAY)	06/01/2021	\$40.92	\$8.60	\$17.32	\$0.00	\$66.84
	12/01/2021	\$41.93	\$8.60	\$17.32	\$0.00	\$67.85

Apprentice - LABORER (Heavy & Highway) - Zone 1

Effective Date - 12/01/2020

Step	percent	Apprentice Base Wage	Health	Pension	Supplemental Unemployment	Total Rate
1	60	\$23.94	\$8.60	\$17.32	\$0.00	\$49.86
2	70	\$27.93	\$8.60	\$17.32	\$0.00	\$53.85
3	80	\$31.92	\$8.60	\$17.32	\$0.00	\$57.84
4	90	\$35.91	\$8.60	\$17.32	\$0.00	\$61.83

Effective Date - 06/01/2021

Step	percent	Apprentice Base Wage	Health	Pension	Supplemental Unemployment	Total Rate
1	60	\$24.55	\$8.60	\$17.32	\$0.00	\$50.47
2	70	\$28.64	\$8.60	\$17.32	\$0.00	\$54.56
3	80	\$32.74	\$8.60	\$17.32	\$0.00	\$58.66
4	90	\$36.83	\$8.60	\$17.32	\$0.00	\$62.75

Notes:

Apprentice to Journeyworker Ratio:1:5

Classification	Effective Date	Base Wage	Health	Pension	Supplemental Unemployment	Total Rate
LABORER: CARPENTER TENDER <i>LABORERS - ZONE 1</i>	12/01/2020	\$39.90	\$8.60	\$17.32	\$0.00	\$65.82
	06/01/2021	\$40.92	\$8.60	\$17.32	\$0.00	\$66.84
	12/01/2021	\$41.93	\$8.60	\$17.32	\$0.00	\$67.85
	06/01/2022	\$42.93	\$8.60	\$17.32	\$0.00	\$68.85
	12/01/2022	\$43.93	\$8.60	\$17.32	\$0.00	\$69.85
	06/01/2023	\$44.93	\$8.60	\$17.32	\$0.00	\$70.85
	12/01/2023	\$46.18	\$8.60	\$17.32	\$0.00	\$72.10
For apprentice rates see "Apprentice- LABORER"						
LABORER: CEMENT FINISHER TENDER <i>LABORERS - ZONE 1</i>	12/01/2020	\$39.90	\$8.60	\$17.32	\$0.00	\$65.82
	06/01/2021	\$40.92	\$8.60	\$17.32	\$0.00	\$66.84
	12/01/2021	\$41.93	\$8.60	\$17.32	\$0.00	\$67.85
	06/01/2022	\$42.93	\$8.60	\$17.32	\$0.00	\$68.85
	12/01/2022	\$43.93	\$8.60	\$17.32	\$0.00	\$69.85
	06/01/2023	\$44.93	\$8.60	\$17.32	\$0.00	\$70.85
	12/01/2023	\$46.18	\$8.60	\$17.32	\$0.00	\$72.10
For apprentice rates see "Apprentice- LABORER"						
LABORER: HAZARDOUS WASTE/ASBESTOS REMOVER <i>LABORERS - ZONE 1</i>	12/01/2020	\$40.05	\$8.60	\$17.32	\$0.00	\$65.97
	06/01/2021	\$41.07	\$8.60	\$17.32	\$0.00	\$66.99
	12/01/2021	\$42.08	\$8.60	\$17.32	\$0.00	\$68.00
	06/01/2022	\$43.08	\$8.60	\$17.32	\$0.00	\$69.00
	12/01/2022	\$44.08	\$8.60	\$17.32	\$0.00	\$70.00
	06/01/2023	\$45.08	\$8.60	\$17.32	\$0.00	\$71.00
	12/01/2023	\$46.33	\$8.60	\$17.32	\$0.00	\$72.25
For apprentice rates see "Apprentice- LABORER"						
LABORER: MASON TENDER <i>LABORERS - ZONE 1</i>	12/01/2020	\$40.15	\$8.60	\$17.32	\$0.00	\$66.07
	06/01/2021	\$41.17	\$8.60	\$17.32	\$0.00	\$67.09
	12/01/2021	\$42.18	\$8.60	\$17.32	\$0.00	\$68.10
	06/01/2022	\$43.18	\$8.60	\$17.32	\$0.00	\$69.10
	12/01/2022	\$44.18	\$8.60	\$17.32	\$0.00	\$70.10
	06/01/2023	\$45.18	\$8.60	\$17.32	\$0.00	\$71.10
	06/01/2024	\$46.43	\$8.60	\$17.32	\$0.00	\$72.35
For apprentice rates see "Apprentice- LABORER"						
LABORER: MASON TENDER (HEAVY & HIGHWAY) <i>LABORERS - ZONE 1 (HEAVY & HIGHWAY)</i>	12/01/2020	\$40.15	\$8.60	\$17.32	\$0.00	\$66.07
	06/01/2021	\$41.17	\$8.60	\$17.32	\$0.00	\$67.09
	12/01/2021	\$42.18	\$8.60	\$17.32	\$0.00	\$68.10
For apprentice rates see "Apprentice- LABORER (Heavy and Highway)"						
LABORER: MULTI-TRADE TENDER <i>LABORERS - ZONE 1</i>	12/01/2020	\$39.90	\$8.60	\$17.32	\$0.00	\$65.82
	06/01/2021	\$40.92	\$8.60	\$17.32	\$0.00	\$66.84
	12/01/2021	\$41.93	\$8.60	\$17.32	\$0.00	\$67.85
	06/01/2022	\$42.93	\$8.60	\$17.32	\$0.00	\$68.85
	12/01/2022	\$43.93	\$8.60	\$17.32	\$0.00	\$69.85
	06/01/2023	\$44.93	\$8.60	\$17.32	\$0.00	\$70.85
	12/01/2023	\$46.18	\$8.60	\$17.32	\$0.00	\$72.10
For apprentice rates see "Apprentice- LABORER"						

Classification	Effective Date	Base Wage	Health	Pension	Supplemental Unemployment	Total Rate
LABORER: TREE REMOVER <i>LABORERS - ZONE 1</i>	12/01/2020	\$39.90	\$8.60	\$17.32	\$0.00	\$65.82
	06/01/2021	\$40.92	\$8.60	\$17.32	\$0.00	\$66.84
	12/01/2021	\$41.93	\$8.60	\$17.32	\$0.00	\$67.85
	06/01/2022	\$42.93	\$8.60	\$17.32	\$0.00	\$68.85
	12/01/2022	\$43.93	\$8.60	\$17.32	\$0.00	\$69.85
	06/01/2023	\$44.93	\$8.60	\$17.32	\$0.00	\$70.85
	12/01/2023	\$46.18	\$8.60	\$17.32	\$0.00	\$72.10
This classification applies to the removal of standing trees, and the trimming and removal of branches and limbs when related to public works construction or site clearance incidental to construction . For apprentice rates see "Apprentice- LABORER"						
LASER BEAM OPERATOR <i>LABORERS - ZONE 1</i>	12/01/2020	\$40.15	\$8.60	\$17.32	\$0.00	\$66.07
	06/01/2021	\$41.17	\$8.60	\$17.32	\$0.00	\$67.09
	12/01/2021	\$42.18	\$8.60	\$17.32	\$0.00	\$68.10
	06/01/2022	\$43.18	\$8.60	\$17.32	\$0.00	\$69.10
	12/01/2022	\$44.18	\$8.60	\$17.32	\$0.00	\$70.10
	06/01/2023	\$45.18	\$8.60	\$17.32	\$0.00	\$71.10
	12/01/2023	\$46.43	\$8.60	\$17.32	\$0.00	\$72.35
For apprentice rates see "Apprentice- LABORER"						
LASER BEAM OPERATOR (HEAVY & HIGHWAY) <i>LABORERS - ZONE 1 (HEAVY & HIGHWAY)</i>	12/01/2020	\$40.15	\$8.60	\$17.32	\$0.00	\$66.07
	06/01/2021	\$41.17	\$8.60	\$17.32	\$0.00	\$67.09
	12/01/2021	\$42.18	\$8.60	\$17.32	\$0.00	\$68.10
For apprentice rates see "Apprentice- LABORER (Heavy and Highway)"						
MARBLE & TILE FINISHERS <i>BRICKLAYERS LOCAL 3 - MARBLE & TILE</i>	08/01/2020	\$42.57	\$10.75	\$20.27	\$0.00	\$73.59
	02/01/2021	\$43.08	\$10.75	\$20.27	\$0.00	\$74.10
	08/01/2021	\$44.20	\$10.75	\$20.43	\$0.00	\$75.38
	02/01/2022	\$44.67	\$10.75	\$20.43	\$0.00	\$75.85

Apprentice - MARBLE & TILE FINISHER - Local 3 Marble & Tile

Effective Date - 08/01/2020

Step	percent	Apprentice Base Wage	Health	Pension	Supplemental Unemployment	Total Rate
1	50	\$21.29	\$10.75	\$20.27	\$0.00	\$52.31
2	60	\$25.54	\$10.75	\$20.27	\$0.00	\$56.56
3	70	\$29.80	\$10.75	\$20.27	\$0.00	\$60.82
4	80	\$34.06	\$10.75	\$20.27	\$0.00	\$65.08
5	90	\$38.31	\$10.75	\$20.27	\$0.00	\$69.33

Effective Date - 02/01/2021

Step	percent	Apprentice Base Wage	Health	Pension	Supplemental Unemployment	Total Rate
1	50	\$21.54	\$10.75	\$20.27	\$0.00	\$52.56
2	60	\$25.85	\$10.75	\$20.27	\$0.00	\$56.87
3	70	\$30.16	\$10.75	\$20.27	\$0.00	\$61.18
4	80	\$34.46	\$10.75	\$20.27	\$0.00	\$65.48
5	90	\$38.77	\$10.75	\$20.27	\$0.00	\$69.79

Notes:

Apprentice to Journeyworker Ratio:1:3

Classification	Effective Date	Base Wage	Health	Pension	Supplemental Unemployment	Total Rate
MARBLE MASONS, TILELAYERS & TERRAZZO MECH <i>BRICKLAYERS LOCAL 3 - MARBLE & TILE</i>	08/01/2020	\$55.77	\$10.75	\$22.08	\$0.00	\$88.60
	02/01/2021	\$56.41	\$10.75	\$22.08	\$0.00	\$89.24
	08/01/2021	\$57.81	\$10.75	\$22.24	\$0.00	\$90.80
	02/01/2022	\$58.38	\$10.75	\$22.24	\$0.00	\$91.37

Apprentice - MARBLE-TILE-TERRAZZO MECHANIC - Local 3 Marble & Tile

Effective Date - 08/01/2020

Step	percent	Apprentice Base Wage	Health	Pension	Supplemental Unemployment	Total Rate
1	50	\$27.89	\$10.75	\$22.08	\$0.00	\$60.72
2	60	\$33.46	\$10.75	\$22.08	\$0.00	\$66.29
3	70	\$39.04	\$10.75	\$22.08	\$0.00	\$71.87
4	80	\$44.62	\$10.75	\$22.08	\$0.00	\$77.45
5	90	\$50.19	\$10.75	\$22.08	\$0.00	\$83.02

Effective Date - 02/01/2021

Step	percent	Apprentice Base Wage	Health	Pension	Supplemental Unemployment	Total Rate
1	50	\$28.21	\$10.75	\$22.08	\$0.00	\$61.04
2	60	\$33.85	\$10.75	\$22.08	\$0.00	\$66.68
3	70	\$39.49	\$10.75	\$22.08	\$0.00	\$72.32
4	80	\$45.13	\$10.75	\$22.08	\$0.00	\$77.96
5	90	\$50.77	\$10.75	\$22.08	\$0.00	\$83.60

Notes:

Apprentice to Journeyworker Ratio:1:5

MECH. SWEEPER OPERATOR (ON CONST. SITES) <i>OPERATING ENGINEERS LOCAL 4</i>	12/01/2020	\$49.45	\$13.50	\$15.70	\$0.00	\$78.65
	06/01/2021	\$50.54	\$13.50	\$15.70	\$0.00	\$79.74
	12/01/2021	\$51.68	\$13.50	\$15.70	\$0.00	\$80.88

For apprentice rates see "Apprentice- OPERATING ENGINEERS"

MECHANICS MAINTENANCE <i>OPERATING ENGINEERS LOCAL 4</i>	12/01/2020	\$49.45	\$13.50	\$15.70	\$0.00	\$78.65
	06/01/2021	\$50.54	\$13.50	\$15.70	\$0.00	\$79.74
	12/01/2021	\$51.68	\$13.50	\$15.70	\$0.00	\$80.88

For apprentice rates see "Apprentice- OPERATING ENGINEERS"

MILLWRIGHT (Zone 1) <i>MILLWRIGHTS LOCAL 1121 - Zone 1</i>	01/04/2021	\$44.07	\$9.40	\$20.45	\$0.00	\$73.92
	01/03/2022	\$45.82	\$9.40	\$20.45	\$0.00	\$75.67
	01/02/2023	\$47.57	\$9.40	\$20.45	\$0.00	\$77.42

Apprentice - MILLWRIGHT - Local 1121 Zone 1

Effective Date - 01/04/2021

Step	percent	Apprentice Base Wage	Health	Pension	Supplemental Unemployment	Total Rate
1	55	\$24.24	\$9.40	\$5.58	\$0.00	\$39.22
2	65	\$28.65	\$9.40	\$16.90	\$0.00	\$54.95
3	75	\$33.05	\$9.40	\$17.92	\$0.00	\$60.37
4	85	\$37.46	\$9.40	\$18.93	\$0.00	\$65.79

Notes: Step 1&2 Appr. indentured after 1/1/2020 receive no pension, but do receive annuity. (Step 1 \$5.58, Step 2 \$6.50)
Steps are 2,000 hours

Apprentice to Journeyworker Ratio:1:5

MORTAR MIXER LABORERS - ZONE 1	12/01/2020	\$40.15	\$8.60	\$17.32	\$0.00	\$66.07
	06/01/2021	\$41.17	\$8.60	\$17.32	\$0.00	\$67.09
	12/01/2021	\$42.18	\$8.60	\$17.32	\$0.00	\$68.10
	06/01/2022	\$43.18	\$8.60	\$17.32	\$0.00	\$69.10
	12/01/2022	\$44.18	\$8.60	\$17.32	\$0.00	\$70.10
	06/01/2023	\$45.18	\$8.60	\$17.32	\$0.00	\$71.10
	12/01/2023	\$46.43	\$8.60	\$17.32	\$0.00	\$72.35

For apprentice rates see "Apprentice- LABORER"

OILER (OTHER THAN TRUCK CRANES,GRADALLS) OPERATING ENGINEERS LOCAL 4	12/01/2020	\$23.20	\$13.50	\$15.70	\$0.00	\$52.40
	06/01/2021	\$23.75	\$13.50	\$15.70	\$0.00	\$52.95
	12/01/2021	\$24.33	\$13.50	\$15.70	\$0.00	\$53.53

For apprentice rates see "Apprentice- OPERATING ENGINEERS"

OILER (TRUCK CRANES, GRADALLS) OPERATING ENGINEERS LOCAL 4	12/01/2020	\$27.97	\$13.50	\$15.70	\$0.00	\$57.17
	06/01/2021	\$28.61	\$13.50	\$15.70	\$0.00	\$57.81
	12/01/2021	\$29.29	\$13.50	\$15.70	\$0.00	\$58.49

For apprentice rates see "Apprentice- OPERATING ENGINEERS"

OTHER POWER DRIVEN EQUIPMENT - CLASS II OPERATING ENGINEERS LOCAL 4	12/01/2020	\$49.45	\$13.50	\$15.70	\$0.00	\$78.65
	06/01/2021	\$50.54	\$13.50	\$15.70	\$0.00	\$79.74
	12/01/2021	\$51.68	\$13.50	\$15.70	\$0.00	\$80.88

For apprentice rates see "Apprentice- OPERATING ENGINEERS"

PAINTER (BRIDGES/TANKS) PAINTERS LOCAL 35 - ZONE 1	01/01/2021	\$52.06	\$8.25	\$22.75	\$0.00	\$83.06
---	------------	---------	--------	---------	--------	---------

Classification

Effective Date Base Wage Health Pension Supplemental Unemployment Total Rate

Apprentice - PAINTER Local 35 - BRIDGES/TANKS

Effective Date - 01/01/2021

Step	percent	Apprentice Base Wage	Health	Pension	Supplemental Unemployment	Total Rate
1	50	\$26.03	\$8.25	\$0.00	\$0.00	\$34.28
2	55	\$28.63	\$8.25	\$6.16	\$0.00	\$43.04
3	60	\$31.24	\$8.25	\$6.72	\$0.00	\$46.21
4	65	\$33.84	\$8.25	\$7.28	\$0.00	\$49.37
5	70	\$36.44	\$8.25	\$19.39	\$0.00	\$64.08
6	75	\$39.05	\$8.25	\$19.95	\$0.00	\$67.25
7	80	\$41.65	\$8.25	\$20.51	\$0.00	\$70.41
8	90	\$46.85	\$8.25	\$21.63	\$0.00	\$76.73

Notes:
Steps are 750 hrs.

Apprentice to Journeyworker Ratio:1:1

PAINTER (SPRAY OR SANDBLAST, NEW) *	01/01/2021	\$49.75	\$8.25	\$22.75	\$0.00	\$80.75
-------------------------------------	------------	---------	--------	---------	--------	---------

* If 30% or more of surfaces to be painted are new construction, NEW paint rate shall be used. PAINTERS LOCAL 35 - ZONE 1

Apprentice - PAINTER Local 35 Zone 1 - Spray/Sandblast - New

Effective Date - 01/01/2021

Step	percent	Apprentice Base Wage	Health	Pension	Supplemental Unemployment	Total Rate
1	50	\$24.88	\$8.25	\$0.00	\$0.00	\$33.13
2	55	\$27.36	\$8.25	\$6.16	\$0.00	\$41.77
3	60	\$29.85	\$8.25	\$6.72	\$0.00	\$44.82
4	65	\$32.34	\$8.25	\$7.28	\$0.00	\$47.87
5	70	\$34.83	\$8.25	\$19.39	\$0.00	\$62.47
6	75	\$37.31	\$8.25	\$19.95	\$0.00	\$65.51
7	80	\$39.80	\$8.25	\$20.51	\$0.00	\$68.56
8	90	\$44.78	\$8.25	\$21.63	\$0.00	\$74.66

Notes:
Steps are 750 hrs.

Apprentice to Journeyworker Ratio:1:1

PAINTER (SPRAY OR SANDBLAST, REPAINT)	01/01/2021	\$46.81	\$8.25	\$22.75	\$0.00	\$77.81
---------------------------------------	------------	---------	--------	---------	--------	---------

PAINTERS LOCAL 35 - ZONE 1

Classification

Effective Date Base Wage Health Pension Supplemental Unemployment Total Rate

Apprentice - PAINTER Local 35 Zone 1 - BRUSH REPAINT

Effective Date - 01/01/2021

Step	percent	Apprentice Base Wage	Health	Pension	Supplemental Unemployment	Total Rate
1	50	\$22.71	\$8.25	\$0.00	\$0.00	\$30.96
2	55	\$24.98	\$8.25	\$6.16	\$0.00	\$39.39
3	60	\$27.25	\$8.25	\$6.72	\$0.00	\$42.22
4	65	\$29.52	\$8.25	\$7.28	\$0.00	\$45.05
5	70	\$31.79	\$8.25	\$19.39	\$0.00	\$59.43
6	75	\$34.06	\$8.25	\$19.95	\$0.00	\$62.26
7	80	\$36.33	\$8.25	\$20.51	\$0.00	\$65.09
8	90	\$40.87	\$8.25	\$21.63	\$0.00	\$70.75

Notes:
Steps are 750 hrs.

Apprentice to Journeyworker Ratio:1:1

PAINTER TRAFFIC MARKINGS (HEAVY/HIGHWAY) LABORERS - ZONE 1 (HEAVY & HIGHWAY)	12/01/2020	\$39.90	\$8.60	\$17.32	\$0.00	\$65.82
	06/01/2021	\$40.92	\$8.60	\$17.32	\$0.00	\$66.84
	12/01/2021	\$41.93	\$8.60	\$17.32	\$0.00	\$67.85
For apprentice rates see "Apprentice- LABORER (Heavy and Highway)						
PANEL & PICKUP TRUCKS DRIVER TEAMSTERS JOINT COUNCIL NO. 10 ZONE A	12/01/2020	\$36.08	\$12.91	\$14.82	\$0.00	\$63.81
	06/01/2021	\$36.88	\$12.91	\$14.82	\$0.00	\$64.61
	08/01/2021	\$36.88	\$13.41	\$14.82	\$0.00	\$65.11
	12/01/2021	\$36.88	\$13.41	\$16.01	\$0.00	\$66.30
PIER AND DOCK CONSTRUCTOR (UNDERPINNING AND DECK) PILE DRIVER LOCAL 56 (ZONE 1)	08/01/2020	\$49.07	\$9.40	\$23.12	\$0.00	\$81.59
For apprentice rates see "Apprentice- PILE DRIVER"						
PILE DRIVER PILE DRIVER LOCAL 56 (ZONE 1)	08/01/2020	\$49.07	\$9.40	\$23.12	\$0.00	\$81.59

Apprentice - PILE DRIVER - Local 56 Zone 1

Effective Date - 08/01/2020

Step	percent	Apprentice Base Wage	Health	Pension	Supplemental Unemployment	Total Rate
1	50	\$24.54	\$9.40	\$23.12	\$0.00	\$57.06
2	60	\$29.44	\$9.40	\$23.12	\$0.00	\$61.96
3	70	\$34.35	\$9.40	\$23.12	\$0.00	\$66.87
4	75	\$36.80	\$9.40	\$23.12	\$0.00	\$69.32
5	80	\$39.26	\$9.40	\$23.12	\$0.00	\$71.78
6	80	\$39.26	\$9.40	\$23.12	\$0.00	\$71.78
7	90	\$44.16	\$9.40	\$23.12	\$0.00	\$76.68
8	90	\$44.16	\$9.40	\$23.12	\$0.00	\$76.68

Notes:

% Indentured After 10/1/17; 45/45/55/55/70/70/80/80
 Step 1&2 \$34.01/ 3&4 \$41.46/ 5&6 \$62.80/ 7&8 \$69.25

Apprentice to Journeyworker Ratio:1:5

PIPEFITTER & STEAMFITTER	09/01/2020	\$56.44	\$11.70	\$20.24	\$0.00	\$88.38
PIPEFITTERS LOCAL 537	03/01/2021	\$57.94	\$11.70	\$20.24	\$0.00	\$89.88

Apprentice - PIPEFITTER - Local 537

Effective Date - 09/01/2020

Step	percent	Apprentice Base Wage	Health	Pension	Supplemental Unemployment	Total Rate
1	40	\$22.58	\$11.70	\$8.25	\$0.00	\$42.53
2	45	\$25.40	\$11.70	\$20.24	\$0.00	\$57.34
3	60	\$33.86	\$11.70	\$20.24	\$0.00	\$65.80
4	70	\$39.51	\$11.70	\$20.24	\$0.00	\$71.45
5	80	\$45.15	\$11.70	\$20.24	\$0.00	\$77.09

Effective Date - 03/01/2021

Step	percent	Apprentice Base Wage	Health	Pension	Supplemental Unemployment	Total Rate
1	40	\$23.18	\$11.70	\$8.25	\$0.00	\$43.13
2	45	\$26.07	\$11.70	\$20.24	\$0.00	\$58.01
3	60	\$34.76	\$11.70	\$20.24	\$0.00	\$66.70
4	70	\$40.56	\$11.70	\$20.24	\$0.00	\$72.50
5	80	\$46.35	\$11.70	\$20.24	\$0.00	\$78.29

Notes:

** 1:3; 3:15; 1:10 thereafter / Steps are 1 yr.
 Refrig/AC Mechanic **1:1;1:2;2:4;3:6;4:8;5:10;6:12;7:14;8:17;9:20;10:23(Max)

Apprentice to Journeyworker Ratio:**

Classification	Effective Date	Base Wage	Health	Pension	Supplemental Unemployment	Total Rate
PIPELAYER <i>LABORERS - ZONE 1</i>	12/01/2020	\$40.15	\$8.60	\$17.32	\$0.00	\$66.07
	06/01/2021	\$41.17	\$8.60	\$17.32	\$0.00	\$67.09
	12/01/2021	\$42.18	\$8.60	\$17.32	\$0.00	\$68.10
	06/01/2022	\$43.18	\$8.60	\$17.32	\$0.00	\$69.10
	12/01/2022	\$44.18	\$8.60	\$17.32	\$0.00	\$70.10
	06/01/2023	\$45.18	\$8.60	\$17.32	\$0.00	\$71.10
	12/01/2023	\$46.43	\$8.60	\$17.32	\$0.00	\$72.35
For apprentice rates see "Apprentice- LABORER"						
PIPELAYER (HEAVY & HIGHWAY) <i>LABORERS - ZONE 1 (HEAVY & HIGHWAY)</i>	12/01/2020	\$40.15	\$8.60	\$17.32	\$0.00	\$66.07
	06/01/2021	\$41.17	\$8.60	\$17.32	\$0.00	\$67.09
	12/01/2021	\$42.18	\$8.60	\$17.32	\$0.00	\$68.10
For apprentice rates see "Apprentice- LABORER (Heavy and Highway)"						
PLUMBERS & GASFITTERS <i>PLUMBERS & GASFITTERS LOCAL 12</i>	09/01/2020	\$58.69	\$13.57	\$17.26	\$0.00	\$89.52
	03/01/2021	\$60.19	\$13.57	\$17.26	\$0.00	\$91.02

Apprentice - PLUMBER/GASFITTER - Local 12

Effective Date - 09/01/2020

Step	percent	Apprentice Base Wage	Health	Pension	Supplemental Unemployment	Total Rate
1	35	\$20.54	\$13.57	\$6.24	\$0.00	\$40.35
2	40	\$23.48	\$13.57	\$7.08	\$0.00	\$44.13
3	55	\$32.28	\$13.57	\$9.63	\$0.00	\$55.48
4	65	\$38.15	\$13.57	\$11.33	\$0.00	\$63.05
5	75	\$44.02	\$13.57	\$13.03	\$0.00	\$70.62

Effective Date - 03/01/2021

Step	percent	Apprentice Base Wage	Health	Pension	Supplemental Unemployment	Total Rate
1	35	\$21.07	\$13.57	\$6.24	\$0.00	\$40.88
2	40	\$24.08	\$13.57	\$7.08	\$0.00	\$44.73
3	55	\$33.10	\$13.57	\$9.63	\$0.00	\$56.30
4	65	\$39.12	\$13.57	\$11.33	\$0.00	\$64.02
5	75	\$45.14	\$13.57	\$13.03	\$0.00	\$71.74

Notes:

** 1:2; 2:6; 3:10; 4:14; 5:19/Steps are 1 yr
Step4 with lic\$66.82, Step5 with lic\$74.39

Apprentice to Journeyworker Ratio:**

PNEUMATIC CONTROLS (TEMP.) <i>PIPEFITTERS LOCAL 537</i>	09/01/2020	\$56.44	\$11.70	\$20.24	\$0.00	\$88.38
	03/01/2021	\$57.94	\$11.70	\$20.24	\$0.00	\$89.88
For apprentice rates see "Apprentice- PIPEFITTER" or "PLUMBER/PIPEFITTER"						
PNEUMATIC DRILL/TOOL OPERATOR <i>LABORERS - ZONE 1</i>	12/01/2020	\$40.15	\$8.60	\$17.32	\$0.00	\$66.07
	06/01/2021	\$41.17	\$8.60	\$17.32	\$0.00	\$67.09
	12/01/2021	\$42.18	\$8.60	\$17.32	\$0.00	\$68.10
	06/01/2022	\$43.18	\$8.60	\$17.32	\$0.00	\$69.10
	12/01/2022	\$44.18	\$8.60	\$17.32	\$0.00	\$70.10
	06/01/2023	\$45.18	\$8.60	\$17.32	\$0.00	\$71.10
	12/01/2023	\$46.43	\$8.60	\$17.32	\$0.00	\$72.35

Classification	Effective Date	Base Wage	Health	Pension	Supplemental Unemployment	Total Rate
For apprentice rates see "Apprentice- LABORER"						
PNEUMATIC DRILL/TOOL OPERATOR (HEAVY & HIGHWAY)	12/01/2020	\$40.15	\$8.60	\$17.32	\$0.00	\$66.07
<i>LABORERS - ZONE 1 (HEAVY & HIGHWAY)</i>	06/01/2021	\$41.17	\$8.60	\$17.32	\$0.00	\$67.09
	12/01/2021	\$42.18	\$8.60	\$17.32	\$0.00	\$68.10
For apprentice rates see "Apprentice- LABORER (Heavy and Highway)"						
POWDERMAN & BLASTER	12/01/2020	\$40.90	\$8.60	\$17.32	\$0.00	\$66.82
<i>LABORERS - ZONE 1</i>	06/01/2021	\$41.92	\$8.60	\$17.32	\$0.00	\$67.84
	12/01/2021	\$42.93	\$8.60	\$17.32	\$0.00	\$68.85
	06/01/2022	\$43.93	\$8.60	\$17.32	\$0.00	\$69.85
	12/01/2022	\$44.93	\$8.60	\$17.32	\$0.00	\$70.85
	06/01/2023	\$45.93	\$8.60	\$17.32	\$0.00	\$71.85
	12/01/2023	\$47.18	\$8.60	\$17.32	\$0.00	\$73.10
For apprentice rates see "Apprentice- LABORER"						
POWDERMAN & BLASTER (HEAVY & HIGHWAY)	12/01/2020	\$40.90	\$8.60	\$17.32	\$0.00	\$66.82
<i>LABORERS - ZONE 1 (HEAVY & HIGHWAY)</i>	06/01/2021	\$41.92	\$8.60	\$17.32	\$0.00	\$67.84
	12/01/2021	\$42.93	\$8.60	\$17.32	\$0.00	\$68.85
For apprentice rates see "Apprentice- LABORER (Heavy and Highway)"						
POWER SHOVEL/DERRICK/TRENCHING MACHINE	12/01/2020	\$49.98	\$13.50	\$15.70	\$0.00	\$79.18
<i>OPERATING ENGINEERS LOCAL 4</i>	06/01/2021	\$51.08	\$13.50	\$15.70	\$0.00	\$80.28
	12/01/2021	\$52.23	\$13.50	\$15.70	\$0.00	\$81.43
For apprentice rates see "Apprentice- OPERATING ENGINEERS"						
PUMP OPERATOR (CONCRETE)	12/01/2020	\$49.98	\$13.50	\$15.70	\$0.00	\$79.18
<i>OPERATING ENGINEERS LOCAL 4</i>	06/01/2021	\$51.08	\$13.50	\$15.70	\$0.00	\$80.28
	12/01/2021	\$52.23	\$13.50	\$15.70	\$0.00	\$81.43
For apprentice rates see "Apprentice- OPERATING ENGINEERS"						
PUMP OPERATOR (DEWATERING, OTHER)	12/01/2020	\$33.00	\$13.50	\$15.70	\$0.00	\$62.20
<i>OPERATING ENGINEERS LOCAL 4</i>	06/01/2021	\$33.75	\$13.50	\$15.70	\$0.00	\$62.95
	12/01/2021	\$34.54	\$13.50	\$15.70	\$0.00	\$63.74
For apprentice rates see "Apprentice- OPERATING ENGINEERS"						
READY-MIX CONCRETE DRIVER	01/01/2021	\$23.50	\$11.51	\$8.00	\$0.00	\$43.01
<i>TEAMSTERS 170 - Rosenfeld (Walpole)</i>						
RECLAIMERS	12/01/2020	\$49.45	\$13.50	\$15.70	\$0.00	\$78.65
<i>OPERATING ENGINEERS LOCAL 4</i>	06/01/2021	\$50.54	\$13.50	\$15.70	\$0.00	\$79.74
	12/01/2021	\$51.68	\$13.50	\$15.70	\$0.00	\$80.88
For apprentice rates see "Apprentice- OPERATING ENGINEERS"						
RIDE-ON MOTORIZED BUGGY OPERATOR	12/01/2020	\$40.15	\$8.60	\$17.32	\$0.00	\$66.07
<i>LABORERS - ZONE 1</i>	06/01/2021	\$41.17	\$8.60	\$17.32	\$0.00	\$67.09
	12/01/2021	\$42.18	\$8.60	\$17.32	\$0.00	\$68.10
	06/01/2022	\$43.18	\$8.60	\$17.32	\$0.00	\$69.10
	12/01/2022	\$44.18	\$8.60	\$17.32	\$0.00	\$70.10
	06/01/2023	\$45.18	\$8.60	\$17.32	\$0.00	\$71.10
	12/01/2023	\$46.43	\$8.60	\$17.32	\$0.00	\$72.35
For apprentice rates see "Apprentice- LABORER"						
ROLLER/SPREADER/MULCHING MACHINE	12/01/2020	\$49.45	\$13.50	\$15.70	\$0.00	\$78.65
<i>OPERATING ENGINEERS LOCAL 4</i>	06/01/2021	\$50.54	\$13.50	\$15.70	\$0.00	\$79.74
	12/01/2021	\$51.68	\$13.50	\$15.70	\$0.00	\$80.88
For apprentice rates see "Apprentice- OPERATING ENGINEERS"						

Classification	Effective Date	Base Wage	Health	Pension	Supplemental Unemployment	Total Rate
ROOFER (Inc.Roofing Waterproofing &Roofing Damproofg) ROOFERS LOCAL 33	08/01/2020	\$46.60	\$11.75	\$16.15	\$0.00	\$74.50
	02/01/2021	\$48.03	\$11.75	\$16.15	\$0.00	\$75.93
	08/01/2021	\$49.46	\$11.75	\$16.15	\$0.00	\$77.36
	02/01/2022	\$50.89	\$11.75	\$16.15	\$0.00	\$78.79

Apprentice - ROOFER - Local 33

Effective Date - 08/01/2020

Step	percent	Apprentice Base Wage	Health	Pension	Supplemental Unemployment	Total Rate
1	50	\$23.30	\$11.75	\$3.81	\$0.00	\$38.86
2	60	\$27.96	\$11.75	\$16.15	\$0.00	\$55.86
3	65	\$30.29	\$11.75	\$16.15	\$0.00	\$58.19
4	75	\$34.95	\$11.75	\$16.15	\$0.00	\$62.85
5	85	\$39.61	\$11.75	\$16.15	\$0.00	\$67.51

Effective Date - 02/01/2021

Step	percent	Apprentice Base Wage	Health	Pension	Supplemental Unemployment	Total Rate
1	50	\$24.02	\$11.75	\$3.81	\$0.00	\$39.58
2	60	\$28.82	\$11.75	\$16.15	\$0.00	\$56.72
3	65	\$31.22	\$11.75	\$16.15	\$0.00	\$59.12
4	75	\$36.02	\$11.75	\$16.15	\$0.00	\$63.92
5	85	\$40.83	\$11.75	\$16.15	\$0.00	\$68.73

Notes: ** 1:5, 2:6-10, the 1:10; Reroofing: 1:4, then 1:1
 Step 1 is 2000 hrs.; Steps 2-5 are 1000 hrs.
 (Hot Pitch Mechanics' receive \$1.00 hr. above ROOFER)

Apprentice to Journeyworker Ratio:**

ROOFER SLATE / TILE / PRECAST CONCRETE ROOFERS LOCAL 33	08/01/2020	\$46.85	\$11.75	\$16.15	\$0.00	\$74.75
	02/01/2021	\$48.28	\$11.75	\$16.15	\$0.00	\$76.18
	08/01/2021	\$49.71	\$11.75	\$16.15	\$0.00	\$77.61
	02/01/2022	\$51.14	\$11.75	\$16.15	\$0.00	\$79.04

For apprentice rates see "Apprentice- ROOFER"

SHEETMETAL WORKER SHEETMETAL WORKERS LOCAL 17 - A	08/01/2020	\$50.67	\$13.50	\$24.12	\$2.65	\$90.94
	02/01/2021	\$52.32	\$13.50	\$24.12	\$2.70	\$92.64
	08/01/2021	\$54.07	\$13.50	\$24.12	\$2.75	\$94.44
	02/01/2022	\$55.82	\$13.50	\$24.12	\$2.80	\$96.24

Classification

Effective Date Base Wage Health Pension Supplemental Unemployment Total Rate

Apprentice - SHEET METAL WORKER - Local 17-A

Effective Date - 08/01/2020

Step	percent	Apprentice Base Wage	Health	Pension	Supplemental Unemployment	Total Rate
1	42	\$21.28	\$13.50	\$5.89	\$0.00	\$40.67
2	42	\$21.28	\$13.50	\$5.89	\$0.00	\$40.67
3	47	\$23.81	\$13.50	\$11.13	\$1.45	\$49.89
4	47	\$23.81	\$13.50	\$11.13	\$1.45	\$49.89
5	52	\$26.35	\$13.50	\$12.08	\$1.56	\$53.49
6	52	\$26.35	\$13.50	\$12.33	\$1.57	\$53.75
7	60	\$30.40	\$13.50	\$13.70	\$1.73	\$59.33
8	65	\$32.94	\$13.50	\$15.15	\$1.83	\$63.42
9	75	\$38.00	\$13.50	\$16.56	\$2.04	\$70.10
10	85	\$43.07	\$13.50	\$17.96	\$2.24	\$76.77

Effective Date - 02/01/2021

Step	percent	Apprentice Base Wage	Health	Pension	Supplemental Unemployment	Total Rate
1	42	\$21.97	\$13.50	\$5.89	\$0.00	\$41.36
2	42	\$21.97	\$13.50	\$5.89	\$0.00	\$41.36
3	47	\$24.59	\$13.50	\$11.13	\$1.48	\$50.70
4	47	\$24.59	\$13.50	\$11.13	\$1.48	\$50.70
5	52	\$27.21	\$13.50	\$12.08	\$1.58	\$54.37
6	52	\$27.21	\$13.50	\$12.33	\$1.59	\$54.63
7	60	\$31.39	\$13.50	\$13.70	\$1.76	\$60.35
8	65	\$34.01	\$13.50	\$15.15	\$1.88	\$64.54
9	75	\$39.24	\$13.50	\$16.56	\$2.08	\$71.38
10	85	\$44.47	\$13.50	\$17.96	\$2.28	\$78.21

Notes:

Steps are 6 mos.

Apprentice to Journeyworker Ratio:1:4

SPECIALIZED EARTH MOVING EQUIP < 35 TONS <i>TEAMSTERS JOINT COUNCIL NO. 10 ZONE A</i>	12/01/2020	\$36.54	\$12.91	\$14.82	\$0.00	\$64.27
	06/01/2021	\$37.34	\$12.91	\$14.82	\$0.00	\$65.07
	08/01/2021	\$37.34	\$13.41	\$14.82	\$0.00	\$65.57
	12/01/2021	\$37.34	\$13.41	\$16.01	\$0.00	\$66.76
SPECIALIZED EARTH MOVING EQUIP > 35 TONS <i>TEAMSTERS JOINT COUNCIL NO. 10 ZONE A</i>	12/01/2020	\$36.83	\$12.91	\$14.82	\$0.00	\$64.56
	06/01/2021	\$37.63	\$12.91	\$14.82	\$0.00	\$65.36
	08/01/2021	\$37.63	\$13.41	\$14.82	\$0.00	\$65.86
	12/01/2021	\$37.63	\$13.41	\$16.01	\$0.00	\$67.05
SPRINKLER FITTER <i>SPRINKLER FITTERS LOCAL 550 - (Section A) Zone 1</i>	01/01/2021	\$61.45	\$10.00	\$20.75	\$0.00	\$92.20
	03/01/2021	\$63.47	\$10.00	\$20.75	\$0.00	\$94.22

Classification

Effective Date Base Wage Health Pension Supplemental Unemployment Total Rate

Apprentice - SPRINKLER FITTER - Local 550 (Section A) Zone 1

Effective Date - 01/01/2021

Step	percent	Apprentice Base Wage	Health	Pension	Supplemental Unemployment	Total Rate
1	35	\$21.51	\$10.00	\$11.81	\$0.00	\$43.32
2	40	\$24.58	\$10.00	\$12.50	\$0.00	\$47.08
3	45	\$27.65	\$10.00	\$13.19	\$0.00	\$50.84
4	50	\$30.73	\$10.00	\$13.93	\$0.00	\$54.66
5	55	\$33.80	\$10.00	\$14.56	\$0.00	\$58.36
6	60	\$36.87	\$10.00	\$15.25	\$0.00	\$62.12
7	65	\$39.94	\$10.00	\$15.94	\$0.00	\$65.88
8	70	\$43.02	\$10.00	\$16.63	\$0.00	\$69.65
9	75	\$46.09	\$10.00	\$17.31	\$0.00	\$73.40
10	80	\$49.16	\$10.00	\$18.00	\$0.00	\$77.16

Effective Date - 03/01/2021

Step	percent	Apprentice Base Wage	Health	Pension	Supplemental Unemployment	Total Rate
1	35	\$22.21	\$10.00	\$11.81	\$0.00	\$44.02
2	40	\$25.39	\$10.00	\$12.50	\$0.00	\$47.89
3	45	\$28.56	\$10.00	\$13.19	\$0.00	\$51.75
4	50	\$31.74	\$10.00	\$13.93	\$0.00	\$55.67
5	55	\$34.91	\$10.00	\$14.56	\$0.00	\$59.47
6	60	\$38.08	\$10.00	\$15.25	\$0.00	\$63.33
7	65	\$41.26	\$10.00	\$15.94	\$0.00	\$67.20
8	70	\$44.43	\$10.00	\$16.63	\$0.00	\$71.06
9	75	\$47.60	\$10.00	\$17.31	\$0.00	\$74.91
10	80	\$50.78	\$10.00	\$18.00	\$0.00	\$78.78

Notes: Apprentice entered prior 9/30/10:
40/45/50/55/60/65/70/75/80/85
Steps are 850 hours

Apprentice to Journeyworker Ratio:1:3

STEAM BOILER OPERATOR <i>OPERATING ENGINEERS LOCAL 4</i>	12/01/2020	\$49.45	\$13.50	\$15.70	\$0.00	\$78.65
	06/01/2021	\$50.54	\$13.50	\$15.70	\$0.00	\$79.74
	12/01/2021	\$51.68	\$13.50	\$15.70	\$0.00	\$80.88
For apprentice rates see "Apprentice- OPERATING ENGINEERS"						
TAMPERS, SELF-PROPELLED OR TRACTOR DRAWN <i>OPERATING ENGINEERS LOCAL 4</i>	12/01/2020	\$49.45	\$13.50	\$15.70	\$0.00	\$78.65
	06/01/2021	\$50.54	\$13.50	\$15.70	\$0.00	\$79.74
	12/01/2021	\$51.68	\$13.50	\$15.70	\$0.00	\$80.88
For apprentice rates see "Apprentice- OPERATING ENGINEERS"						
TELECOMMUNICATION TECHNICIAN <i>ELECTRICIANS LOCAL 103</i>	09/01/2020	\$40.84	\$13.00	\$17.53	\$0.00	\$71.37
	03/01/2021	\$42.11	\$13.00	\$17.88	\$0.00	\$72.99
	09/01/2021	\$43.77	\$13.00	\$18.00	\$0.00	\$74.77
	03/01/2022	\$45.27	\$13.00	\$18.12	\$0.00	\$76.39
	09/01/2022	\$46.99	\$13.00	\$18.24	\$0.00	\$78.23
	03/01/2023	\$48.54	\$13.00	\$18.37	\$0.00	\$79.91

Apprentice - TELECOMMUNICATION TECHNICIAN - Local 103

Effective Date - 09/01/2020

Step	percent	Apprentice Base Wage	Health	Pension	Supplemental Unemployment	Total Rate
1	45	\$18.38	\$13.00	\$0.55	\$0.00	\$31.93
2	45	\$18.38	\$13.00	\$0.55	\$0.00	\$31.93
3	50	\$20.42	\$13.00	\$14.20	\$0.00	\$47.62
4	50	\$20.42	\$13.00	\$14.20	\$0.00	\$47.62
5	55	\$22.46	\$13.00	\$14.53	\$0.00	\$49.99
6	60	\$24.50	\$13.00	\$14.87	\$0.00	\$52.37
7	65	\$26.55	\$13.00	\$15.20	\$0.00	\$54.75
8	70	\$28.59	\$13.00	\$15.53	\$0.00	\$57.12
9	75	\$30.63	\$13.00	\$15.87	\$0.00	\$59.50
10	80	\$32.67	\$13.00	\$16.20	\$0.00	\$61.87

Effective Date - 03/01/2021

Step	percent	Apprentice Base Wage	Health	Pension	Supplemental Unemployment	Total Rate
1	45	\$18.95	\$13.00	\$0.57	\$0.00	\$32.52
2	45	\$18.95	\$13.00	\$0.57	\$0.00	\$32.52
3	50	\$21.06	\$13.00	\$14.47	\$0.00	\$48.53
4	50	\$21.06	\$13.00	\$14.47	\$0.00	\$48.53
5	55	\$23.16	\$13.00	\$14.80	\$0.00	\$50.96
6	60	\$25.27	\$13.00	\$15.14	\$0.00	\$53.41
7	65	\$27.37	\$13.00	\$15.47	\$0.00	\$55.84
8	70	\$29.48	\$13.00	\$15.80	\$0.00	\$58.28
9	75	\$31.58	\$13.00	\$16.15	\$0.00	\$60.73
10	80	\$33.69	\$13.00	\$16.48	\$0.00	\$63.17

Notes:

Apprentice to Journeyworker Ratio:1:1

TERRAZZO FINISHERS	08/01/2020	\$54.69	\$10.75	\$22.09	\$0.00	\$87.53
BRICKLAYERS LOCAL 3 - MARBLE & TILE	02/01/2021	\$55.33	\$10.75	\$22.09	\$0.00	\$88.17
	08/01/2021	\$56.73	\$10.75	\$22.25	\$0.00	\$89.73
	02/01/2022	\$57.32	\$10.75	\$22.25	\$0.00	\$90.32

Apprentice - TERRAZZO FINISHER - Local 3 Marble & Tile

Effective Date - 08/01/2020

Step	percent	Apprentice Base Wage	Health	Pension	Supplemental Unemployment	Total Rate
1	50	\$27.35	\$10.75	\$22.09	\$0.00	\$60.19
2	60	\$32.81	\$10.75	\$22.09	\$0.00	\$65.65
3	70	\$38.28	\$10.75	\$22.09	\$0.00	\$71.12
4	80	\$43.75	\$10.75	\$22.09	\$0.00	\$76.59
5	90	\$49.22	\$10.75	\$22.09	\$0.00	\$82.06

Effective Date - 02/01/2021

Step	percent	Apprentice Base Wage	Health	Pension	Supplemental Unemployment	Total Rate
1	50	\$27.67	\$10.75	\$22.09	\$0.00	\$60.51
2	60	\$33.20	\$10.75	\$22.09	\$0.00	\$66.04
3	70	\$38.73	\$10.75	\$22.09	\$0.00	\$71.57
4	80	\$44.26	\$10.75	\$22.09	\$0.00	\$77.10
5	90	\$49.80	\$10.75	\$22.09	\$0.00	\$82.64

Notes:

Apprentice to Journeyworker Ratio:1:3

TEST BORING DRILLER <i>LABORERS - FOUNDATION AND MARINE</i>	12/01/2020	\$41.30	\$8.60	\$17.47	\$0.00	\$67.37
	06/01/2021	\$42.32	\$8.60	\$17.47	\$0.00	\$68.39
	12/01/2021	\$43.33	\$8.60	\$17.47	\$0.00	\$69.40

For apprentice rates see "Apprentice- LABORER"

TEST BORING DRILLER HELPER <i>LABORERS - FOUNDATION AND MARINE</i>	12/01/2020	\$40.02	\$8.60	\$17.47	\$0.00	\$66.09
	06/01/2021	\$41.04	\$8.60	\$17.47	\$0.00	\$67.11
	12/01/2021	\$42.05	\$8.60	\$17.47	\$0.00	\$68.12

For apprentice rates see "Apprentice- LABORER"

TEST BORING LABORER <i>LABORERS - FOUNDATION AND MARINE</i>	12/01/2020	\$39.90	\$8.60	\$17.47	\$0.00	\$65.97
	06/01/2021	\$40.92	\$8.60	\$17.47	\$0.00	\$66.99
	12/01/2021	\$41.93	\$8.60	\$17.47	\$0.00	\$68.00

For apprentice rates see "Apprentice- LABORER"

TRACTORS/PORTABLE STEAM GENERATORS <i>OPERATING ENGINEERS LOCAL 4</i>	12/01/2020	\$49.45	\$13.50	\$15.70	\$0.00	\$78.65
	06/01/2021	\$50.54	\$13.50	\$15.70	\$0.00	\$79.74
	12/01/2021	\$51.68	\$13.50	\$15.70	\$0.00	\$80.88

For apprentice rates see "Apprentice- OPERATING ENGINEERS"

TRAILERS FOR EARTH MOVING EQUIPMENT <i>TEAMSTERS JOINT COUNCIL NO. 10 ZONE A</i>	12/01/2020	\$37.12	\$12.91	\$14.82	\$0.00	\$64.85
	06/01/2021	\$37.92	\$12.91	\$14.82	\$0.00	\$65.65
	08/01/2021	\$37.92	\$13.41	\$14.82	\$0.00	\$66.15
	12/01/2021	\$37.92	\$13.41	\$16.01	\$0.00	\$67.34

TUNNEL WORK - COMPRESSED AIR <i>LABORERS (COMPRESSED AIR)</i>	12/01/2020	\$52.13	\$8.60	\$17.92	\$0.00	\$78.65
	06/01/2021	\$53.15	\$8.60	\$17.92	\$0.00	\$79.67
	12/01/2021	\$54.16	\$8.60	\$17.92	\$0.00	\$80.68

For apprentice rates see "Apprentice- LABORER"

Classification	Effective Date	Base Wage	Health	Pension	Supplemental Unemployment	Total Rate
TUNNEL WORK - COMPRESSED AIR (HAZ. WASTE) <i>LABORERS (COMPRESSED AIR)</i>	12/01/2020	\$54.13	\$8.60	\$17.92	\$0.00	\$80.65
	06/01/2021	\$55.15	\$8.60	\$17.92	\$0.00	\$81.67
	12/01/2021	\$56.16	\$8.60	\$17.92	\$0.00	\$82.68
For apprentice rates see "Apprentice- LABORER"						
TUNNEL WORK - FREE AIR <i>LABORERS (FREE AIR TUNNEL)</i>	12/01/2020	\$44.20	\$8.60	\$17.92	\$0.00	\$70.72
	06/01/2021	\$45.22	\$8.60	\$17.92	\$0.00	\$71.74
	12/01/2021	\$46.23	\$8.60	\$17.92	\$0.00	\$72.75
For apprentice rates see "Apprentice- LABORER"						
TUNNEL WORK - FREE AIR (HAZ. WASTE) <i>LABORERS (FREE AIR TUNNEL)</i>	12/01/2020	\$46.20	\$8.60	\$17.92	\$0.00	\$72.72
	06/01/2021	\$47.22	\$8.60	\$17.92	\$0.00	\$73.74
	12/01/2021	\$48.23	\$8.60	\$17.92	\$0.00	\$74.75
For apprentice rates see "Apprentice- LABORER"						
VAC-HAUL <i>TEAMSTERS JOINT COUNCIL NO. 10 ZONE A</i>	12/01/2020	\$36.54	\$12.91	\$14.82	\$0.00	\$64.27
	06/01/2021	\$37.34	\$12.91	\$14.82	\$0.00	\$65.07
	08/01/2021	\$37.34	\$13.41	\$14.82	\$0.00	\$65.57
	12/01/2021	\$37.34	\$13.41	\$16.01	\$0.00	\$66.76
WAGON DRILL OPERATOR <i>LABORERS - ZONE 1</i>	12/01/2020	\$40.15	\$8.60	\$17.32	\$0.00	\$66.07
	06/01/2021	\$41.17	\$8.60	\$17.32	\$0.00	\$67.09
	12/01/2021	\$42.18	\$8.60	\$17.32	\$0.00	\$68.10
	06/01/2022	\$43.18	\$8.60	\$17.32	\$0.00	\$69.10
	12/01/2022	\$44.18	\$8.60	\$17.32	\$0.00	\$70.10
	06/01/2023	\$45.18	\$8.60	\$17.32	\$0.00	\$71.10
	12/01/2023	\$46.43	\$8.60	\$17.32	\$0.00	\$72.35
For apprentice rates see "Apprentice- LABORER"						
WAGON DRILL OPERATOR (HEAVY & HIGHWAY) <i>LABORERS - ZONE 1 (HEAVY & HIGHWAY)</i>	12/01/2020	\$40.15	\$8.60	\$17.32	\$0.00	\$66.07
	06/01/2021	\$41.17	\$8.60	\$17.32	\$0.00	\$67.09
	12/01/2021	\$42.18	\$8.60	\$17.32	\$0.00	\$68.10
For apprentice rates see "Apprentice- LABORER (Heavy and Highway)"						
WASTE WATER PUMP OPERATOR <i>OPERATING ENGINEERS LOCAL 4</i>	12/01/2020	\$49.98	\$13.50	\$15.70	\$0.00	\$79.18
	06/01/2021	\$51.08	\$13.50	\$15.70	\$0.00	\$80.28
	12/01/2021	\$52.23	\$13.50	\$15.70	\$0.00	\$81.43
For apprentice rates see "Apprentice- OPERATING ENGINEERS"						
WATER METER INSTALLER <i>PLUMBERS & GASFITTERS LOCAL 12</i>	09/01/2020	\$58.69	\$13.57	\$17.26	\$0.00	\$89.52
	03/01/2021	\$60.19	\$13.57	\$17.26	\$0.00	\$91.02
For apprentice rates see "Apprentice- PLUMBER/PIPEFITTER" or "PLUMBER/GASFITTER"						

Additional Apprentice Information:

Minimum wage rates for apprentices employed on public works projects are listed above as a percentage of the pre-determined hourly wage rate established by the Commissioner under the provisions of the M.G.L. c. 149, ss. 26-27D. Apprentice ratios are established by the Division of Apprenticeship Training pursuant to M.G.L. c. 23, ss. 11E-11L.

All apprentices must be registered with the Division of Apprenticeship Training in accordance with M.G.L. c. 23, ss. 11E-11L.

All steps are six months (1000 hours.)

Ratios are expressed in allowable number of apprentices to journeymen or fraction thereof, unless otherwise specified.

** Multiple ratios are listed in the comment field.

*** APP to JM; 1:1, 2:2, 2:3, 3:4, 4:4, 4:5, 4:6, 5:7, 6:7, 6:8, 6:9, 7:10, 8:10, 8:11, 8:12, 9:13, 10:13, 10:14, etc.

**** APP to JM; 1:1, 1:2, 2:3, 2:4, 3:5, 4:6, 4:7, 5:8, 6:9, 6:10, 7:11, 8:12, 8:13, 9:14, 10:15, 10:16, etc.

ATTACHMENT B

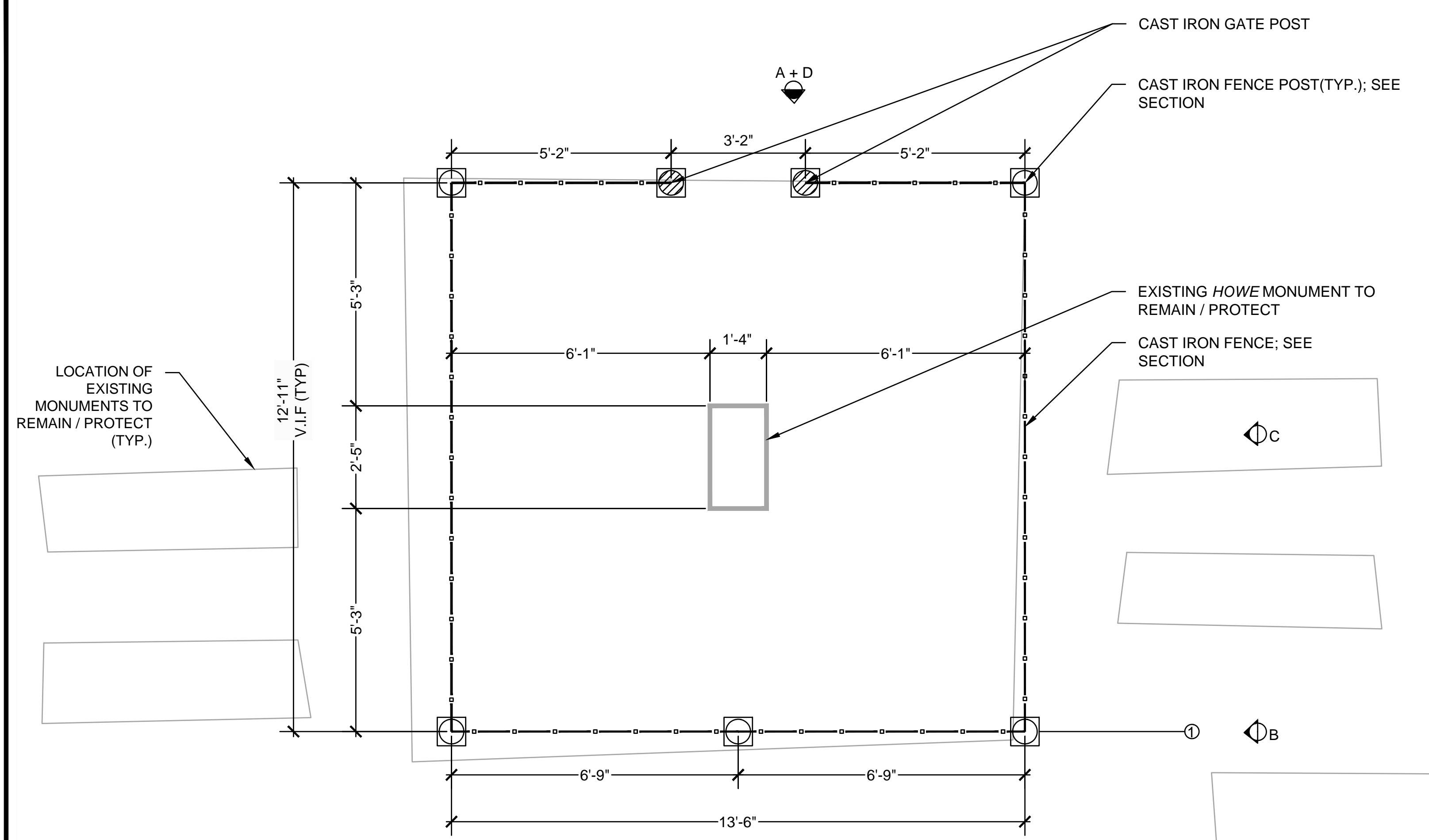

HOWE LOT (PLAN)
SCALE: 1/2" = 1'-0"

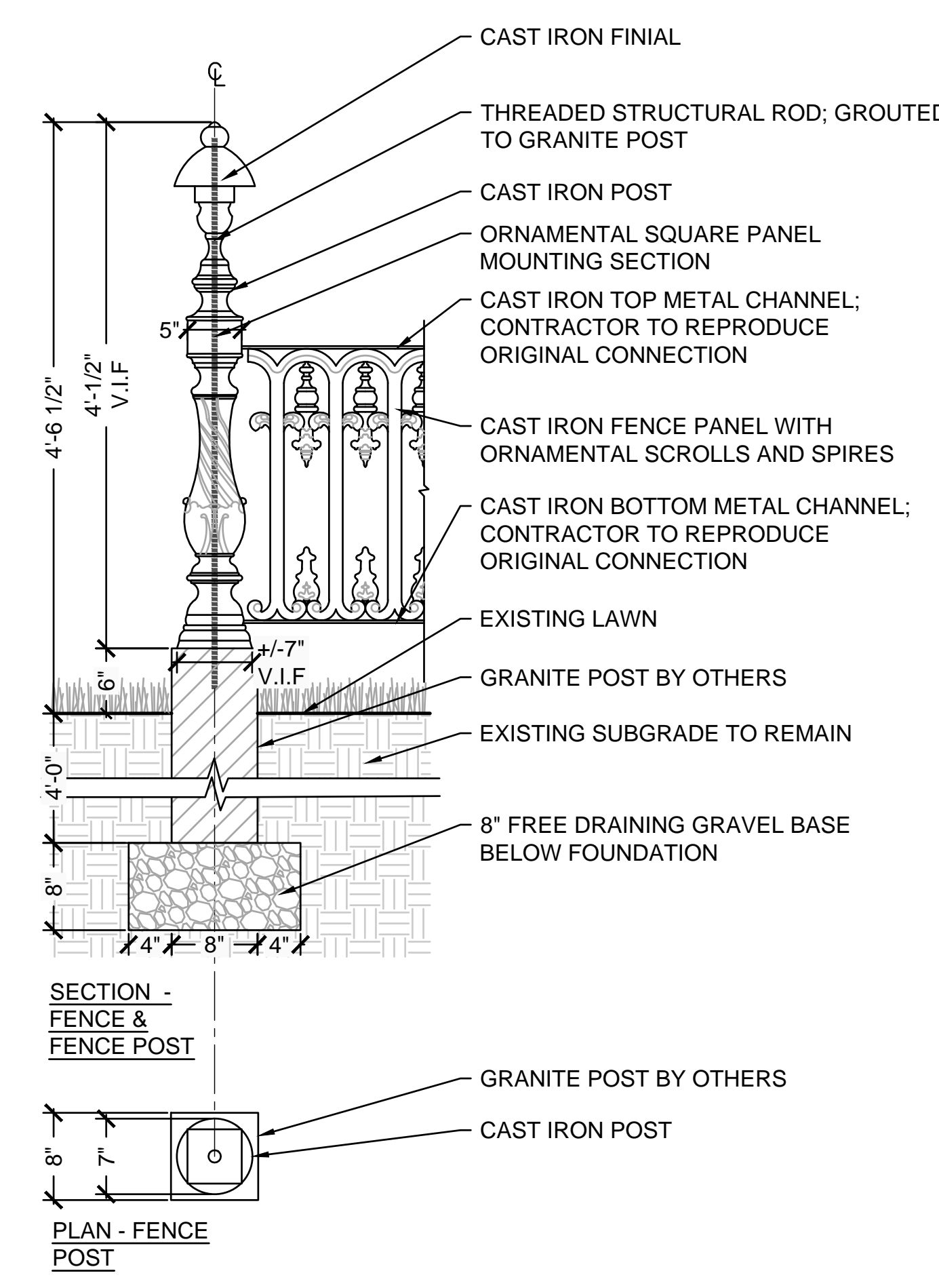

1 CAST IRON FENCE AND POST (SECTION)
SCALE: 1" = 1'-0"

NOTES:

- SUBMIT CONSTRUCTION STAGING AND WORK PLAN PER SITE PREPARATION AND DISMANTLING SPECIFICATION (02 10 00) FOR APPROVAL PRIOR TO COMMENCEMENT OF SITE WORK (INCLUDING DISMANTLING). WORK PLAN SHALL INCLUDE PROTECTION OF TREES, LANDSCAPE AND HEADSTONES WITHIN 15 FEET OF THE WORK AREA AND CONSTRUCTION ACCESS ROUTES.
- TAKE ACCURATE FIELD MEASUREMENTS BEFORE PREPARATION OF SHOP DRAWINGS AND FABRICATION.
- SUBMIT LARGE SCALE SHOP DRAWINGS FOR FABRICATION, INSTALLATION, AND ERECTION OF ALL PARTS OF THE WORK PER FENCING RESTORATION SPECIFICATION (32 31 19).
- PROVIDE INSTALLATION TEMPLATES FOR WORK INSTALLED BY OTHERS.
- PROVIDE 3-PART PAINT FINISH PER PAINTING SPECIFICATION (09 91 13). PAINT FINISH TO INCLUDE ZINC-RICH BASE COAT.
- SUBMIT MOCKUP OF 1 POST AND A (5' MINIMUM FENCE) PANEL SECTION. MOCKUP TO INCLUDE POST TO PANEL CONNECTIONS.
- APPROVED MOCKUP MAY REMAIN AS PART OF THE FINISHED WORK.



A - CAST IRON GATE POST



B - CAST IRON FENCE POST & FENCE



D - CAST IRON FENCE POST TOP



C - CAST IRON FENCE

REFERENCE IMAGES
SCALE: N.T.S.

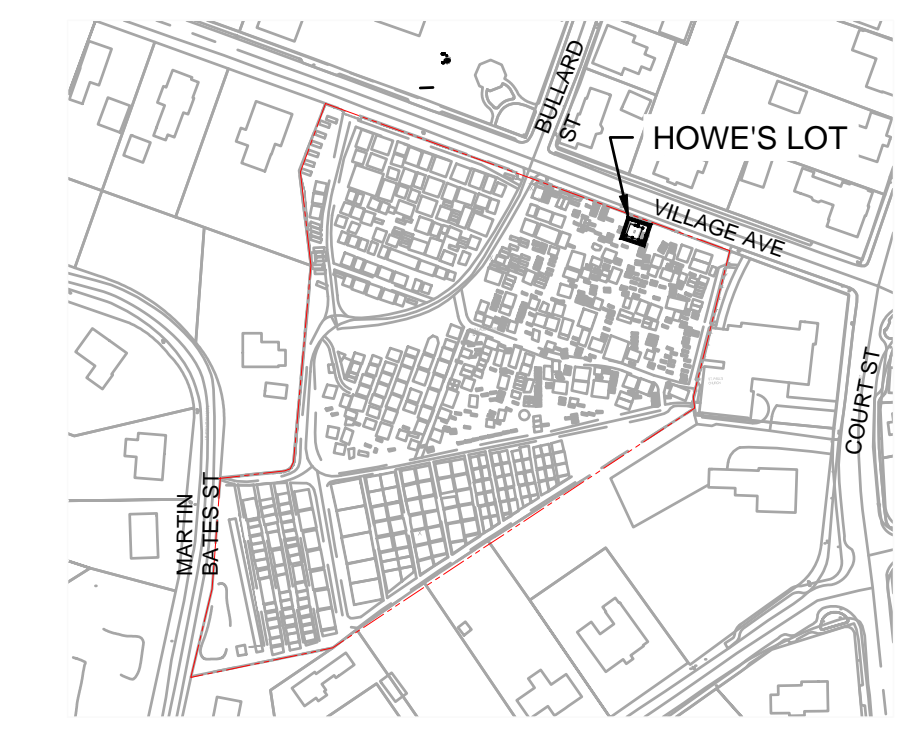

KEY PLAN

**FOR COORDINATION PURPOSES
-NOT FOR CONSTRUCTION**

LANDSCAPE ARCHITECT DATE

OLD VILLAGE CEMETERY

VILLAGE AVE
IN
DEDHAM
MASSACHUSETTS

HOWE LOT FENCE RESTORATION

JANUARY 22, 2021

REVISIONS:

NO.	DATE	DESC.

PREPARED FOR:
TOWN OF DEDHAM
DEDHAM, MA

BSC GROUP
Landscape Architecture + Planning
803 Summer Street
Boston, Massachusetts
02127
617 896 4300

© 2018 BSC Group, Inc.

SCALE AS NOTED

FILE: 2343410/LANDSCAPE/DRAWINGS
DWG. NO:
JOB. NO: 23434.10 SHEET **L-101**